

The background of the cover is a photograph of a coastal scene. On the right side, there is a large, green, spiky plant, possibly a Pandanus, growing on a rocky shore. The rocks are dark and jagged, extending into the water. The water is a vibrant blue-green color, with white foam from waves breaking against the rocks. In the distance, a low-lying coastline with some buildings is visible under a clear blue sky with a few wispy clouds. The text "KINGSFORD SMITH RESERVE" is in white, and "DRAFT MASTER PLAN" is in a light green color, all in a bold, sans-serif font.

KINGSFORD SMITH RESERVE DRAFT MASTER PLAN



CONTENTS



Executive Summary	04
Kingsford Smith Reserve: Understanding it Today	06
A.1 - Strategic Context	08
A.2 - Our Site	10
A.3 - Site Characteristics and Opportunities	12
A.4 - Community Insights	14
Kingsford Smith Reserve: Your Vision	16
B.1 - Our vision for a Community Parkland	18
B.2 - Place Pillars	20
B.3 - Key Moves	24
Kingsford Smith Reserve: Our Plan for Revitalisation	26
C.1- The Master Plan	28
C.2 - Master Plan Strategies and Outcomes	34
C.3 - Access and Connectivity	35
C.4 - Play and Leisure	36
C.5 - Safety and Security	37
C.6 - Environment and Habitat	38
Kingsford Smith Reserve: Design Intent of Parks	48
D.1 - Commemoration Park	54
D.2 - Missingham Park	58
D.3 - Kingsford Smith Park	62
Kingsford Smith Reserve: Where to From Now	68
E.1 - Future Stages	70
E.2 - Costs and Priorities	70



Executive summary

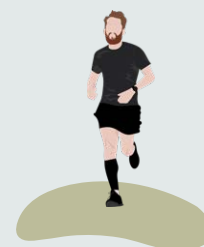

A vision for a community open space that has something for everyone.

The master plan sets out a long-term vision for revitalisation of Kingsford Smith Reserve including, Kingsford Smith, Missingham and Commemoration parks. The plan offers a strategic tool for future investment and implementation that will deliver unprecedented community benefit with new facilities, amenity and activities connected by a new network recreation loops.

Master Plan Process



Kingsford Smith Reserve will bring the community together in an integrated sports and recreation parkland that celebrates our natural waterfront setting.

Why Master Plan Kingsford Smith Reserve?

Kingsford Smith Reserve provides a unique waterfront recreation and sporting precinct for the community of Ballina to enjoy. Made up of Commemoration Park, Missingham Park and Kingsford Smith Park, the precinct offers regional significance as the home of a number of community sporting teams. With some NSW Government funding currently available, the purpose of this master plan is to outline a vision for the future and ensure that any short-term investment is in line with the intent and long-term aspirations for the parkland.

As part of the master planning process we engaged with the key users and general community and the following issues and opportunities have been identified;

- Club house improvements and new facilities
- Sports field and surrounds upgrades, including lighting, amenity, shade and carparking
- Greater connectivity around the parks with new recreation loops
- Additional playgrounds and opportunities for social gathering by the waterfront
- Retention and enhancement of natural landscape
- Skate park expansion
- Space and infrastructure for community events
- Improved safety throughout the parkland

The master plan will look at ways to outline potential revitalisation measures and create a precinct that is not only loved by the local community, and supports significant high profile sporting events and regional visitation.

It is not expected that the master plan will be implemented in one go, but will provide an overarching vision and intent, along with an implementation strategy for new and improved recreational activities that can be implemented over time. The master plan will identify areas of potential expansion and focus on providing new facilities and infrastructure that align with the broader recreational needs of Ballina and its community.

Master Principles



Community
Focused



Locally
Connected



Environmentally
Responsible



Experiential
Spaces

Master Plan





Kingsford Smith Reserve

Understanding it Today

Part A

Strategic context

An enviable waterfront setting that bookends the island of Ballina with a green peninsula

Ballina is a regionally significant growth area and 'Strategic Centre' under the North Coast 2036 Regional Plan. Its continued strategic growth as the social and commercial hub of the Northern Rivers region is defined by its people and strong community ties. Its community is warm and welcoming and the lifestyle is laid-back, active and family orientated.

Kingsford Smith Reserve is strategically positioned on the waterfront peninsula, forming a gateway for those traveling through East Ballina. Providing 20Ha of open space, the reserve is an important community asset and with revitalisation, has the ability to transform into a regionally significant parkland that supports the needs and desires of the community. Its revitalisation will support the continued implementation of our Local Strategic Planning vision (2020-2040) to deliver public spaces and built environments that celebrate local character, and provide ample opportunity for connection to culture, people, place and country.

As part of broader network of parks and sporting facilities, Kingsford Smith Reserve provides the community with access to open space and diverse recreational opportunities. Within this network, Kingsford Smith Reserve will have a specific role in the town's suite of open spaces that specifically respond to sports, recreation and leisure opportunities. In addition to the strategic location of Kingsford Smith Reserve, it is also identified within Ballina Shire Sports and Recreation Facility Plan with series of key recommendations that align to broader open space considerations within Ballina.





H BALLINA DISTRICT HOSPITAL

S BALLINA COAST HIGH SCHOOL

S ST FRANCIS XAVIER PRIMARY SCHOOL

S BALLINA PUBLIC SCHOOL

BOOMERANG PARK*

KINGSFORD SMITH PARK

MISSINGHAM PARK

COMMEMORATION PARK

GAWANDII BEACH

PACIFIC OCEAN

RICHMOND RIVER

*Note : Boomerang Park is Crown land managed by others and is not part of this study area.

Our site

In order to best understand how we can improve and enhance the function and environment of Kingsford Smith Reserve, we must first understand its key characteristics. The following pages summarise key features of the three separate parks and the potential opportunities for revitalisation in parallel with community engagement outcomes.

Master Plan Area

There are three areas of focus of the Master Plan of Kingsford Smith Reserve - Kingsford Smith Park, Missingham Park and Commemoration Park. Together the three parks form the master plan area that currently provides the community with much loved open space.

Each park provides complimentary uses that support the creation of a 'park of parks' that supports the whole community. The site also has a strong connection to water with access to North Creek, Richmond River and Kingsford Smith Lake which is a defining feature of all parks.



Sub-Area Role and Function

Each of the parks have a specific primary focus and function that is to be enhanced through the master planning process. In addition to this parks primary role and function, the parks also provide secondary uses that support park activation and utilisation.

The table opposite provides an overview of current park functions and the ancillary uses that occur.

Kingsford Smith Park	Sport
	Boat model makers
	Passive recreation
Missingham Park	Active recreation
	Leisure and Play
	Events
Commemoration Park	Passive recreation
	Events (Markets)
	Active recreation



What we see at Kingsford Smith Reserve?

The following images represent the unique character of Kingsford Smith Reserve - picturesque views, amazing native vegetation and rolling lawns and a number of opportunities for revitalisation to provide even better facilities and amenity for everyone.



Activation of and views to lake to be explored



Explore sports amenity building upgrade opportunities



Safety of carpark and general layout to increase connectivity and shade



Opportunity for shade



Wider path for multi-modal flow



Opportunity to expand skatepark



Acitvation of and views to Lake

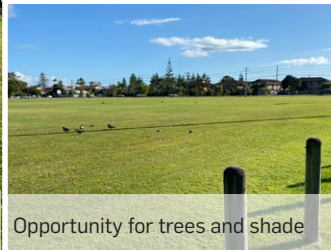

Opportunity for trees and shade



Celebrate views over water



Enhance waterfront spaces with pavilions, BBQs and seating



Vegetation screening to define sporting areas



Natural Coastal vegetation and passive spaces by the water

Site Characteristics and Opportunities

<p>Kingsford Smith Park</p>	<p>Views Kingsford Smith Reserve presents long views across the Sports Fields from most aspects of the park. There is an opportunity to frame the sporting field views with vegetation and enhance the sporting viewing experience through land form and shade. The lake is currently shielded by vegetation including long grasses that if opened will provide views and casual surveillance from the surrounding areas to the waterbody.</p>
	<p>Access and parking Vehicle access for parking is currently limited to Bentinck Street. This internal parking area serves the whole precinct and presents a number of safety issues with pedestrian crossings between the fields and the sports amenity building. Street parking is available along all surrounding streets on the verge but could be formalised to support access. Additional parking areas and re-configuration will provide a safer environment and will provide more direct access for the different sporting precincts.</p>
	<p>Pedestrian connectivity Pedestrian connectivity is restricted by the fenced areas of the hockey field and senior rugby league oval. There is an opportunity to re align the fence line of the rugby league field to open up a connection through the centre of the park to the lake and through to Kingsford Smith Drive. The formalisation of pedestrian paths will also support desired movement and provide internal and external connections for recreation and access to the network of activity nodes.</p>
	<p>Recreation and Amenity Network Kingsford Smith Park primary role as a sporting facility is well arranged and provides the community with open space to general recreation. There is an opportunity to provide an additional level of utilisation through ancillary uses such a playground and gathering spaces to activate the lake and support the sporting function.</p>
	<p>Landscape Vegetation The park has limited canopy tree vegetation with should be provided for shade and comfort around the parkland. Around the lake the existing trees should be retained, and new understorey planting will provide greater views through to the lake and assist with CPTED issues.</p>
<p>Missingham Park & Commemoration Park</p>	<p>Views Both Missingham and Commemoration parks provide amazing views across Richmond River and North Creek. These views are open to the waterfront promenade but provide opportunity for more spaces to inhabit the waters edge and appreciate the site's aspect</p>
	<p>Access and parking Parking is limited to Missingham Park and street parking. There is opportunity to reconfigure the parking within Missingham park to create landscape space along the waterfront and provide better visibility of parking from Kingsford Smith Drive.</p>
	<p>Pedestrian connectivity Formalised pedestrian connectivity is limited to the waterfront and to access Missingham Bridge. By providing a secondary network of lower order paths, it will provide more accessibility to future spaces.</p>
	<p>Recreation and Amenity Network Both Missingham and Commemoration parks provide opportunities for passive and active recreation and spaces for social gathering. The parks infrastructure including pavilions, amenities and general opportunities for utilisation can be enhanced through new inclusions that support the desires of the community.</p>
	<p>Landscape Vegetation The natural vegetation along the waterfront provide significant environmental and ecological value that is to be retained and enhanced. The retention of trees and habitat creation is high priority in order to maintain natural processes and provide shade and comfort for users.</p>



Opportunity for Revitalisation

The above plan and table opposite provides a high level assessment and outline of areas of revitalisation to be considered in parallel with the community consultation process.

SPORTS	S1	Club and change room facilities
	S2	Playing surface and infrastructure
	S3	Spectator amenity and surrounds
	S4	Security and safety
	S5	Co-location of sport amenity building and facilities
ACCESS	A1	Distributed carparking areas
	A2	Pedestrian safety (vehicle and CPTED)
	A3	Pedestrian connectivity and new networks
ENVIRONMENT	E1	Provision for more landscaped spaces
	E2	Habitat creation and natural landscape
	E3	Parkland activation and amenity
	E4	Lake surrounds and cross-connections

Community Insights and Desires

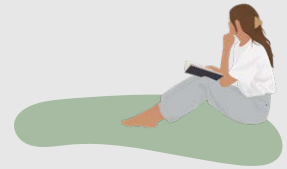

To help guide the master plan, the community and key stakeholders were asked what they would like to see improved at each park. The engagement process and information dissemination to date has included: online survey, meetings with key stakeholder user and

sporting groups, letterbox drop to adjoining residences, web site content, social media posts and links, community connect article and radio interviews and promotion. The following summarises the communities desires.

666 
Responses

1+ 
Most people use one or more of the parks weekly

Why I come to one of the parks

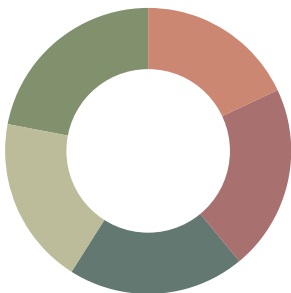





-  18% Organised sport
-  21% Informal recreation
-  20% Play
-  19% Leisure and Gatherings
-  22% Community Events



Who do you enjoy the park with?



-  16% By myself
-  22% As part of a group of adults
-  19% With children 5 years and under
-  24% With children 6-12 years
-  19% With teenagers 13-17 years



2+
Most people visit for more than 2 reasons

>60%
Enjoy the park with kids

Top 10 Values

Your shared vision for the Master plan of Kingsford Smith Reserve

The following list summarises the key values and actions to be implemented across Kingsford Smith Reserve

1. Keep it family friendly
2. Keep the role and function of each park
3. Keep a predominate natural landscape feel
4. Improve safety and lighting
5. Improve sporting facilities
6. Improve connectivity between the precincts
7. Provide inspiring play
8. Create new parkland spaces with shade
9. Expand the skate and cycle facilities
10. Make it accessible to all

Top 10 Priorities For Each Park

Your highest priorities for change at each park

The following list summarises the key areas of focus and action for each park in order of priority based on the results of the online survey and key stakeholder engagement sessions

Missingham	<ol style="list-style-type: none"> 1. Toilets and amenities 2. Picnic and BBQ facilities 3. Carparking, lighting and safety 4. Playground facilities (0-12 age) 5. Multi-use pathways 	<ol style="list-style-type: none"> 6. Water play 7. Seating along the waterfront 8. Playground facilities for teens (12-16 age) 9. Skatepark expansion 10. BMX or pump track
Commemoration	<ol style="list-style-type: none"> 1. Lighting and safety 2. Flexible space for community events 3. Picnic shelters and BBQs 4. Playground 5. Seating along waterfront 	<ol style="list-style-type: none"> 6. Open lawns and passive open space 7. Natural vegetation areas 8. Landscaping 9. Cycling support infrastructure 10. Exercise equipment
Kingsford	<ol style="list-style-type: none"> 1. Lighting and safety 2. Shaded seating and spectator areas 3. Shelter and weather protection 4. Improved sports amenity buildings 5. Improved sporting fields 	<ol style="list-style-type: none"> 6. Multi-use pathways 7. Playground facilities 8. Carparking 9. Improved accessibility 10. Access to the waterway/lake



Kingsford Smith Reserve

Your Vision



Part B

Our Vision For a Community Parkland



Kingsford Smith Reserve: The recreational heart of the Ballina region, where the community comes to meet and play by the river.

As a destination that brings the community together in an integrated sports and recreation parkland, Kingsford Smith Reserve will offer opportunities for play, leisure and social gatherings in a natural coastal environment that celebrates our enviable waterfront setting. It will be responsive to the natural environment and existing and future activity and will reflect our aspirations as a coastal community. It will acknowledge and celebrate the community's connection to the park and provide an environment that everyone can enjoy.

Kingsford Smith Reserve will provide unprecedented sports, recreation and leisure opportunities within one destination. Defined by an active landscape that embodies both natural ecosystems and a community parkland, Kingsford Smith Reserve will be a place where everyone comes together.

Kingsford Smith Reserve will also be a place of discovery and play - a place surrounded by fauna and flora that connects a true natural setting to a sports and leisure destination. New or renovated sports amenity building, new facilities and amenities, new playgrounds, new gathering spaces and family zones will be connected by a network of new active recreation paths.

In order to shape the way the community experiences Kingsford Smith Reserve the following Place Principles have been developed to ensure a meaningful environment is created that supports the vision of delivering a parkland for all people. These Place

Principles will inform all elements of the master plan to ensure that the future success of Kingsford Smith Reserve is grounded, responsive and community driven.



COMMUNITY FOCUSED



LOCALLY CONNECTED



ENVIRONMENTALLY RESPONSIBLE



EXPERIENTIAL SPACES



Create a parkland that promotes community through spaces that cater for all, all year round.



Create a parkland that enhances the environment through habitat creation and is supportive of flora and fauna processes.

A
RECREATIONAL
HEART
FOR BALLINA



Create a parkland that is connected through a network of recreation loops that support well-being and safety.



Create a parkland that expands the recreational and leisure offer and provides new ways to experience the open space.

Place Themes

Six key place themes have been established based on existing and future opportunities of how Kingsford Smith Reserve will be used by the community. The following section articulates how the vision will be achieved through specific actions and outcomes across the park. These actions will be implemented within the master plan and future delivery of the parkland.



A

SPORTS

Enhance the ongoing role of Kingsford Smith Park as a sporting hub for the North Coast



B

LEISURE

Re-invigorate the parkland with new social spaces that support our coastal lifestyle



C

RECREATION

Facilitate active recreation connectivity and create new opportunities across the parkland



D

PLAY

Create opportunities for play that cater for all ages and abilities



E

CULTURE

Instill a sense of community through social infrastructure that celebrates our culture - past and present



F

ECOLOGY

Protect and restore the parklands natural areas and systems and improve biodiversity



SPORTS

A

Enhance the ongoing role of Kingsford Smith Park as a sporting hub



Rationale

Community sports will remain the key focus of Kingsford Smith Reserve. As a park that houses Rugby League, Cricket, Hockey and Netball, it will provide new and improved facilities that supports the growth of each sporting group and the playing, training and spectator experience within the parkland.

Master Plan Actions

- A.1 Improve sporting facilities to create a greater playing and spectator experience
- A.2 Co-locate facilities to maximise utilisation and activation
- A.3 Transform sports fields surrounds into parkland to provide shade and shelter
- A.4 Re-organise parking across the parkland to improve accessibility and safety
- A.5 Provide new and enhanced facilities to peak sporting association standards for the growth of community sport and active lifestyles.



LEISURE

B

Breathe new life into the parkland with new social spaces that support our coastal lifestyle



Rationale

Across all the three individual parklands a multitude of new social spaces will be inserted into the landscape to provide opportunities to come together or to find a space for respite. The insertion of pavilions, seating and breakout lawns will add a new layer of vibrancy and activation to the parkland that works within the existing natural landscape.

Master Plan Actions

- B.1 Provide opportunities for social gathering
- B.2 Create flexible spaces that embrace the waterfront setting
- B.3 Provide sheltered seating and passive leisure spaces
- B.4 Create new pockets of landscape that allow for exploration and discovery
- B.5 Provide better amenity and access for existing leisure activities within the reserve



RECREATION

C Facilitate variety of active recreation opportunities and improve opportunities for recreation across the parkland



Rationale

Both individually and as a whole, Kingsford Smith Reserve will provide a series of renovated and new recreation opportunities that are connected by a safe network of paths that provide connectivity across the three parks.

Master Plan Actions

C.1	Improve and expand the recreation paths and facilities to foster an active community
C.2	Provide new facilities for community use
C.3	Create walking loops that connect the parkland
C.4	Provide inclusive access and all abilities recreational opportunities.
C.5	Investigate opportunities for outdoor fitness trails and activity centres



PLAY

D Create new opportunities for play that cater for all ages and abilities



Rationale

New and inspiring play will be added to all three parks to activate and support family utilisation of the parkland. Based around nature and discovery, the new play elements will cater for all ages and abilities.

Master Plan Actions

D.1	Investigate opportunities to improve skate park offer
D.2	Explore opportunities for interactive development play
D.3	Create an inclusive all abilities playscape
D.4	Provide opportunities for passive play based around nature and adventure themes



CULTURE

E Instill a sense of community through social infrastructure that celebrates our culture - past and present



Rationale

Kingsford Smith Reserve will celebrate the community's history and cultural heritage through education, story telling and by providing spaces that support community and cultural events

Master Plan Actions

- E.1 Create open spaces that cater for community events
- E.2 Use landscape elements to create a narrative around place and cultural heritage
- E.3 Provide opportunities for public art and installations
- E.4 Create a distinct coastal landscape character through materiality and planting



ECOLOGY

F Restore and enhance the parkland's natural flora and provide and protect habitat for local fauna



Rationale

New landscape spaces will focus on enhancing ecosystems to protect and enhance natural areas and provide new habitat for local fauna.

Master Plan Actions

- F.1 Work with existing trees to maintain canopy cover and preserve significant habitat areas
- F.2 Provide new and enhance habitat through native landscape planting
- F.3 Maintain hydrology flows and enhance the sites bio-retention capacity
- F.4 Provide opportunities for education
- F.5 Manage lighting to support night light fauna activity

Key Moves of the Master Plan

The design of the Master Plan is underpinned by a series of key moves that unlock the site's potential in order to facilitate the delivery of the vision and the Master Plan action set out in the previous section.

ACTIVATE THE LAKE

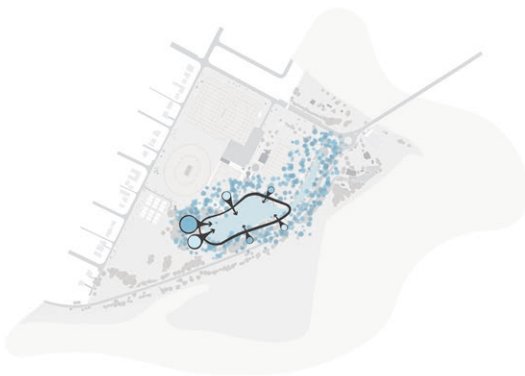

Create and connect activity nodes by the banks of the lake

CREATE CONNECTIONS

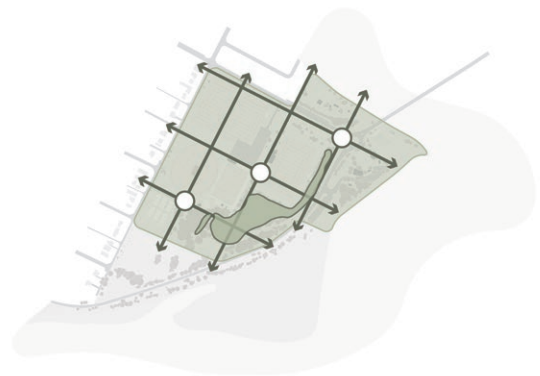

Deliver a hierarchy of paths that support strategic internal and external connections

PROVIDE POCKETS OF PLAY



Invigorate pockets within the parks for leisure and play space

ENHANCE THE SPORTING EXPERIENCE

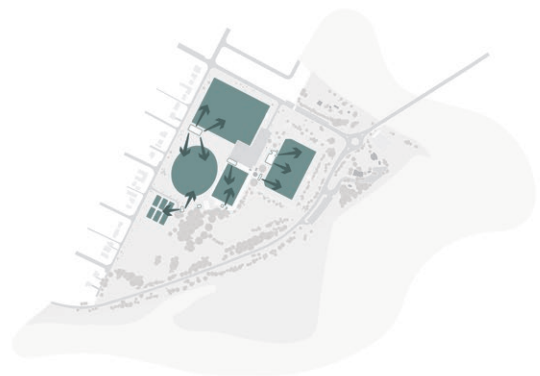

Improve facilities and sports amenity building to better suit each sporting community

PROTECT THE ENVIRONMENT

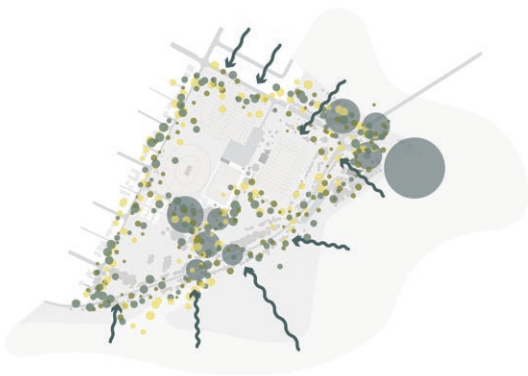

Embrace the reserves natural elements and support the existing habitats

EMBRACE THE WATERFRONT



Support Ballina's peninsula and increase opportunities for recreation and leisure along the waterfront





Kingsford Smith Reserve



Our plan for revitalisation

Part C

The Master Plan

The plan opposite provides a detailed illustration of the Master Plan and is supported by illustrations and key strategies and outcomes on the following pages. Although the content of the plan is well documented within this section, it is worth noting that additional detail of each park is provided in Part D - Our Key Places.

LEGEND

Study Area	
KINGSFORD SMITH PARK	
Formalised parking to Owen Street	01
Reconfigured central parking area	02
New parking area	03
Tree planting to provide shade and edge to parkland	04
Landscape tiered seating	05
Shade structure with seating	06
Shared sports amenity building (new)	07
Formalised cricket oval	08
Sports amenity building (new)	09
New Netball courts	10
Existing amenities	11
Primary sports amenity building (renovated or new)	12
New amenities eastern edge	13
Infrastructure to activate space	14
Existing Boat Model makers storage facilities and amenities	15
Revitalised lake edge and new lakeside walk	16
Lakeside nature play	17
Stage 1 change room facilities	18
MISSINGHAM PARK	
Reconfigured parking area and drop-off zone	01
Half court basketball and hardstand space for events	02
Tree top playground	03
Toddler playground	04
Event lawn and stage	05
Shaded break out lawns	06
Waterfront landscape pavilions	07
Expanded skate park	08
Scooter track	09
Widened waterfront path with seating	10
Formalised parking along Kingsford Smith Drive	11
Existing significant trees habitat areas	12
COMMEMORATION PARK	
Market lawn	01
Mounded breakout lawns	02
Existing and renovated amenities	03
Widened waterfront path with seating	04
Waterfront landscape pavilions	05

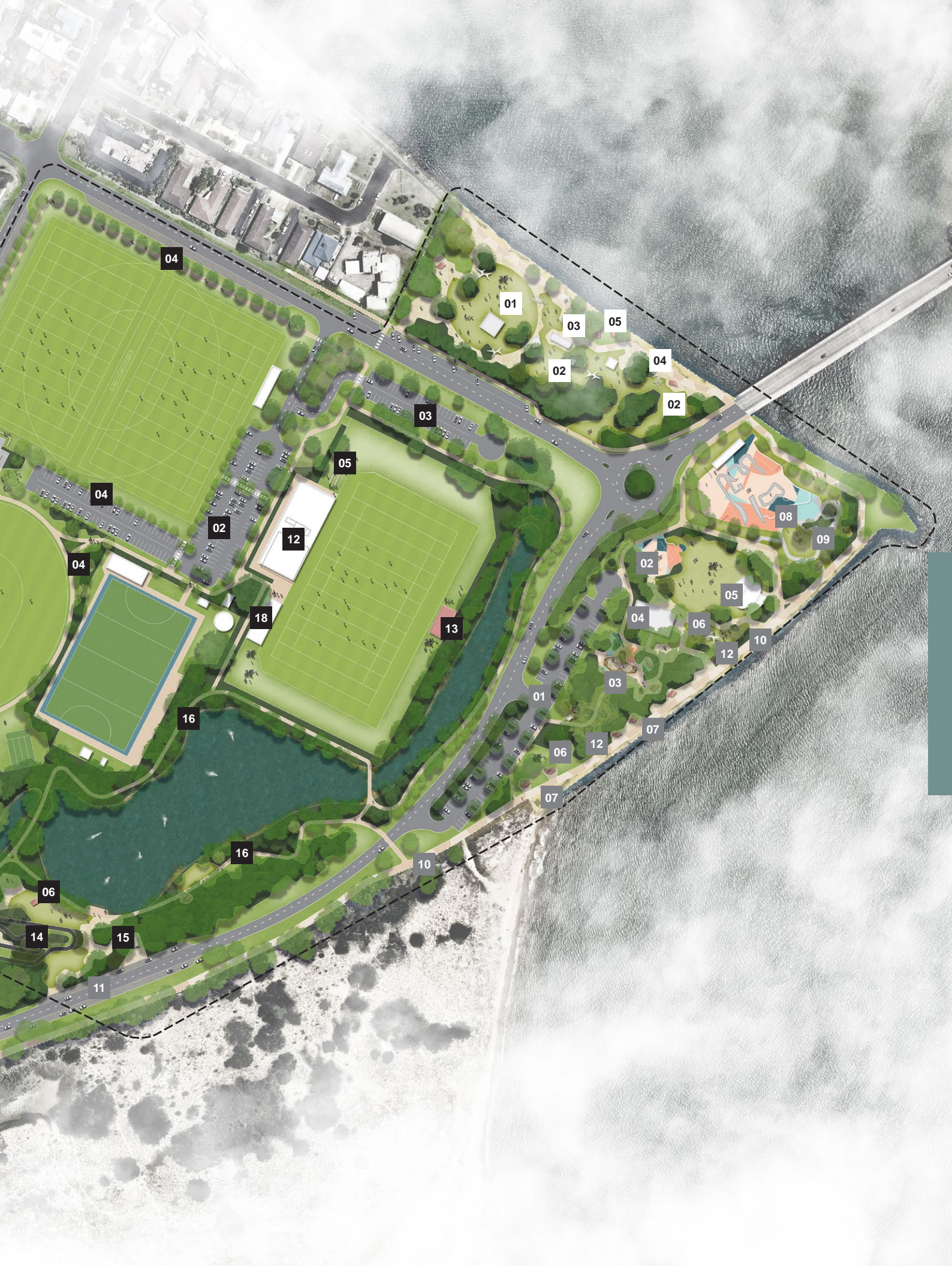



INDICATIVE VIEW OF WATERFRONT
PROMENADE FROM MISSINGHAM PARK





INDICATIVE VIEW OF LAKE AND NATURE PLAY



Master Plan Strategies and Outcomes

Kingsford Smith Reserve will transform into a place of play, sport, celebration, surprise and fun. New sporting facilities, shady open space, community lawns, nature playgrounds, recreation loops and a lively waterfront promenade come together to create a truly diverse and well-connected environment where everyone is welcome.

Kingsford Smith Park, Missingham Park and Commemoration park offer unique landscape experiences that are integrated as a single destination through complementary opportunities to engage with the water and parkland and provide the community with an active and healthy coastal lifestyle.

This section of the report sets out in detail the design and delivery strategies and outcomes that underpin the Master Plan.

A SPORTS AND FACILITIES

B ACCESS AND CONNECTIVITY

C PLAY AND LEISURE AMENITY

D SAFETY, SECURITY AND LIGHTING

E ENVIRONMENT AND HABITAT

F LANDSCAPE CHARACTER

Sports and Recreation Facilities

Amenity Buildings and Fields









Key Outcomes

- Upgrade of main amenity building and change rooms
- New shared community sport amenity buildings
- New netball courts

Facilities and Surrounds

Key Outcomes

- Expanded skate park to include street course, scooter loop and possible pump track or other infrastructure to activate space
- Shade creation through landscape and shelters
- Reconfigured parking areas to provide better accessibility and safety
- Provision for lighting upgrades at Kingsford Smith Park
- Provision for exercise infrastructure around event lawn

-  Access to Sport Facilities
-  Fence Line
-  Amenity Buildings
-  Sporting Fields
-  Netball Courts
-  Recreational Sports
-  Event Lawn
-  Shaded Facilities

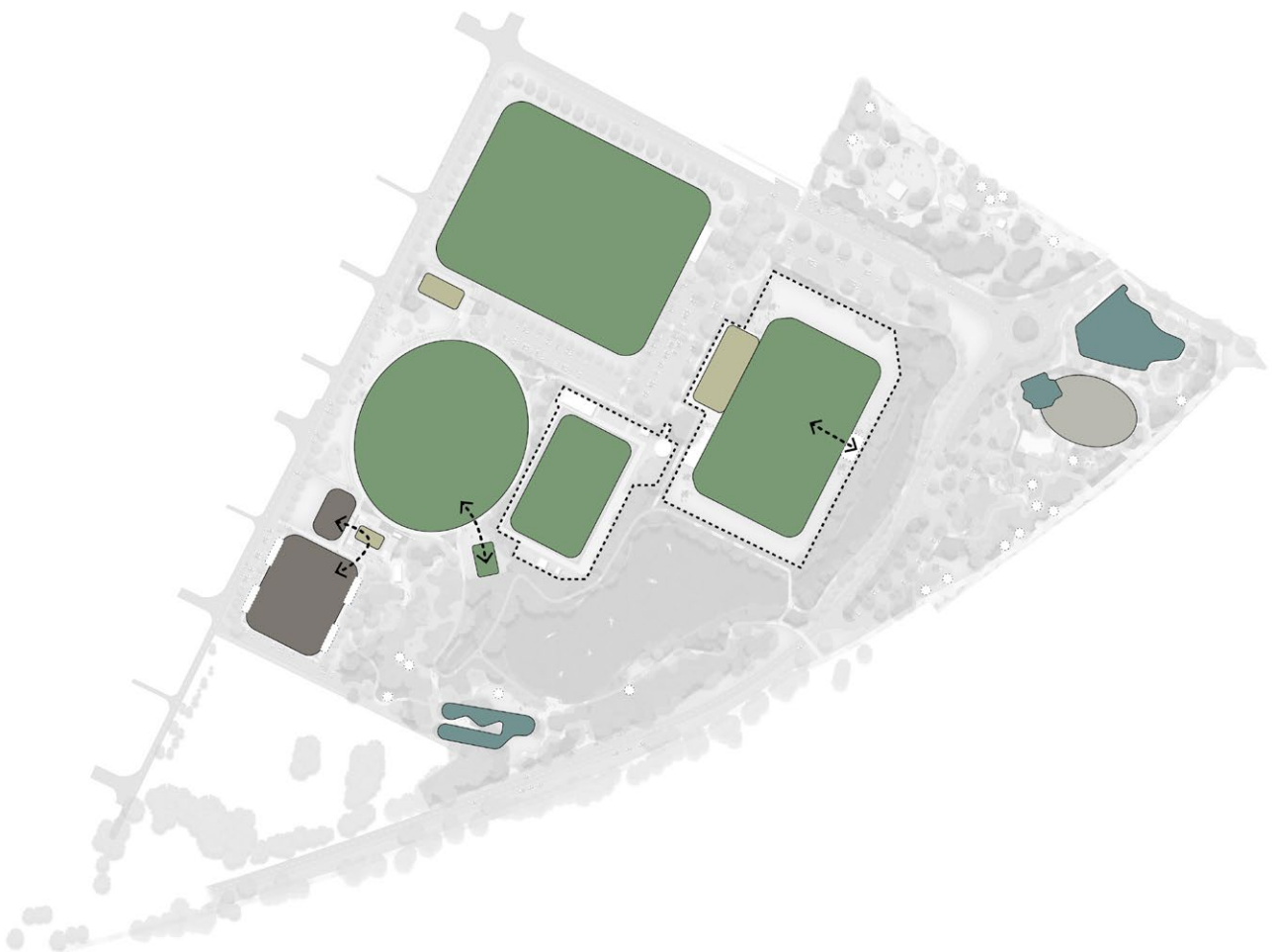

Access and Connectivity

Carparking and access

Key Outcomes

- Reconfigured parking areas to provide better accessibility and safety
- Increased capacity across site
- Trees to be planted around parking to provide shade
- Safe traffic crossings from parking areas to external destinations
- Improved flow and crossing points for safety
- Additional lighting

Pedestrian and recreation loops

Key Outcomes

- Widened promenade along waterfront to support shared access
- New circulation loops throughout parkland
- Creation of 1500m "Kingsford Smith Loop" for active recreation
- Provision for lakeside path to activate hidden pocket within Kingsford Smith Park
- Discovery paths through nature play zones

- Road Access
- - - Kingsford Smith Loop
- . . . Footpath
- • • • Waterfront Promenade
- ▭ Improved Carparks
- Nature Play

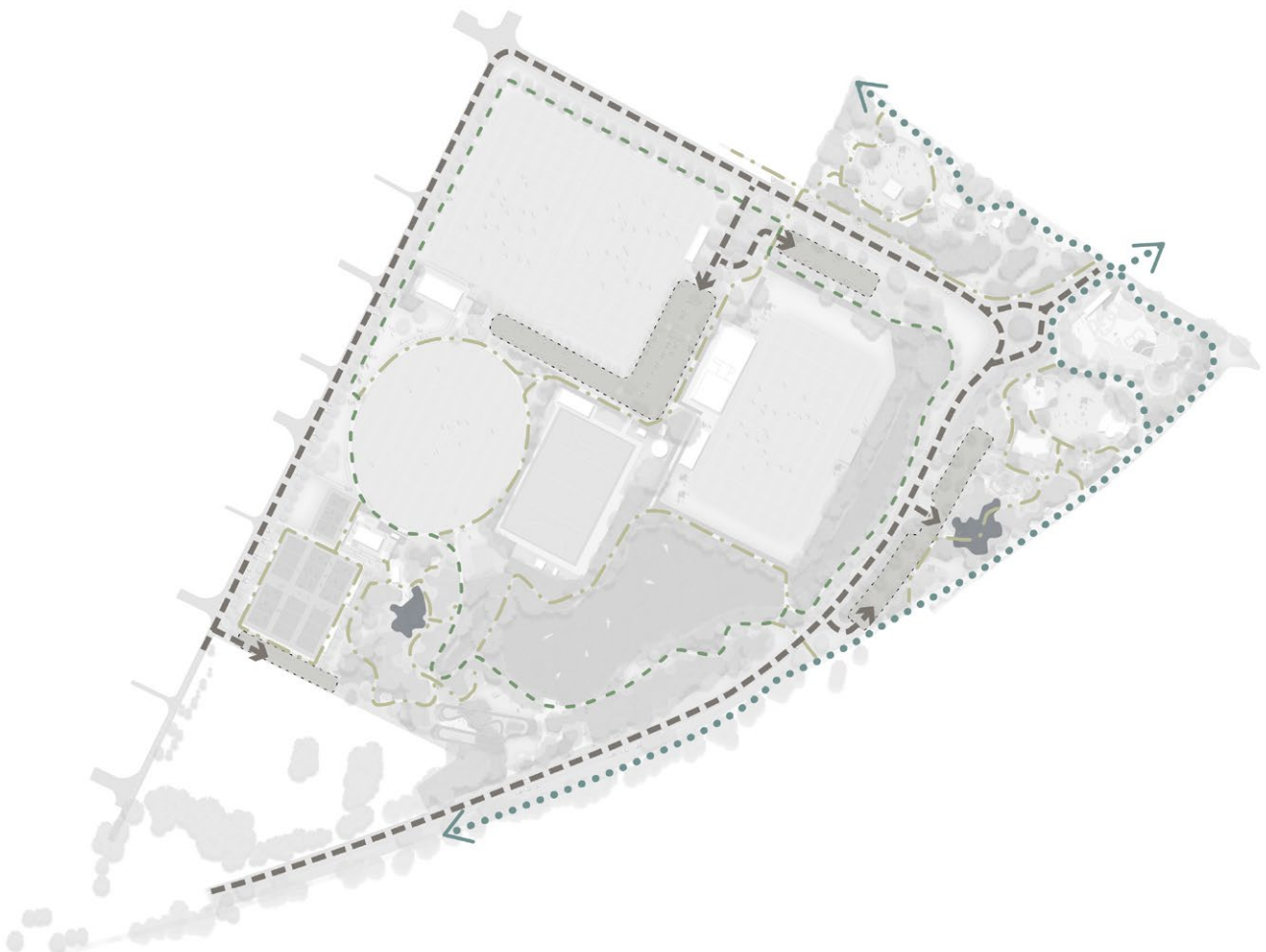

Play and Leisure Amenity

Play

Key Outcomes

- New playground facilities within Missingham Park that cater for all ages and abilities
- Provision for nature play by the lake at Kingsford Smith Park
- Infrastructure to activate the space, e.g. pump track or other active play
- Sculpture play and discovery through Commemoration Park

Amenities

Key Outcomes

- Landscape pavilions with BBQ facilities adjacent to breakout lawns
- Shaded seating adjacent to the playgrounds to facilitate family gatherings and observation of playing children
- New amenities block and stage at event lawn
- New amenities



Events

Key Outcomes

- Event lawn with new stage and amenities
- Provision for expansion of markets in Commemoration park and supporting infrastructure including power and water



Safety, security and lighting

CTPED and Lighting

Key Outcomes

- Enhanced lighting at facilities, carpark and along paths
- Enhanced activation through park to provide widespread usage and casual surveillance
- Provide clear sight lines through park and planting areas
- Lighting provisions aligned to ecological requirements for marine fauna

Security and Fencing

Key Outcomes

- Provision for low fencing &/ or bollards along Owen and Bentinck Streets
- Provision for bollards along parking areas with access points for emergency and maintenance vehicles
- Provision for possible future CCTV around sports amenity building and amenities

- Fenceline
- - - Pathway Lighting
- • • Bollards
- Area Lighting

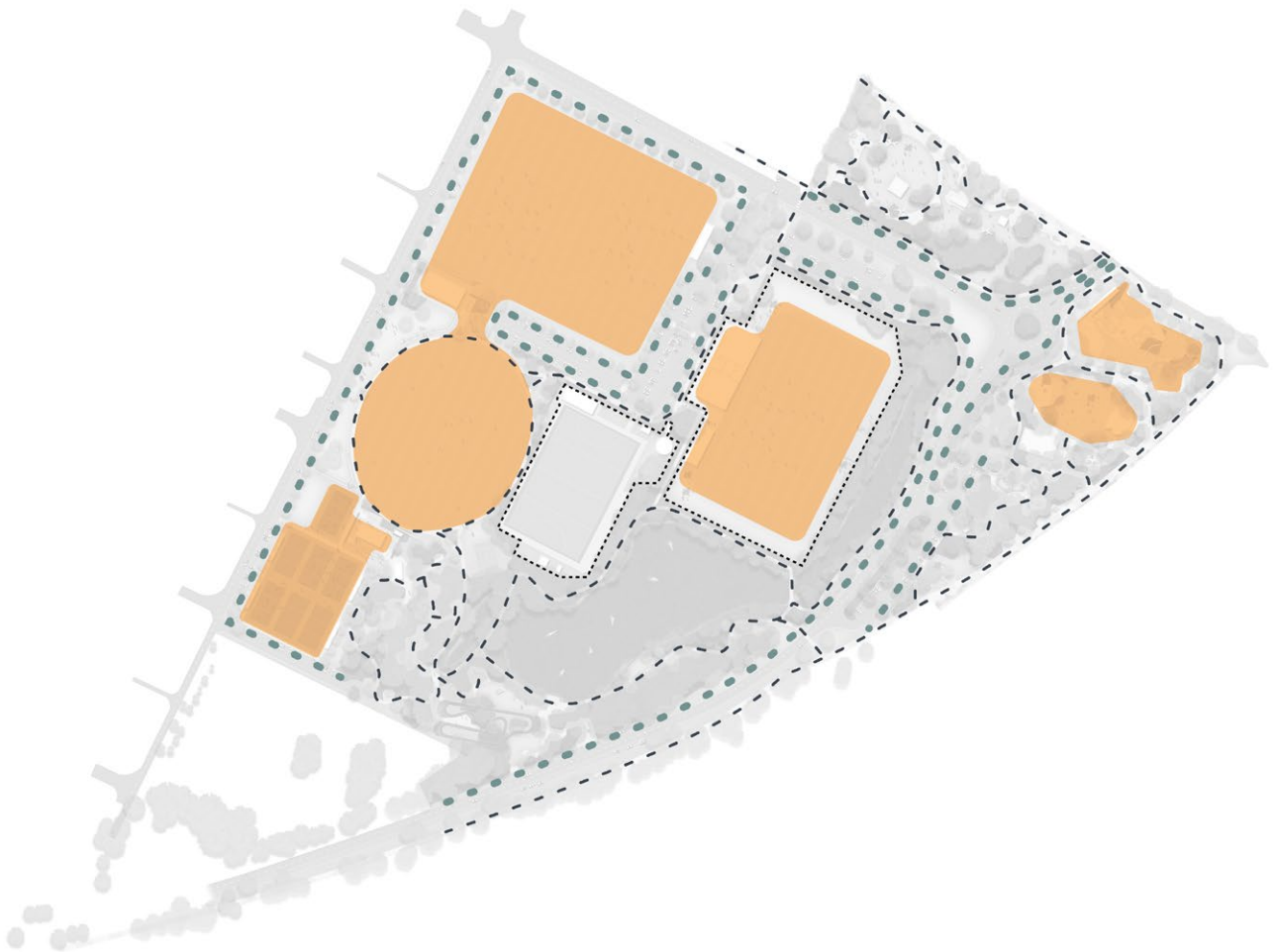

E

Environment and habitat

Vegetation

Key Outcomes

- New planting throughout park-land
- Existing trees maintained
- Use of native vegetation
- Provision of planting signage for education and learning
- Nature play and leisure space within dense vegetation to activate landscape for safety
- New avenue of trees along street to provide a planted edge to Kingsford Smith Park

Hydrology

Key Outcomes

- Enhance function of existing hydrological flows across site
- Use additional bio-retention measures to clean water
- Improve drainage of sports fields and surfaces

- — — — — Activating the Waterfront
- - - - - > Water flow
- — • Proposed Tree Avenue
- Existing Trees
- Activation of the Lake
- Landscaped Areas
- Bio Basin



Landscape Character

Planting

The planting at Kingsford Smith Reserve will be characterised by the setting and the native species of the region . The planting approach will create a natural coastal environment that will apply a combination of species selected for their ability to enhance the overall vitality and character and provide habitat for local fauna.



Indicative Planting Schedule

Trees	Shrubs / Ornamental	Groundcovers
Xanthorrhoea johnsii	Acmena smithii (dwarf)	Poa labillardieri
Melaleuca quinquenervia	Banksia aemula	Cordyline congesta
Doryanthes palmeri	Melaleuca thymifolia	Imperata cylinderica
Pittosporum undulatum	Dianella caerulea	Carpobrotus rossii
Cupaniopsis anacardioides	Backhousia citriodora	Carpobrotus glaucescens
Neolitsea dealbata	Ficus coronata	Rhagodia candolleana
Ficus macrophylla	Doryanthes palmeri	Carex appressa
Elaeocarpus grandis	Macrozamia johnsonii	Ficinia nodosa
Banksia marginata	Zamia furfuracea	Leucophyta brownii
Flindersia australis	Cordyline fruticosa	Lomandra longifolia
Grevillea robusta	Cordyline congesta	Lomandra filiformis 'Savanna Blue'
Syngium moorei	Cordyline rubra	Lomandra 'Shara'
Araucaria cunninghamii	Austromyrtus dulcis	Lomandra 'Lucky stripe'
Pandanus tectorius	Alocasia brisbanensis	Dianella caerulea
Casuarina glauca	Asplenium australasicum	Casuarina glauca
Banksia integrifolia	Westringia fruticosa	Myoporum parvifolium
Macaranga tanarius	Syngium leuhamii	Chrysocephalum apiculatum
Elaeocarpus reticulatus	Syngium australe	Hardenbergia violacea
Waterhousea floribunda	Syngium paniculatum	
Tristania laurina	Ozotamnus radiance	
Lophostemon confertus	Callistemon 'Little John'	
	Callistemon 'Red rocket'	
	Melaleuca 'Revolution green'	
	Melaleuca 'Claret tops'	
	Grevillea 'Pink pixie'	
	Grevillea 'Honey gem'	

Materiality

The hardscape of Kingsford Smith Reserve will create a truly coastal setting that is defined by sandy tones and coastal textures. The application of the material palette will be create a consistent character across the reserve.



Play

Across the parkland, a combination of formalised play products, nature play and sports and exercise equipment will be used to create a variety of play experiences. All play will cater for children of all ages and ability and provide seating adjacent to playgrounds for surveillance by parents.

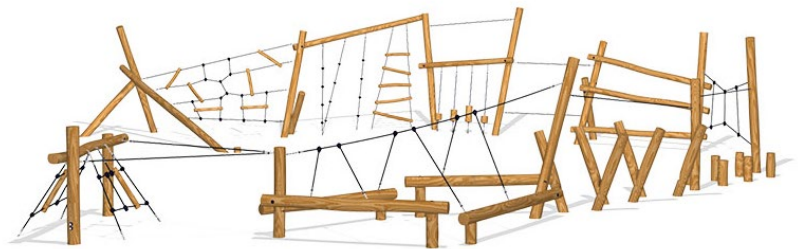
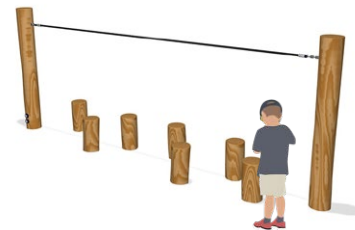

Landscape Elements

The urban elements and furniture will bring a uniqueness and quality into the public realm that celebrates Kingsford Smith Reserve as unique precinct. The overarching strategy for the urban elements and furniture is to add visual delight to the environment that ties into the character of the surrounding context.

Lighting will be utilised to maximise a dramatic effect by strongly illuminating key landscape elements such as sports amenity facilities, pavilions and playgrounds but will ensure it does not have a detrimental affect to night time fauna activity.



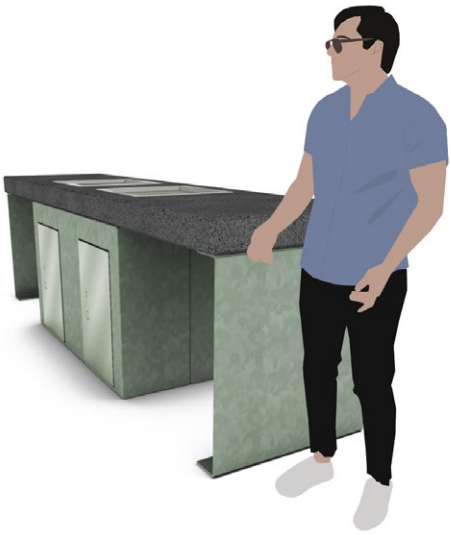



INDICATIVE VIEW OF NETBALL PRECINCT





Kingsford Smith Reserve

Our key places

Part D

Key Places and Actions

The Master Plan of Kingsford Smith Reserve includes the revitalisation of Kingsford Smith, Missingham and Commemoration parks. The following section provides detail of specific design outcomes for each park, the design intent and its role in contributing to the overall vision of the parkland.



PLACE THEMES

			KINGSFORD SMITH	MISSINGHAM	COMMEMORATION	
A	SPORTS Support the ongoing role of Kingsford Smith Park as a sporting hub	A.1	improve sporting facilities to create a greater playing and spectator experience	●	●	
		A.2	co-locate facilities to maximise utilisation and activation	●		
		A.3	transform sports fields surrounds into parkland	●		
		A.4	re-organise parking across the parkland to improve accessibility	●	●	
		A.5	provide new and enhanced facilities to support community sport	●		
B	LEISURE Re-invigorate the parkland with new social spaces that support the coastal lifestyle	B.1	provide opportunities for social gathering	●	●	●
		B.2	create flexible spaces that embrace the waterfront setting		●	●
		B.3	provide sheltered seating and passive leisure spaces	●	●	●
		B.4	create new pockets of landscape that allow for exploration and discovery	●	●	●
		B.5	provide better amenity and access for existing leisure activities within the reserve	●	●	
		B.6	celebrate and invigorate the existing composition and values of each park	●	●	●
C	RECREATION Facilitate active recreation connectivity and create new opportunities across the parkland	C.1	improve and expand the recreation paths and facilities to foster an active community	●	●	●
		C.2	provide new facilities for community use	●	●	●
		C.3	create walking loops that connect the parkland	●	●	●
		C.4	provide inclusive access and all abilities recreational opportunities	●	●	●
		C.5	investigate opportunities for outdoor fitness trails	●	●	●
D	PLAY Create opportunities for play that cater for all ages and abilities	D.1	investigate opportunities to improve skate park offer		●	
		D.2	explore opportunities for nature play		●	
		D.3	create an inclusive all abilities playscape	●	●	●
		D.4	provide opportunities for passive play based around nature and adventure themes	●	●	
E	CULTURE Instill a sense of community through social infrastructure that celebrates our culture - past and present	E.1	create open spaces that cater for community events	●	●	●
		E.2	use landscape elements to create a narrative around place and cultural heritage	●	●	●
		E.3	provide opportunities for public art and installations	●	●	●
		E.4	create a distinct coastal landscape character through materiality and planting	●	●	●
F	ECOLOGY New landscape spaces will focus on enhancing ecosystems to protect and enhance natural areas and provide new habitat for local fauna	F.1	work with existing trees and preserve significant habitat areas	●	●	●
		F.2	provide new and enhanced habitat through native landscape planting	●	●	●
		F.3	maintain hydrology flows and enhance the site's bio-retention capacity	●	●	●
		F.4	provide opportunities for education and landscape learning	●		●
		F.5	manage lighting to support night light fauna activity	●	●	●

Commemoration park

Commemoration Park will celebrate the coastal setting through a sculptural landscape of meandering planting and unstructured paths, mounded lawns and a central open space. Set on the banks of North Creek, it will provide a natural picturesque landscape for social gatherings and small local events to unfold.

Commemoration Park builds on its current qualities to create a sculptural landscape that performs in a number of ways. It builds on the established landscape and to create a meandering body of vegetation that creates pockets of mounding lawn. These lawns provided passive breakout spaces for social gatherings in shaded areas with views over North Creek. With a central “market lawn” as the centre of the parkland, unstructured paths define the space and provide connections through to the waterfront from Bentinck Street. The waterfront is activated through seating and shelters and a widened promenade that cuts into the parkland to create pockets of lawn on the waters edge.

As a sculptural landscape that speaks to a coastal setting, Commemoration Park showcases native vegetation for the community to engage with and learn about.

Social gathering are supported by shade structures with seating, BBQs, shaded lawns and sculptural play pieces, which also provide additional amenity for the expansion of the Markets across the Parkland.

Key Elements

- Market Lawn
- Sculptural landscape forms through planting and mounding lawns
- Passive play elements
- Native planting discovery learning
- Social gathering pavilions
- Waterfront lawn
- Waterfront promenade with seating
- Retention of exercise equipment
- Vehicle access is required for markets



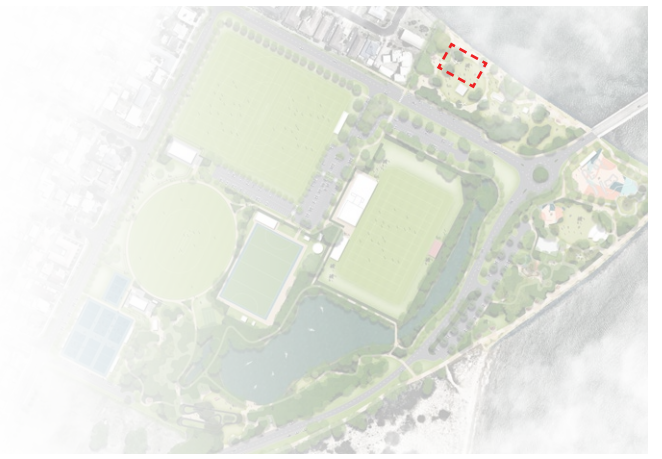

INDICATIVE VIEW OF MARKET LAWN



LEGEND

Commemoration Park site area	
Commemoration 'market' lawn	01
Sculptural breakout lawns shaded by coastal vegetation	02
Waterfront lawn with landscape pavilions for social gatherings	03
Widened waterfront Promenade with seating	04
Upgraded amenities	05
Pedestrian crossing with safety island along Bentinck Street	06
Existing exercise stations	07
Bollards along southside of Bentinck Street	08



Exemplar imagery of key elements and landscape character



Waterfront promenade



Waterfront lawn



Community gathering on 'market' lawn



Educational signage



Coastal planting and gravel paths



Mounding lawns



Public art playscape



Unstructured paths

Missingham Park

Missingham Park will be a place thriving with fun-filled activity, by both day and night. From an urban skate park to a series of playscapes set within the trees, it will provide a network of connected social gathering spaces and experiences that encapsulate the communities desire for a family orientated parkland.

Missingham Park forms the centrepiece of the waterfront parkland. The variety of experiences provided within the parkland compliment the waterfront setting and natural landscape. Its enviable natural setting will be enhanced through an interlaced web of functional open spaces, outdoor rooms and playgrounds that create and encourage interaction within the community

Together, the spaces and variety of offering will provide multiple opportunities for cultural and community engagement and fun. Through its revitalisation it will deliver a destination parkland where you can enjoy comfort and shade of the natural landscape in a family friendly setting.

Key Elements

- Waterfront lawn for community events with new stage and amenities
- A series of play spaces, including the feature adventure playground themed around a 'casuarina forest'
- Social gathering pavilions adjacent to breakout lawns and play spaces
- Expanded skate park with street skate plaza and scooter track
- Half court Basketball court and space for community exercise
- Waterfront promenade with seating
- Improved pathway network and access throughout the park
- Retain significant trees and habitat areas



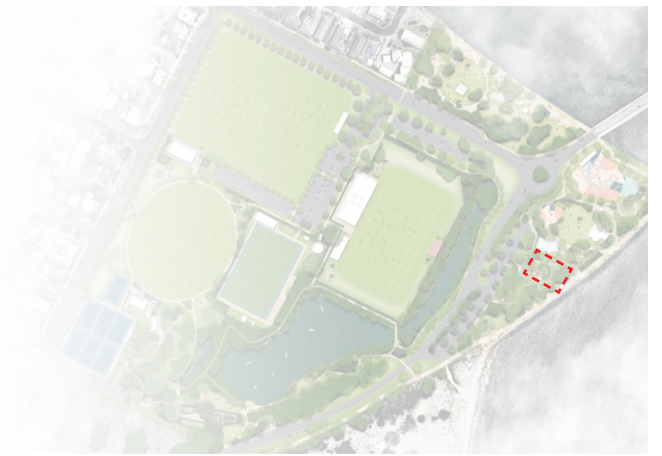

LEGEND

Missingham Park site area	☐
Reconfigured parking area and drop-off zone	01
Half court basketball and additional hardstand for events and exercise groups	02
Event lawn	03
New stage and amenities block	04
Toddler playground	05
'Casuarina' adventure playground with climbing nets, slide and swings	06
Interactive discovery playground	07
Existing vegetation with increased ground cover and shrub planting	08
Widened waterfront path with seating and landscape pavilions	09
Expanded skate park to include street plaza and hardscape plaza for events	10
Scooter loop	11
Waterfront lawn	12
Playscape pathways	13
Path to Kingsford Smith Lake	14
Retained significant trees	15

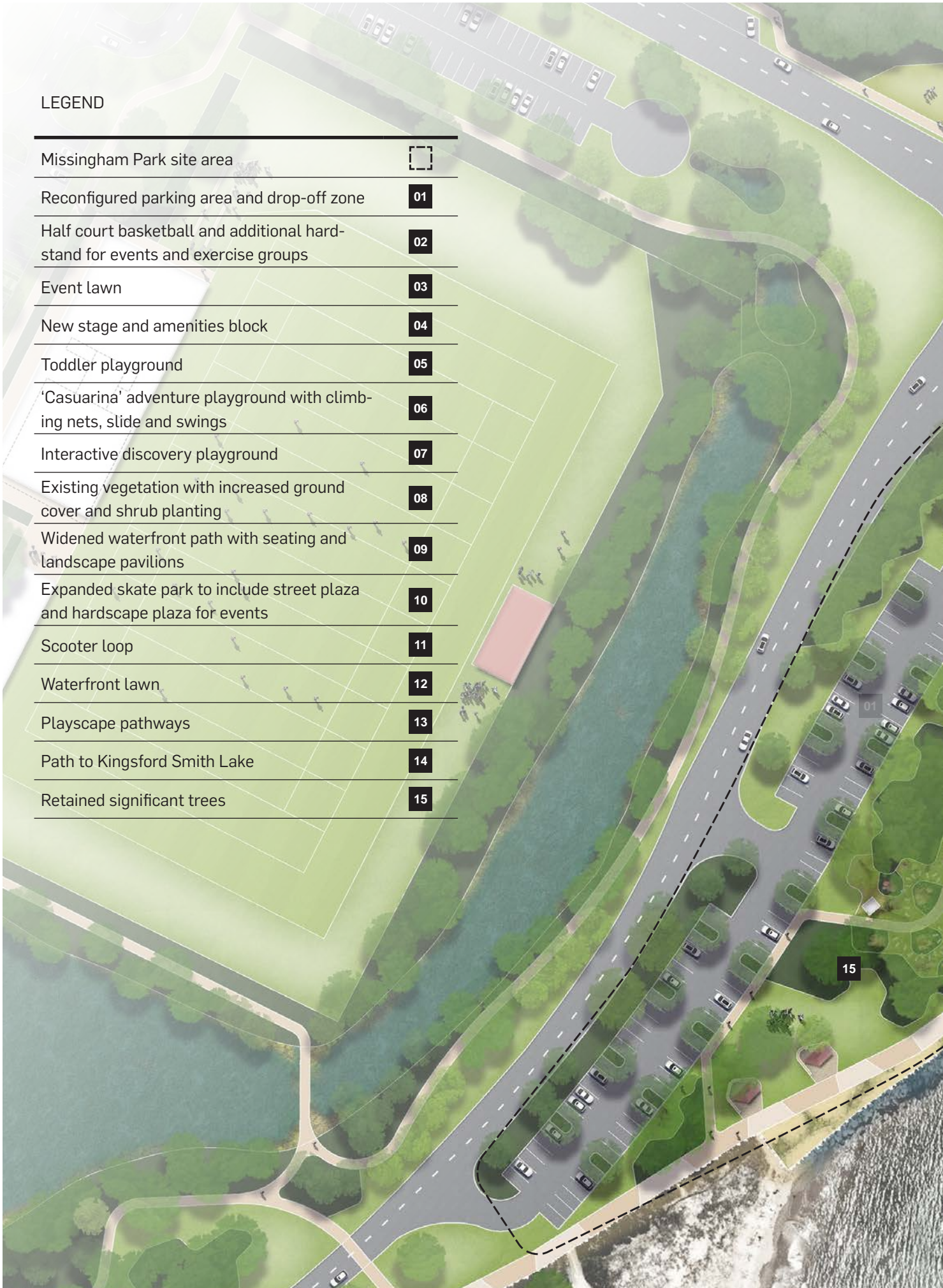



Exemplar imagery of key elements and landscape character



Playground



Waterfront seating



Informal gathering on breakout lawns



Skate park seating and shaded seating

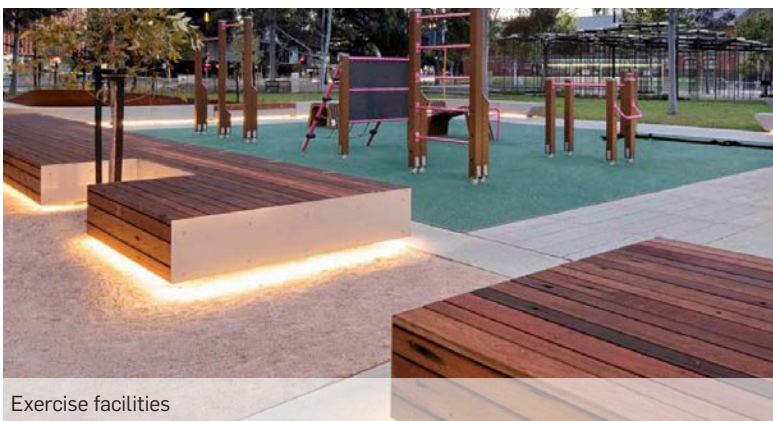

Exercise facilities



Basketball Court

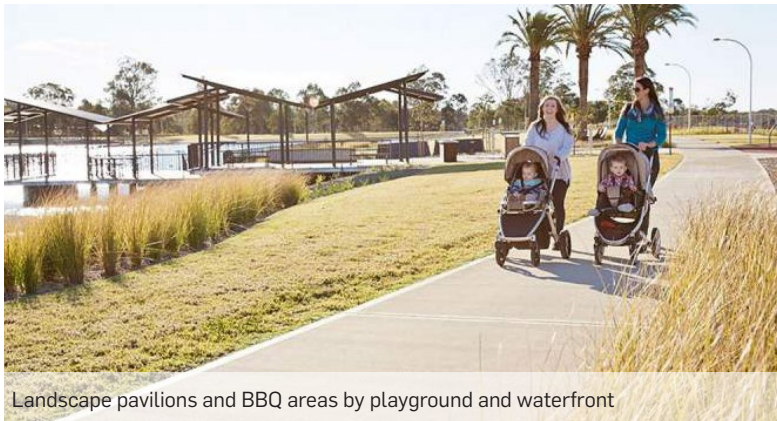

Landscape pavilions and BBQ areas by playground and waterfront

Scooter loop



Skate Park



Playground

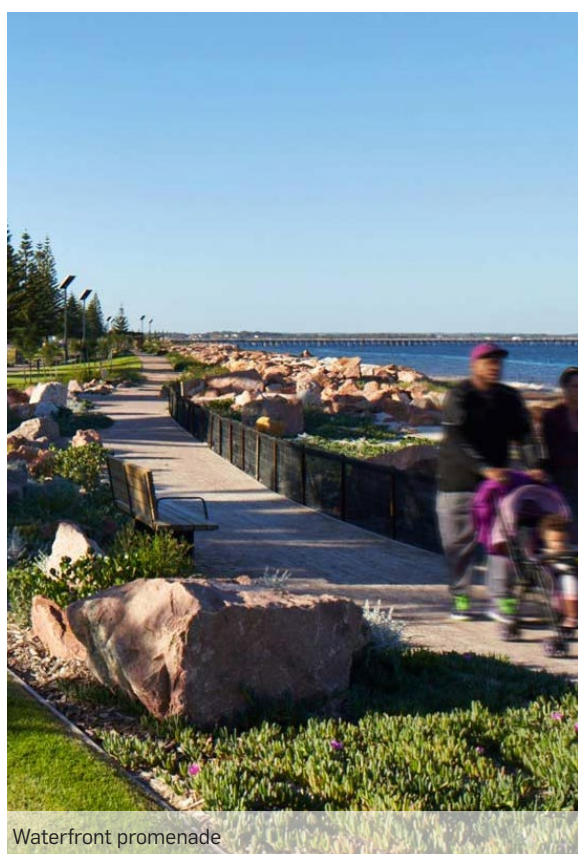

Waterfront promenade

Kingsford Smith Park

Kingsford Smith Park will be a regional sporting hub and Ballina's heart of community sport and leisure. With new sporting facilities set within landscaped spaces and an activated lake, a full spectrum of uses will be integrated into the parkland to unlock its potential as multi-functional open space.

Kingsford Smith Park will be reinvigorated with new sporting amenity buildings, infrastructure and surrounds to position it as the regions premier sporting parkland. Its sporting offer will be complimented with the insertion of recreation loops that connect in and around the lake to activate its edges and surrounds. Nature play, landscape pavilions and breakout lawns will create a destination in itself and position Kingsford Smith Park as a multi-function sports and recreation parkland.

Key Elements

- New shared sporting amenities and change rooms.
- Reconfigured parking to provide better access to sporting destinations and provide a safer environment
- Additional landscape to provide shade and comfort for spectators
- Shelters for all season viewing
- Nature play set within the trees
- Infrastructure to activate the space; the pump track image shown is indicative and there are many other options that could be considered here, such as reinvigorating the memorial walk
- Recreation paths including a 1500m loop
- Landscape pavilions and breakout lawns
- Improved access to the lake for existing leisure activities

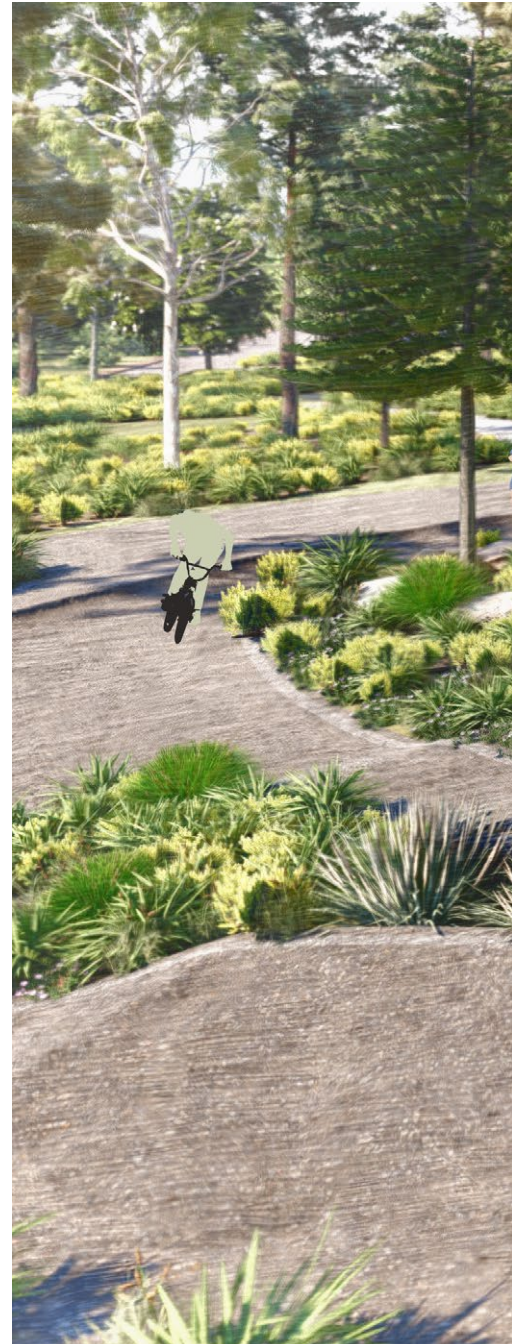

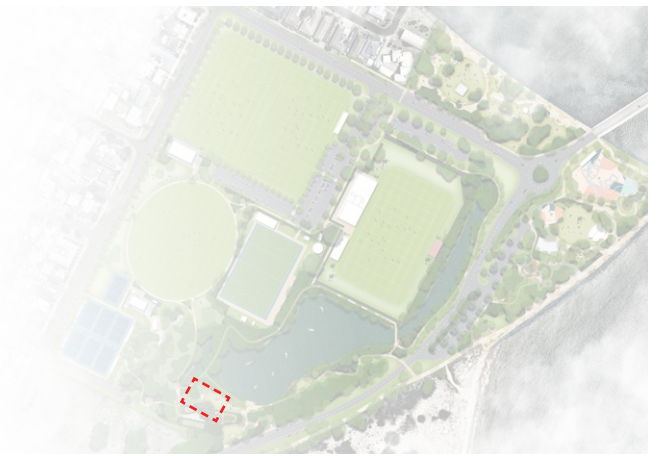

INDICATIVE VIEW OF ACTIVATED AREA NEAR THE LAKE



LEGEND

Kingsford Smith Park Site Area	
Formalised parking to Owen Street and Bentinck	01
Reconfigured central parking area	02
New parking area	03
Tree planting to provide shade and edge to parkland	04
Landscape tiered seating	05
New shelter structure	06
New shared sports amenity building	07
Formalised cricket oval	08
New sports amenity building	09
New Netball courts	10
Existing amenities	11
Enhanced primary sport amenity building to standards, seating (new) and change rooms	12
Shaded seating	13
Pump track	14
Boat model makers storage facilities and formalised access to lake	15
Revitalised lake edge and new lakeside walk	16
Lakeside nature play	17



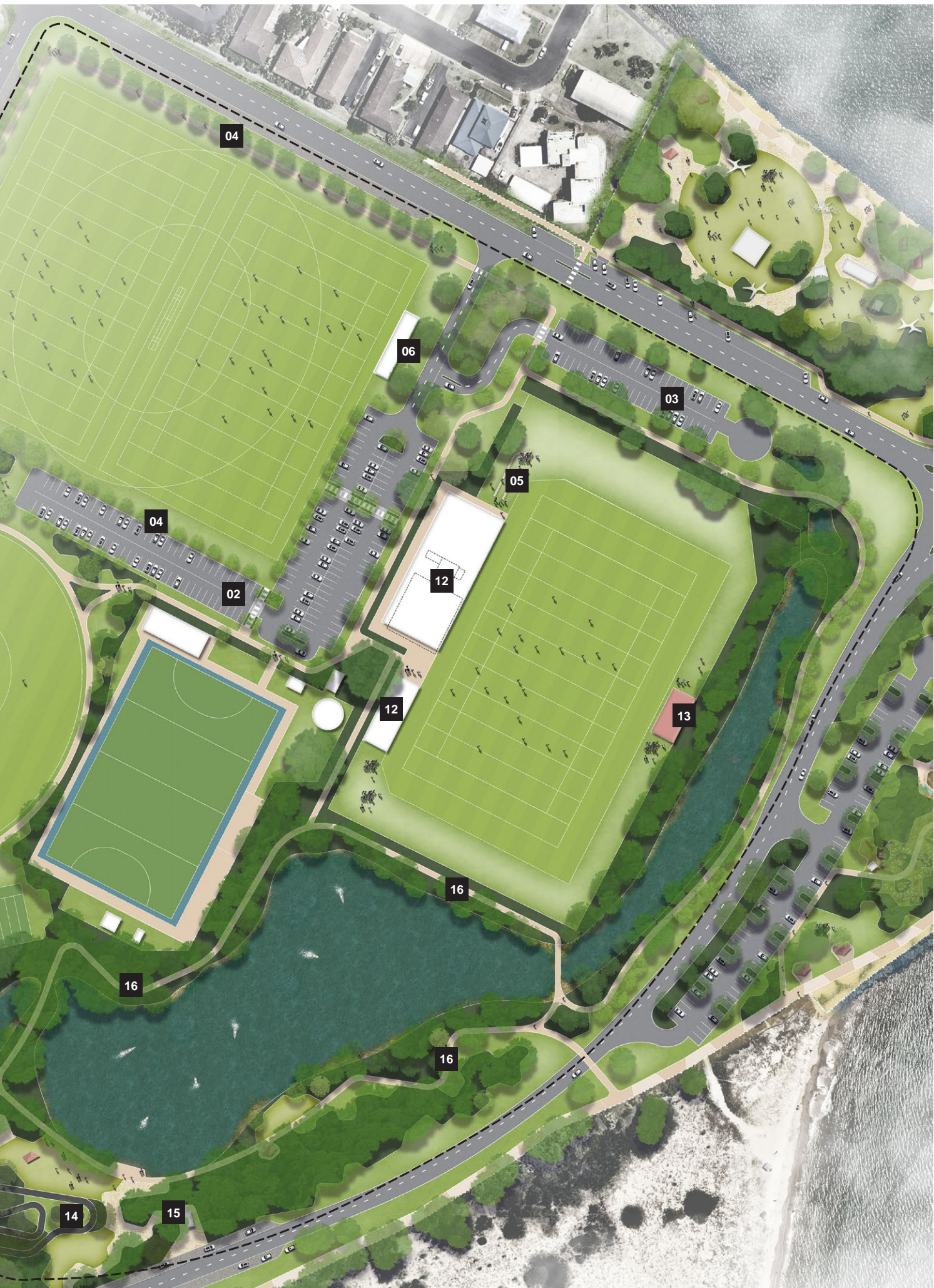

Exemplar imagery of key elements and landscape character



Sports fields

Netball courts and shelters

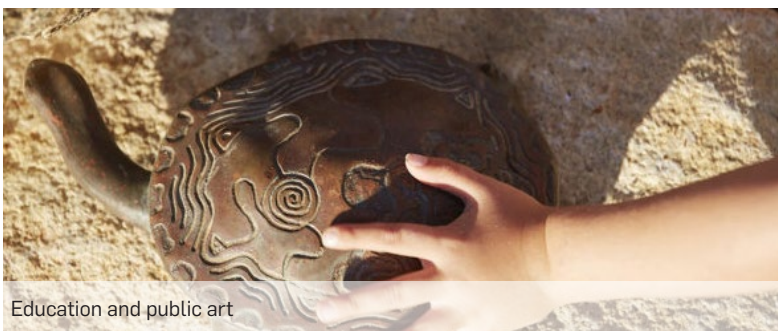

Education and public art



Informal gathering on breakout lawns

Leisure and discovery paths around lake



Lakeside social spaces

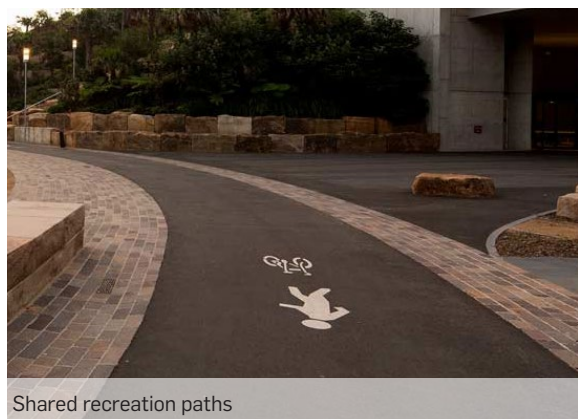

Shared recreation paths



Landscape pavilions and BBQ areas by the lake

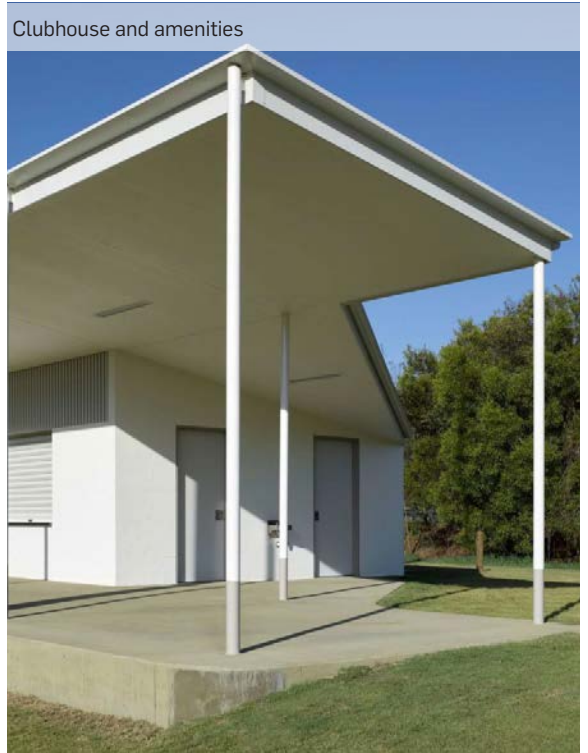

Clubhouse and amenities



Lake activation



Nature Play



Activated Space around Lake



Primary Sports Amenity Building and Seating



Nature Play



Kingsford Smith Reserve

Where to from here?

Part E

E.1

Costs and Priorities

The Master plan provides a framework for future planning and investment at Kingsford Smith Reserve that over time will become the regions most significant community parkland.

The previous sections of the document set out the long-term vision for Kingsford Smith Reserve. The plans and images within it effectively convey the overall intent, without being so prescriptive as to prejudice design changes over time. It is the intent of the master plan to set out the overall vision and key actions to be delivered as funding become available. The master plan will be used to guide future planning, detailed design and provide a framework for staged delivery.

Based on the master plan drawings, funding of the long-term master plan would be approximately \$25M*. This includes higher order costs as below;

1. Kingsford Smith Park - \$15M*
2. Missingham Park - \$7M*
3. Commemoration Park - \$3M*

The first stage of delivery is based on \$3,600,000 of available funding. This investment into Kingsford Smith Park is specifically for improvement and upgrades to sporting facilities. Based on community consultation and key action of the master plan the priority projects include;

1. Lighting improvements
2. Change room / amenity improvements to bring in line with current sporting access, equity and inclusivity guidelines;
3. Grandstand improvements

4. Netball facility upgrades
5. Surface improvements
6. Carparking upgrades

While these projects are the priority, detailed design and cost planning is required to better define the detailed scope of Stage 1. Council will continue to work with community groups and government to attract additional funding to support the delivery of more priority projects identified in this master plan. All future stages of work are currently unfunded.

*INDICATIVE COST ONLY BASED ON M² RATE. FURTHER COSTING DETAIL WILL BE PROVIDED IN FINAL MASTER PLAN

E.2

Future Process

As part of the master planning process, the following next steps will be undertaken to progress the master plan to the first stage of delivery.

