

1. **Attendance and Apologies**

2. **Declarations of Interest**

3. **Confirmation of Minutes**

A copy of the Minutes of the "B" Ward Committee held 15 November 2010 were distributed.

**RECOMMENDATION**

That the Minutes of the "B" Ward Committee held 15 November 2010 be taken as read and confirmed.

4. **Deputations**

**Ranger Activities/Update**

Kerri Watts from Councils' Regulatory Services Group will provide an update on Ranger activities in the Shire.

5. **Outstanding Business – 20 September 2010 meeting**

(a) **Reduction of speed limit for Tintenbar road from the top of the hill to the Highway to 60 km per hour**

A request has been forwarded to the RTA for a change to the speed zone.

(b) **Directional signage northern roundabout at Ross Lane**

Attached are copies of the latest versions of signage and linemarking designs held by Council for the connection to Ross Lane.

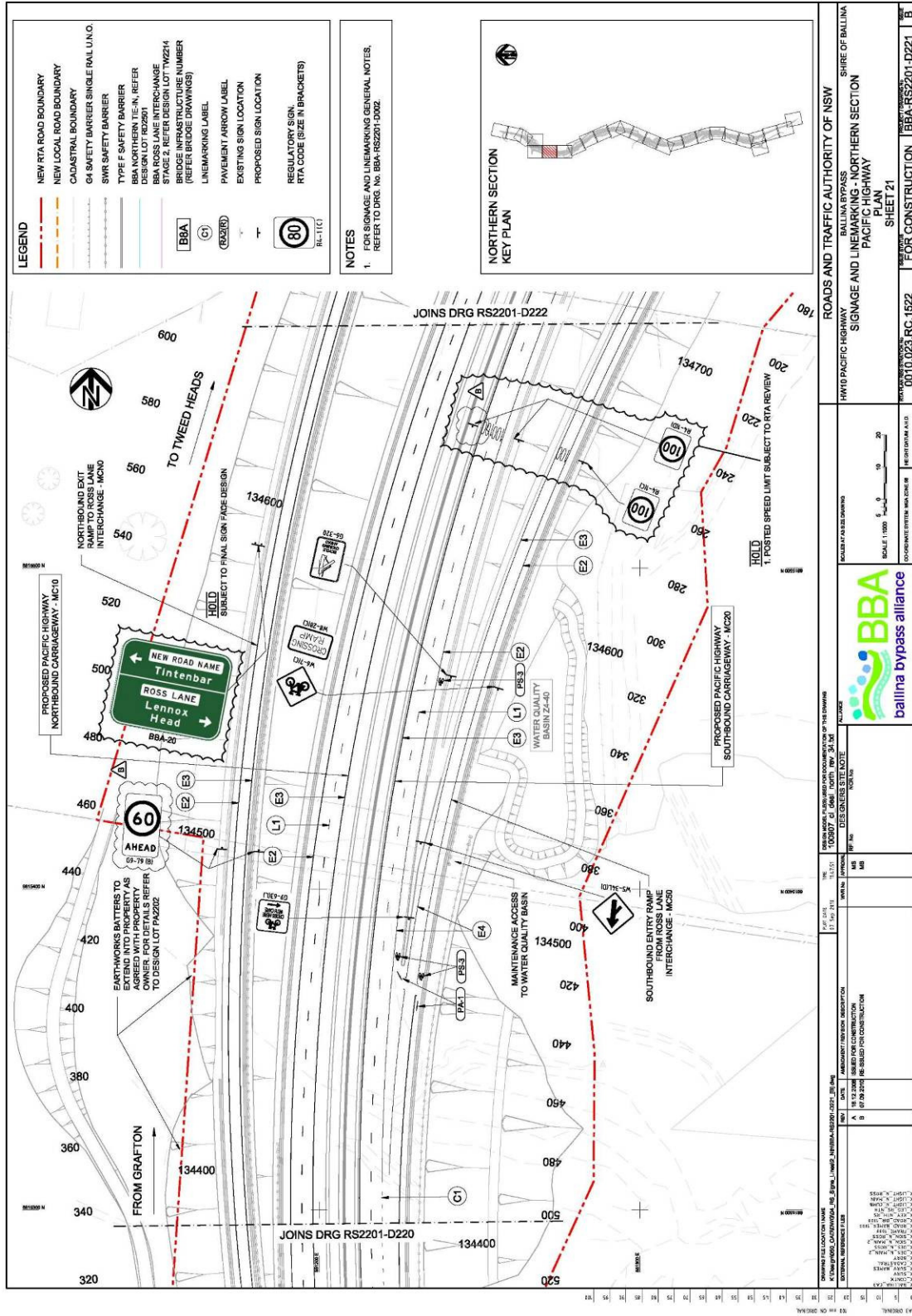

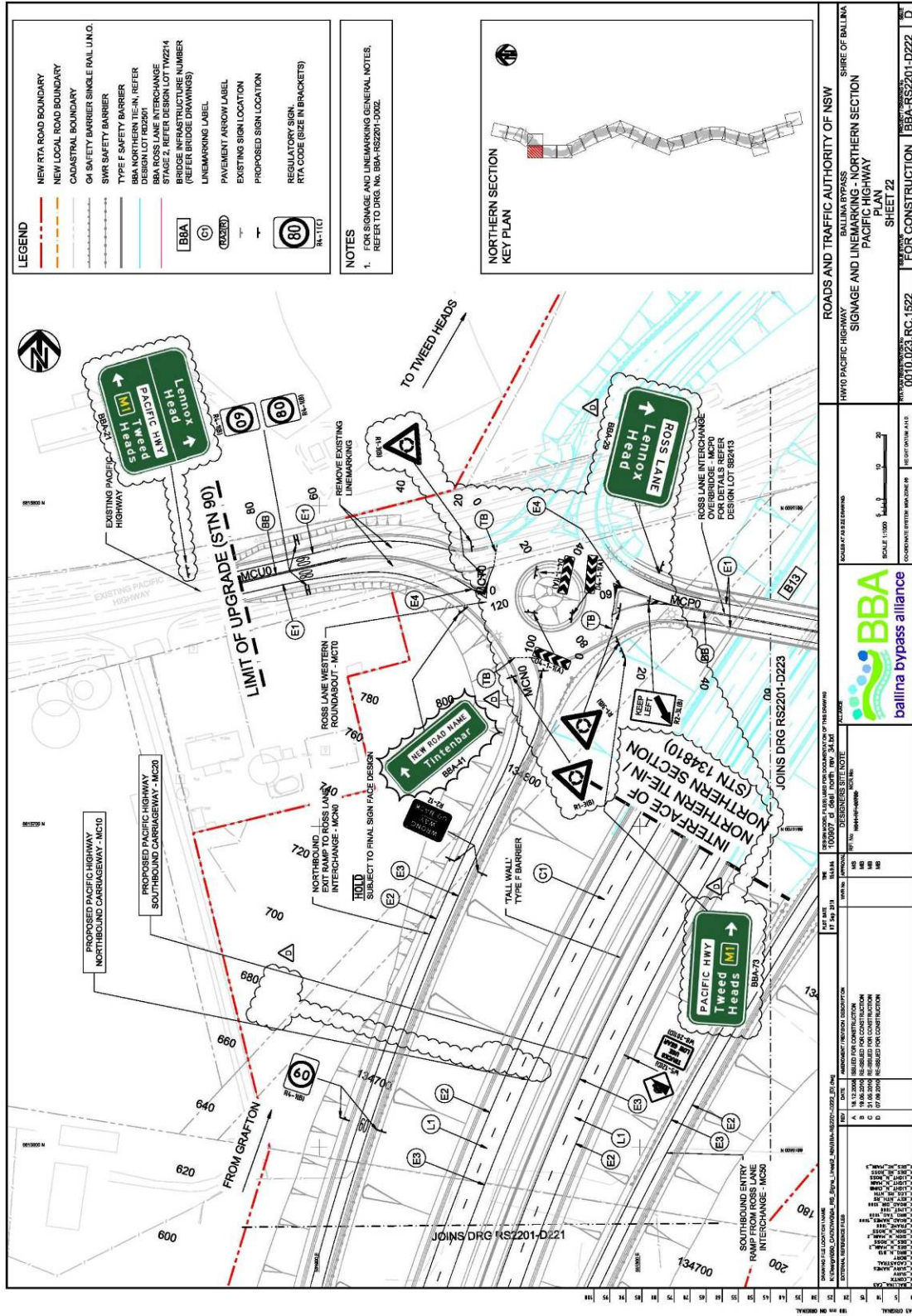

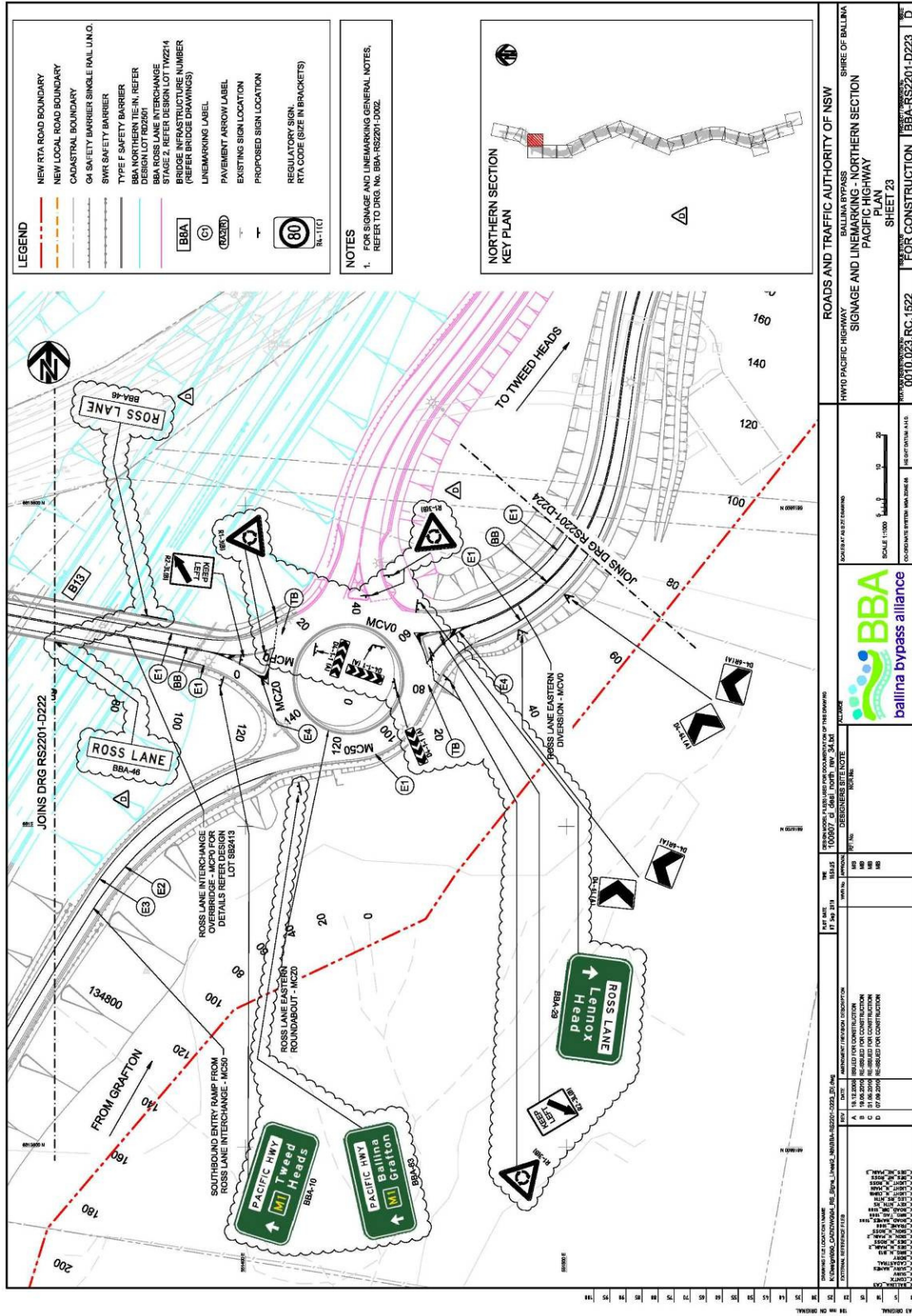

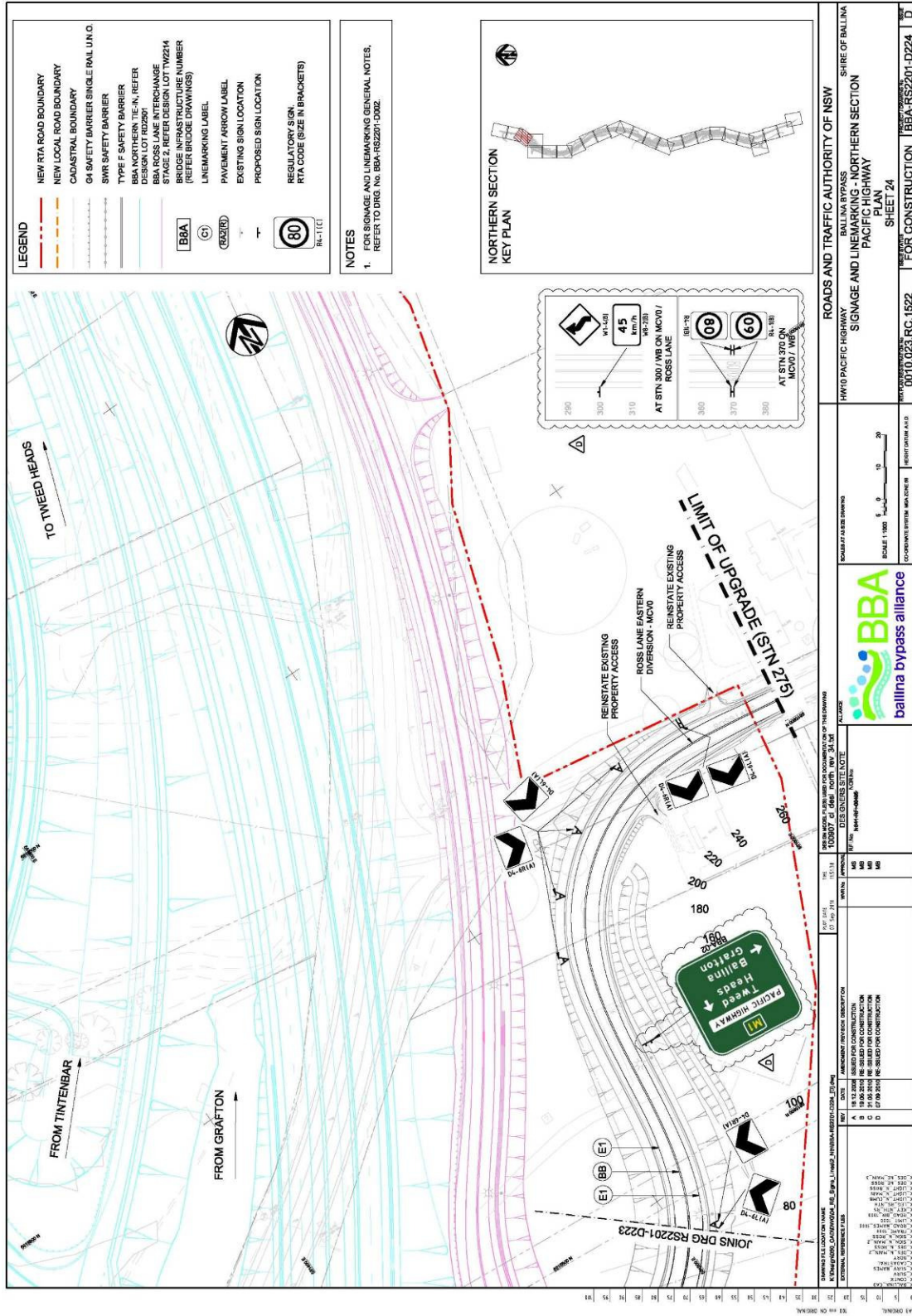

6. **Outstanding Business – 15 November 2010 meeting**

(a) Lennox Head Art Project

This matter has been included in the consultation process for the draft Lennox Foreshore Masterplan and will be resolved depending on the outcome of the consultation.

The Lennox Foreshore Master Plan was placed on public exhibition with the closing date 3 February 2011. The outcomes from the consultation process are scheduled to be reported to the March meeting of Council.

(b) Lake Ainsworth - Fish

Council's Environmental Health staff provided the following report.

**Introduced Fish in Lake Ainsworth.**

The Lake Ainsworth Management Plan deals with lake fauna at pp 54-55

The Ecology Lab as part of their contribution to the Lake Ainsworth Processes Study 1996 identified the ubiquitous mosquito fish (*Gambusia holbrooki*) being present during their field work.

Prior to the completion of the final plan of management for the lake, Council was informed of the capture of Australian Bass (*Macquaria novemaculeata*) in it. Whilst Bass are Australian native, they were not known in the Lake at the time of the Processes Study and are thought to be of very recent introduction.

In relation to strategies for Management of the ecology of the lake recommendations in relation to fauna (including fish) are as follows:

"The development and introduction of introduced species should be monitored and steps taken to eradicate them where practical. Whilst programs to eradicate or reduce the density of species such as the mosquito fish are unavailable at this time, research in this area should be monitored for possible future application".

The recommended management option has been: "to implement action plans to target specific species for their eradication."

Whilst it would be highly desirable to eliminate *Gambusia* from the lake (as it is understood to predate on microcrustacea that in turn predate on algae) there is no known way of selectively and/or affordably removing this species. It has been suggested that the introduction of bass might have helped reduce the *Gambusia* population because it predate on smaller fish, however, this fish needs to access saline water as part of its spawning cycle and if it cannot do so will probably not reproduce. It was not possible to undertake any studies to determine whether the *Gambusia* population reduced post introduction of Bass because the population has never been quantified.

Council has not pursued this management recommendation because without any method of control of the introduced fish, there would be no useful outcome or benefit flowing from the investment required.

Council staff are aware of the issue at the lake and if any knowledge or information comes to hand that suggests an ability to affordably eliminate or reduce populations of the noxious *Gambusia* species it will be investigated.

Eastern gambusia (<em>Gambusia holbrooki</em>) | NSW Department of Primary I... Page 1 of 2

### Eastern gambusia (*Gambusia holbrooki*)

Introduction

Impact on native fish

What can we do?

What is I&I NSW doing?

References and further reading



#### Introduction

Eastern gambusia (*Gambusia holbrooki* - also known as plague minnow, gambusia and mosquito fish) are native to North America. They were initially introduced into NSW waters sometime during the 1920s because of their reputation for mosquito control. However, since that time their ability to control mosquito larvae has been shown to be no greater than that of small native fish that feed on insects.

Eastern gambusia have spread widely throughout NSW and thrive in shallow low flowing waterbodies. They can tolerate a wide range of temperatures and water quality. Eastern gambusia breed several times a year throughout the warmer months. Eggs are fertilised inside the female and take 3 or 4 weeks to develop. About 50 young are born live and reach maturity in less than 2 months, which means populations of Eastern gambusia can grow rapidly.

Size: Females to about 60 mm, males to about 35 mm.

#### Impact on native fish

Eastern gambusia have been associated with the decline of abundance or range of 35 fish species worldwide, including Australian native species such as gudgeon, hardyheads and some rainbow fish.

#### Competition for food

Eastern gambusia feed on a wide variety of foods. They eat insects such as ants and flies as well as aquatic beetles, bugs and other fauna. Eastern gambusia, with their high reproductive rate and extended breeding season, may overwhelm suitable habitats with juveniles and deplete food supplies.

#### Competition

Competition occurs when Eastern gambusia deny other species access to a particular resource, generally through aggressive behaviour. This often involves chasing and fin nipping which can lead to secondary bacterial or fungal infections and potentially death of other fish.

#### Predation

Eastern gambusia are known to prey upon the eggs and juveniles of other fish species. They have also been linked to the decline of frog species, through the predation of tadpoles and adult frogs.

<http://www.dpi.nsw.gov.au/fisheries/pests-diseases/freshwater-pests/species/mosquito...> 08/11/2010

### What can we do?

Some well-established alien species are difficult to control. However, there are some options for their management and improving the odds for native fish.

#### Environmental management and rehabilitation

Management of issues such as water quality, environmental flows, fish passage and snags can maintain or return conditions to those that best suit native fish. This improves the ability of native fish to compete and creates conditions less suitable for alien species.

#### Restricting the spread

The spread of alien species has often been associated with their use as bait. For this reason, use of live fish bait is illegal in NSW. Improved education is also needed to avoid the accidental release of these species.

#### Biological control

Biological control utilises methods such as the introduction of a natural predator or parasite, manipulation of the immune system or genetic material and sterilisation to control or remove an unwanted species. These controls can be effective but are often technically difficult, expensive and require detailed testing to ensure that controls won't impact on other species.

#### Disease

Diseases such as viruses can effectively manage alien species. However, it can be difficult to find a species specific disease that will not affect other fish.

If you find what you believe is Eastern gambusia (or another species which you suspect is not native to the area), freeze it whole and [Report it!](#)

### What is I&I NSW doing?

I&I NSW has listed Eastern gambusia (*Gambusia holbrooki*) as noxious in NSW. Eastern gambusia is listed as a Class 1 noxious species outside the greater Sydney area which means it is illegal to sell or possess it, even in aquaria. In the greater Sydney region it is listed as a class 3 noxious species which allows for sale and possession in this region, however its sale and possession are discouraged. For more detail on the regions covered by this noxious listing, see the [noxious list](#).

### References and further reading

Harris, JH and Gehrke, PC (eds). 1997. *Fish and Rivers in Stress. The NSW Rivers Survey*. NSW Fisheries Office of Conservation and the Cooperative Research Centre for Freshwater Ecology in association with NSW Resource and Conservation Assessment Council.

Rowland, SJ and Ingram, BA. 1991. Diseases of Australian native freshwater fishes with particular emphasis on ectoparasitic and fungal diseases of Murray cod (*Macullochella peelii peelii*), golden perch (*Macquaria ambigua*) and silver perch (*Bidyanus bidyanus*). *Fisheries Bulletin* 4. NSW Fisheries.

Young, WJ. (eds) 2001. *Rivers as Ecological Systems: The Murray-Darling Basin*. Murray-Darling Basin Commission. Canberra.

[Privacy](#) | [Legal](#) | [Report a problem](#)  
© State of New South Wales, 2005 | [ServiceNSW](#)

<http://www.dpi.nsw.gov.au/fisheries/pests-diseases/freshwater-pests/species/mosquito...> 08/11/2010



## Australian Bass



Australian Bass

**Distribution** - Bass are found in fresh and saltwater, in eastern draining rivers from the Mary River in Queensland to the Gippsland Lakes in Victoria.

**Size** - Maximum of 4kg and 65cm in length.

**Characteristics** - Bass vary in colour from silver, green and bronze. The fish migrate downstream to the estuaries to breed between June and August and a fishing closure has been introduced at this time, to protect this species. Females are much larger than males. Adult fish are general purpose carnivores. The Bass has a back profile that is arched from above the eyes to the tail with only very slight tapering of the snout. They are sought after sport fish with bait, fly and artificial lure. Although considered excellent eating, the majority of fish are returned to the water unharmed.

**Confusing species** - Confused with the Estuary Perch (*Macquaria colonorum*) which has a longer tapered snout with a concave profile.

### Fishing rules

[Summary of freshwater fishing rules](#)

Response to item from meeting 15 November 2010

(c) Removal of non-native fish species from Lake Ainsworth

It was agreed that the preferred approach was to determine whether a designated fishing area could be provided in the lake to allow clear delineation between swimmers and fishing, thereby minimizing any risk of injury.

Actions on this subject identified in the Lake Ainsworth Estuary Management plan are dealt with in the report entitled "Introduced Fish in Lake Ainsworth"

In view of the fact that Communities NSW Sport and Recreation has care control and management of the northern end of the water body, consultation was undertaken with the Sport and Recreation Centre Manager John Mills.

He indicated that it was becoming common knowledge particularly with youngsters at Lennox Head that there was a population of red-claw yabbies, *Cherax quadricarinatus*, a native of north Queensland and the Northern Territory, now present in the lake and that traps set to catch them had caused problems when motor boats utilized by supervisors were fouled by rope associated with the traps. Centre staff have requested removal of the traps when those setting them are seen. He had also seen people in kayaks fishing for Australian Bass and occasionally groups of people fishing for and killing Bass. He has no problem with people fishing for Bass so long as they are re-released.

Complaints to Council about fishing activity are rare.

Advice received from Council's Rangers and Open Spaces and Reserves Management people do not suggest that fishing is a problem of significance in Lake Ainsworth. It would not be recommended that scarce resources be directed toward managing it at this time.

(d) Companion Animals Management Plan Signage

Council's Regulatory Services Group advise that the heath land near Camp Drew leading onto Seven Mile Beach is not currently designated as off leash in Council's Companion Animals Management Plan. However when the Plan is reviewed in August to September 2011 it will be proposed to allocate the car park and path leading to the beach as off leash. Submissions can be made at this time.

The existing signs will therefore remain in place.

(e) Earth Mound - Camp Drew Road

Actions from last meeting were:

1. General Manager to write to LPMA
2. Civil Services Group to assess merits of using the mound for fill and whether or not it could be offered for free.

The following response has been received from the LPMA (North Coast Holiday Parks):

*I refer to our recent discussion and your subsequent letter regarding the above matter and confirm that no action will be taken by North Coast Holiday Parks regarding the removal of the mound prior to the adoption of a Plan of Management for the park.*

*It should be noted that the mound was not placed there during the time North Coast Holiday Parks has controlled the caravan park and as such I can only assume that the works were done under approval of the council, in its previous role as Reserve Trust Manager. Without having access to accurate mapping, the mound appears to be located on the Council Road Reserve outside the boundary of the caravan park and, as such, the Council has the right to remove the mound at its discretion.*

*Without committing to the future expenditure of any funds, North Coast Holiday Parks will work with Council to seek to achieve a mutually beneficial outcome for both parties upon exhibition and subsequent adoption of the Plan of Management for the park.*

Council's Civil Services Group has also advised that they have no current use for the fill in the mound.

(f) Illegal removal of trees from Beachfront Parade, East Ballina

The letters for the clearing in Beachfront Parade were sent out in July 2010. There were 52 letters sent out to properties whose views may have been affected/improved by the unauthorised works. The extent of coverage of the correspondence for this particular matter went from Bayview Drive (Northern end) to Bellevue Avenue (southern end).

There was only one response from a person who moved in after the event to say that they had no knowledge of the event.

Information was also provided in the February 2011 Advocate Advertorial and will be included in the next edition of Community Connect, which is due out shortly.

(g) Ranger Beach Patrols - Use of Flashing Light

Council's Rangers regularly walk the Shire's beaches and at times carry out under cover patrols. The flashing lights on the Ranger vehicles are required to be on at times for occupational health and safety purposes.

(h) Update on Samson Lifting Post, Angels Beach

Council's Heritage Officer has this on her action list, however it is a relatively lower priority compared to many other tasks currently on hand. The next step will require a formal assessment as to the significance of the lifting posit.

(i) Al Fresco Dining Fees for Lennox Head

Councillors are discussing the proposed fees at a Finance Committee meeting scheduled for Thursday 17 March 2011. An update from that meeting will be provided to the Committee.

(j) Alternate Location for Lennox Markets

Council's Civil Services staff have provided the following report:

*Request for Update on Market Trial – Lennox Head*

A report was presented to the July 2009 Council meeting seeking endorsement to temporarily relocate the LH market to the Foreshore Park, Ballina Street because of the flooding of the market site.

The resolution to the report included a requirement for a report to be presented following the temporary relocation on the viability of permanently relocating the market to this site.

The follow up report was presented to the March 2010 Council meeting and Council resolved to defer consideration of the matter until a subsequent report was presented which was to include additional information on the use of the Camp Drew Road location that was previously used for the market.

A subsequent report was presented to the May 2010 meeting and this report included for consideration the old Camp Drew Road site.

All three sites – Williams Reserve, Foreshore Park and Camp Drew Road – have limitation and issues associated with their use and these issues all need to be considered at the 'time of need' when selecting an alternative site.

As a result of this report, Council resolved to provide the General Manager with delegated authority to temporarily relocate the Lennox Market if required to one of the three nominated sites.

The Council reports referred to are July 2009, March 2010 and May 2010.

There was no reference found in Council reports to the provision of a report on the Lake Ainsworth site or that this site was on trial, rather a report was required on the viability of the alternative market sites listed in this report.

*Mackney Lane – Alternative Market Site*

At the November 2010 B Ward Committee meeting a request was made for Council to investigate the possibility of using the Mackney Lane Precinct as an alternative location for the markets.

Reference is made to the Request for Update on Market Trial – Lennox Head report which provides background information on issues relating to the location of the Lennox Head Market more generally.

The Mackney Lane proposal (including the use of the Community Centre car park) requires the closure of Mackney Lane during markets. This will impact on residents who have access from their property via Mackney Lane. Currently this would affect 4 residential properties and 1 commercial property with rear access onto Mackney Lane.

The proximity of the residential properties to the market stalls would result in disturbance to the residents commencing early in the morning when the market sets up and then through the day until the market finishes around 2.00pm.

The removal of access and the impact of noise on the residents along Mackney Lane makes this site unsuitable for use as a market site. This assessment is based on the conditions and requirements set out in Council's Market Policy.

(k) Renaming of Camp Drewe Road

Council at its 16 December 2010 Ordinary meeting resolved to adopt Camp Drewe Road as the proposed name for the road north from Ross Street past Lake Ainsworth and Camp Drewe at Lennox Head.

(l) Newrybar Hall - Cleaning of public toilets

In response to this item the toilets have been inspected and given their poor condition it has been determined that the toilets need to be demolished. In response to a subsequent letter from Mr Ian Duncan on behalf of the Newryball Hall committee a budget bid has been made to the budget process of Council for the provision of a new public toilet and septic system at the rear of the hall.

Of concern to Council Officers who inspected the hall site and public toilets was their failure to be able to locate the septic tank that services the existing public toilets and the toilets and kitchen in the Newrybar Hall. The septic system may be located under the hall however access could not be gained to investigate.

On the basis of concerns regarding the existing septic system a second or alternate budget bid was made for funds to enable the investigation of the existing septic system and the provision of a new septic system to service the Hall's needs. This second bid did not include the construction of a public toilet.

As there are no public BBQ or picnic facilities in the village the immediate priority is considered to be the replacement of the septic system to ensure that the hall can continue to operate.

Visitors to Newrybar are able to use the facilities of the café or shops that they visit or other stops such as Bangalow or the Macadamia Castle.

At this point in time no funding for this work has been included in the Council's 2010/11 draft budget

(m) Car Parking to be provided - New Development

Development on the corner of Barrett Drive and Ian Avenue, Lennox Head.

Council's Regulatory Services staff advise that Etosha Homes lodged a development application with Council on 14 December 2010 for a residential flat development comprising 5 x 2 bedroom single storey dwellings. The subject application is currently undetermined.

The proposed development provides a total of 7 car parking spaces on site comprising one single garage space for each unit plus 2 visitor car parking spaces. The provision of 7 on-site car parking spaces is consistent with the requirements of Council's Development Control Plan.

Following receipt of additional information, the application was placed on public exhibition. No objection to the proposal was received during the public exhibition period. The assessment of the application is being finalised and determination is pending.

**7. Items raised by members of the Committee**

**Lennox Head Landcare**

- An update on plans to implement further stages of the Lake Ainsworth Master Plan with particular reference to permanently closing the eastern side of the lake to traffic and also to diverting traffic between Ross St. and Camp Drew Road.

Council staff advise as follows:

The LPMA is reviewing the plan of management for the park and it is understood that they are looking at this issue as part of the Regional Plan for Lennox Head. The draft plan of management for the park is expected to be completed by end of March. LPMA will determine the timing of exhibition.

Council has no funding set aside for the road works.

- Response to off lead dog sign at entry to heathland as per last minutes

Refer to Item 6 of this agenda

- Update on removal of Camp Drew Rd earth mound

Refer to Item 6 of this agenda

- Plans for toilets at Pat Morton Lookout and Iron Peg car park with regard to timing and type.

Council staff advise as follows:

The Ballina Coastal Reserve Plan of Management makes provision for the construction of a public toilet in the vicinity of the Pat Morton Lookout car park.

A Masterplan has been prepared and an approved DA exists for all works associated with the Masterplan including the construction of a public toilet.

A budget bid has been submitted for the construction of a public toilet at Pat Morton Lookout carpark for consideration in the budget preparation process for 2011/12. This will be discussed by Councillors at a Finance Committee meeting scheduled for Thursday 17 March 2011.

Should the funding be allocated then construction can commence in the next financial year.

There are no current plans to locate a public toilet at Iron Peg or as it is more commonly known, Boulder Beach. The provision of a toilet at Sharpes Beach which has a higher visitation rate is regarded as a higher priority.

Once the Pat Morton toilet is constructed then Sharpes Beach will be the next location that will be considered for works such as a public toilet, lifeguard facility, formalising of the carpark and beach access.

This work is subject to negotiations with the current owner of part of the land which is currently used to access the beach and accommodate car parking.

A budget bid would be submitted for consideration in the 2012/2013 financial year if agreement can be reached on the upgrading of the Sharpes Beach car park. Should grant funding become available, then the project may be able to be delivered earlier.

On the completion of upgrade works at Sharpes Beach the provision of facilities at Boulder Beach will be considered.

**Lennox Head Residents Association:**

- Equity in Fees and Charges

**8. Council Documents on Exhibition**

The following is a list of recent documents that have been placed on exhibition in the period since the last meeting.

- Draft Review Pesticide Notification Plan - closing date 6 January 2011
- Draft Review Pesticide Use Policy - closing date 6 January 2011
- Draft Review Interaction Between Councillors and Staff - closing date 20 January 2011
- Draft Cemetery Management Policy - closing date 20 January 2011

- Draft Flat Rock Tent Park Fees 2011/2012 - closing date 20 January 2011
- Final Draft - Lennox Foreshore Masterplan - closing date 3 February 2011
- Draft Vehicle Signs Policy - closing date 10 March 2011
- Draft Tender and Quotation Evaluations Policy - closing date 10 March 2011
- Draft Child Protection Policy - closing date 10 March 2011
- Draft Donations - Rates and Charges Policy - closing date 10 March 2011
- Draft Markets Policy- closing date 10 March 2011
- Draft Concealed Water Leaks Policy - closing date 31 March 2011
- Draft Financial Planning Policy - closing date 31 March 2011
- Lennox Head Community Centre Draft Fees - closing date 31 March 2011

**9. Other Business**

**10. Next Meeting**

Next meeting is scheduled for Monday, 16 May 2011 at 4.30 p.m.