

1. Attendance and Apologies

Cr David Wright (Chair)
Cr Ben Smith
Cr Keith Johnson
Cr Phillip Silver, Mayor
Les Wiles - Alstonville/Wollongbar Chamber of Commerce
Richard Lutze - Combined Services Club
Bob Cooper - Far North Coast Legacy/Probus
Malcolm Johnson - Ballina Environment Society
Brian Hill - Tuckombil Landcare & Alstonville RSL
Peter Swain - Alstonville Rotary Club
Pat Carney - Wardell Progress Association
Eoin Johnston - Rous Mill Ratepayers (now representing in place of Steve Miller)
Barry Jeffress, Tuckombil Landcare
Jane Gardiner - Alstonville Plateau Historical Society
Geoff Limbert – Alstonville Ratepayers Association

Staff in Attendance

John Truman
Jillian Pratten

Apologies

Sheila Aveling - Tintenbar School of Arts
Allan Hart, Rotary Club of Ballina on Richmond
Elva Fitzell - Alstonville Rotary Club

2. Declarations of Interest

Phil Silver – non pecuniary – Item 7 – Owns property in Alstonville CBD

3. Confirmation of Minutes – 12 May 2011

That the minutes of the previous meeting held on 12 May 2011 be accepted as a true and correct record.

4. Business arising from Minutes – 12 May 2011

(a) Alstonville Playgroup Hall

The meeting was advised that a report on the request from the Alstonville Preschool group for assistance in establishing a preschool in Alstonville will be presented to the July 2011 Council Meeting.

The report will be seeking direction from Councillors to enable the staff to respond to the request.

5. Alstonville Main Street Upgrade - Update

Current night work involves relocating services and work is progressing well and dependant on continuing dry weather.

Anticipated finish date is late October 2011.

6. Elizabeth Ann Brown Park Masterplan

In response to a discussion regarding options to advance a review of the Masterplan and to develop design details for the plan the meeting recommended that Council convene a sub committee.

The sub committee membership is open to members of the Committee and some members expressed their interest in contributing to the committee.

Representatives in the group would include:

- RSL
- Service Clubs
- Village Green Group – Bob Cooper
- Chamber of Commerce
- Councillors and staff
- Landscape Architect

Jillian Pratten will convene the first meeting and will invite a landscape architect to advise the meeting.

The Alstonville RSL Sub-Branch provided a written submission to the meeting and requested that it be received on record. Mr Cooper also provided a submission. Both of these submissions are attached to the minutes.

7. Alstonville Carparking

A report was presented to the meeting by John Truman. Member organisations were encouraged to provide feedback to John to allow further development of the paper.

7. Council Documents on Exhibition

The Committee noted the list of documents recently exhibited by Council.

8. General Business

- John Truman agreed to continue to monitor the road crossing between Freeborn Park and EA Brown Park.
- A request was made for acknowledgment of donations that were made by the service clubs for the construction of the BBQ in EA Brown Park. Jillian Pratten to action.

- Pat Carney made a request in relation the following items:
 - signage at the wharf to direct people to the new BBQ.
 - Seating in the middle of the road reserve in Sinclair Street, Wardell adjacent to the wharf.
 - Requested information on the construction of the pontoon on the wharf. Was advised that tenders had closed and construction of the pontoon would occur in the coming months.

John Truman agreed to provide a response.

- Service Clubs Signage. A request was made to refurbish the service club signage at the entry to Alstonville as it is in poor condition. The meeting was advised that Council no longer supported the placement of this type of signage and that information signs were to be installed in the CBD of the villages to provide access to such information. In the mean time no work or replacement would be approved for the existing sign.
- Rous Tennis Court. There is an existing tennis court located on a Crown Reserve which is managed by a community Trust in Rous. Eoin Johnston advised that there had been some damage to a building adjacent to the court and asked how funding could be sourced from Council to assist in refurbishments.

Advice was provided on the community donations program that Council has and also Sport and Recreation grants that were available for such work.

- Lumley Park. Reference was made to the poor condition of the shed in Lumley Park in which the old equipment is located. The meeting commented that there was some doubt or lack of information on the ownership of the artefacts. It was agreed that Jillian Pratten would review and report back to the next meeting.

9. Items raised by members of the Committee

Nil

10. Next Meeting

The next meeting is scheduled to be held on Thursday, 15 September 2011 at 7.30 pm

MEETING CLOSURE

9.00 pm

**Elizabeth Ann Brown Park Refurbishment
Alstonville RSL sub-Branch Submission to Ward 'C' Committee**

The primary focus of the RSL sub-Branch is the erection of a fitting memorial to servicemen and women who gave their lives or suffered as a consequence of their service to the Nation.

Background

The sub-Branch was invited to furnish plans for a new memorial as part of the refurbishment of Elizabeth Brown Park. We saw this as an opportunity to improve the aesthetics and functionality of the cenotaph and to enable the honour roles incorporated in the current structure to be restored to the showground gates from whence they came. A sub-Committee of the Alstonville RSL sub-Branch met with Richard Lutze to discuss our brief for a memorial. Our concept was a bit woolly but Richard's expertise and understanding of the brief is reflected in the attached drawings. We congratulate Richard on his design.

Richard has designed not only a fitting memorial but a community space sympathetic to its park setting. It will enhance the Park – indeed, it would enhance any setting.

Our concept and Richard's translation invites the community to the memorial as opposed to the current cenotaph which is inaccessible to the disabled in any conditions and, in wet conditions, inaccessible to all. The proposed memorial will attract not only those seeking a place for quiet reflection but will serve the Community as the focal point on the occasions of ANZAC Day and Remembrance Day.

Community involvement

ANZAC Day in Alstonville is a remarkable event, generously supported by the community in general and particularly our local schools. This year thousands attended the main service and in excess of four hundred attended the dawn service. Importantly, the bond which has been formed between local school students and veterans is something members of the sub-Branch cherish. Several young people who assisted the sub-Branch as students have returned as volunteers after they have left school. The impact of this confluence of generations has a continuing effect throughout the year generating greater understanding and mutual respect between the youth of Alstonville and veterans and enriches the lives of both groups and the fabric of local society.

The Cenotaph is the focal point of our commemoration services and we are committed to ensuring that our Servicemen and women are given a worthy memorial.

The relationship of the Memorial to the broader plan for EAB Park

We note the submission of the EAB Community Plan Committee sees the Park having 3 precincts:

- The family playground
- The War Memorial precinct, and
- The Village Green.

Of the War memorial precinct, that submission says 'this is of special interest to all ex-service organisation (sic) and this development should be coordinated by the Alstonville RSL'. We, however, regard the memorial as a community asset and welcome input from the broader community.

We further submit that an holistic approach should be taken to the design of the park. We don't see the community amenity and the memorial as incompatible.

Access

We regard the provision of all-weather disabled access to the memorial as essential to the park design. Currently the park becomes a quagmire after rain events and presents difficulty for those attempting to access the memorial by wheel chairs and walking aids regardless of the weather conditions. We believe that with minimal impact on the green space, which will remain a feature of the park, appropriate access can be provided. The proposed memorial will incorporate memorial plaques currently fixed to the garden edges. These plaques when mounted adjacent to the memorial will attract members of the public wishing to pay their tributes to deceased relatives and friends whose names are commemorated by plaques.

Elizabeth Ann Brown

As we know Elizabeth Ann Brown Park was named after the daughter of Charles Bulwinkle an early pioneer of Alstonville. The sub-Branch has contacted a number of close relatives of Elizabeth Brown, namely, Mr Barton Bulwinkle, his son Kim, nephew Simon and her grandniece, Mrs Royalene Zoch of Brisbane, the daughter of Wallace Brown formerly of Ellis Road. The point of contacting these members of the Bulwinkle family was to establish whether the family have any views on the presence of the Memorial in Elizabeth Ann Brown Park. Those family members contacted were enthusiastic about the development including the proposal for a new memorial within the park precincts. Each asked that they be remembered should there be a rededication of the park in due course.

Ms Zoch visited Alstonville recently and was disappointed that the sign naming Elizabeth Ann Brown Park was missing. That will no doubt be remedied in the refurbishment but it does open another item for consideration.

Community and Memorial Axes

The imperative for disabled access and the juxtaposition of the memorial and the community facility is reflected in the park design submitted by the RSL sub-Branch. We see the complementarity of these dual purposes being achieved by the name Elizabeth Ann Brown Park being placed on a low wall at the entrance north eastern corner of the park and the north western entrance off the corner of Daley Street and Wardell Road inscribed 'Lest We Forget'. This entrance would be approximately where the ANZAC Day march enters the park and would greatly enhance the impact of the memorial when entering the park from that direction. We would use that path to the memorial for the wreathlaying part of our commemoration services. School children would be seated either side of the path on those occasions.

The proposed design of the memorial accommodates a pedestrian thoroughfare from the west down Daley Street and from the rear of the Federal Hotel through to the Plaza via the 'memorial axis' and pedestrian traffic from Freeborn Park to the community facilities via the 'community axis'.

The Australian National Flag

The redesign of the Park presents an opportunity for Council to install a flag pole in a central location from which the Australian National Flag can be flown. Currently the village does not have a facility to fly the Australian National Flag in a prominent position and to publicly acknowledge the passing of significant individuals.

The RSL sub-Branch would be responsible for the observance of flag protocol with the flag being lowered to the half-mast position as a sign of mourning. Directions from the Australian Government or the State Government would be directed to the sub-Branch who would ensure that the directions were followed. Under the flags protocol issued by the Prime Minister's Department the death of a prominent local citizen can be observed in this way. We suggest that a small stand erected adjacent to the flag pole would advise the public of the life being commemorated by the lowering of the flag. This again would be managed by the sub-Branch.

We believe the intersection of the Community and Memorial Axes to be the ideal location of a single flag pole from which the Australian National Flag would be flown.

Preserving the green space for the community

We understand the proposed plans will see the existing gardens removed increasing significantly the 'green area' available to the public. By the provision of paths tiled in the style of the main street, access to the park and the memorial will not be denied to the disabled. The RSL sub-Branch treasures the green space provided by the park but recognises that a park without proper access for all members of the community is not acceptable.

We do not consider the provision of all-weather disabled access to the park as being incompatible with the objective of retaining green space for the community.

We commend to the Committee the enclosed design for the memorial and the plans for the park as submitted by the Alstonville RSL sub-Branch.

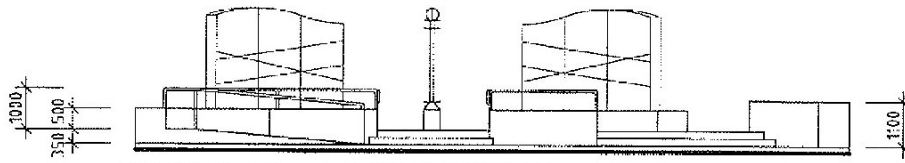

ELEVATION - RAISED PODIUM

DESIGN 2
DATE 25/06/11

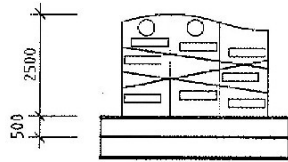

MEMORIAL WALL DETAILS

DESIGN 1
DATE 23/06/11

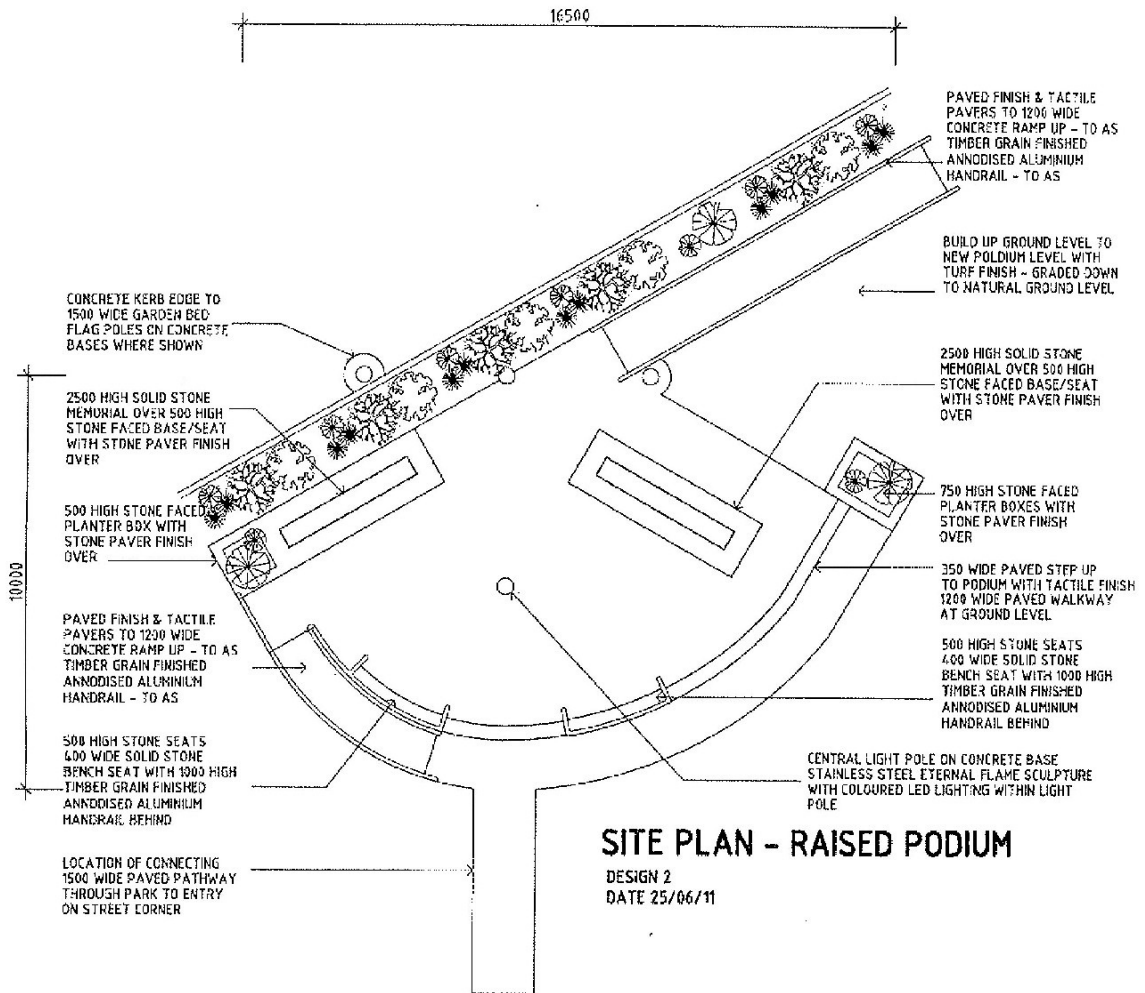

SITE PLAN - RAISED PODIUM

DESIGN 2
DATE 25/06/11

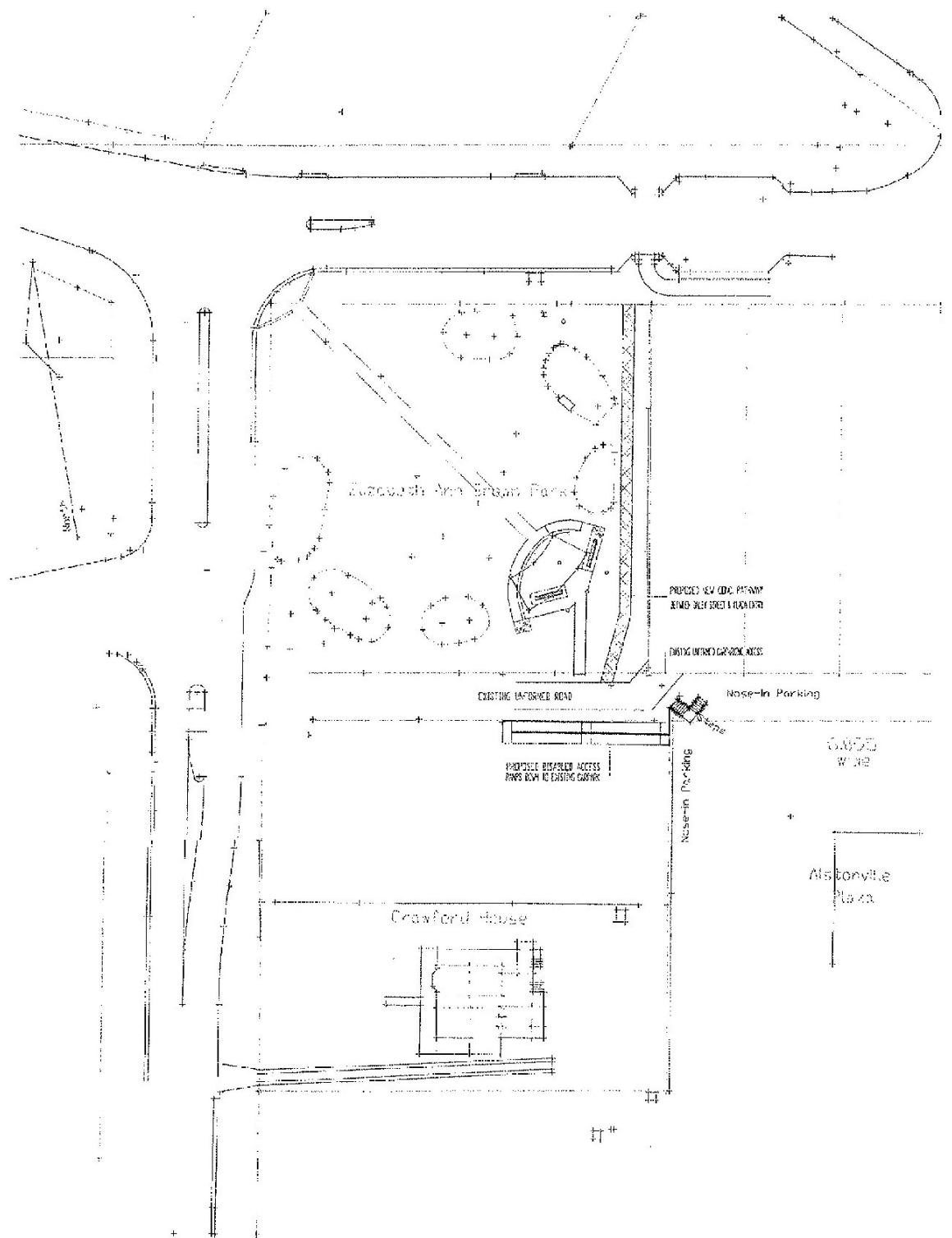

*Submission from
Mr. Bob Cooper*

Daley Street

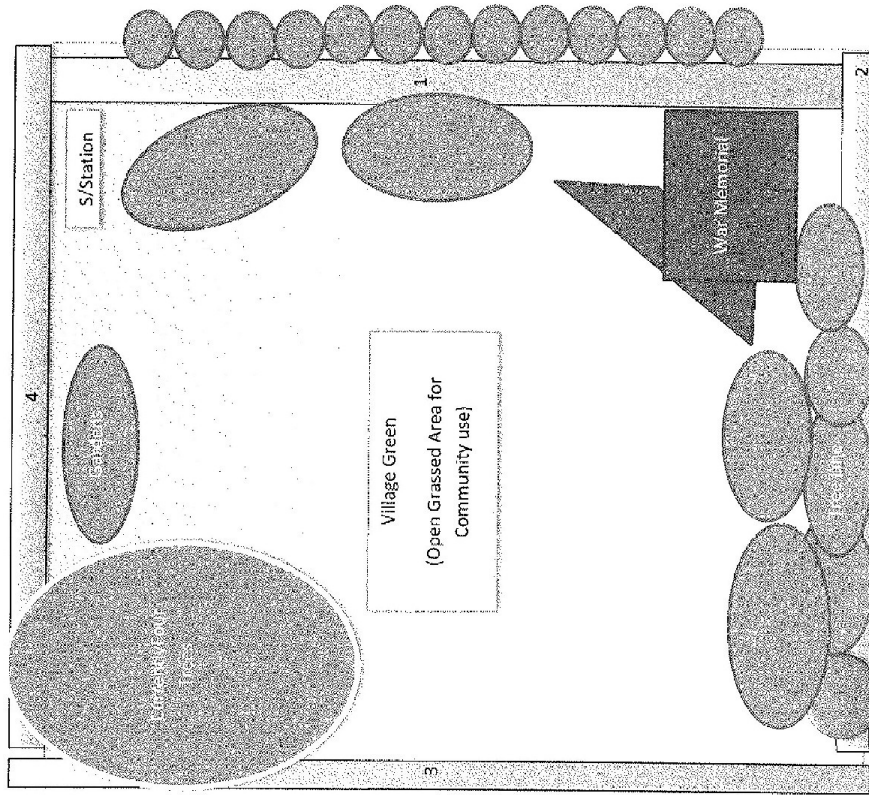

EAB Redevelopment Community Plan 3

- A. **Concept.** EAB Park is a Community Park which contains the War memorial. The Park consists of three precincts:
- The Family Playground/BBQ precinct
 - The War Memorial precinct, and
 - The Village Green.
- B. The Family Playground/BBQ precinct is well established and valued as is.
- C. The War memorial precinct is of interest to Ex-Services Organisation and this redevelopment, within the bounds of the current footprint, should be coordinated by the Alstonville RSL.
- D. **Other Development Requirements.** There is a need to provide paved surfaces to allow disabled persons and pedestrian traffic to access the Park north to south and east to west. This paving should provide access to the war memorial precinct. Paving 1 & 2 are considered essential. 3 & 4 are external to the park.
- E. The **Village Green** is to remain as an open park with extensive and uninterrupted grass surfaces. The only redevelopment actions required here, apart from essential maintenance, are:
- The possible removal of one of the trees in the north-western corner of the Park subject to arborist advice
 - The removal and replacement of diseased/old trees on the southern boundary of the park (on arborist advice)
 - The rejuvenation of the current vegetation beds and the inclusion in these of low profile bird attracting native trees/shrubs.
 - A possible concrete apron adjacent to but not forward of the memorial
- F. **This proposal is simple, cost effective and protects the natural characteristics of the Village Green which is of demonstrated practical and emotional value to the Plateau Community**