



Feedback for Documents on Exhibition

1. Name of exhibited document you want to make comment on:

Draft - East Ballina Cemetery.

2. Your name (anonymous submissions may be disregarded by Council):

Margaret Fryer 2 Suvla Street, East Ballina

3. Phone number (optional):

6686 9370.

4. Email (confirmation of your email address is required to provide feedback from Council):

margaretfryer@bigpond.com

Please note: Your feedback will be treated by Council as a public document and may be printed in our meeting agendas and made available to the public. If you want your feedback to remain confidential you must provide reasons in the comment box at the end of this survey.

5. Having read the document, is it easy to read and understand?

Yes

No

6. Please provide any suggestions for improvement (please add extra pages if required):

I have shown an interest in the cemetery since 1980 when I went to Kevin Geaghen suggesting niche walls. Having lost a daughter in Sydney I was interested in bringing her ashes up here. In the 30 years we have lived here I have felt there has never been any vision. Build a wall then another. It was going to be like the great wall not a lot of planning. It wasn't as I envisaged when making the suggestion.

7. Do you support the overall objectives and content of the document?

Yes

No

8. Please provide further comments if you wish (please add extra pages if required):

1. Roadworks be asphalt not concrete.
 2. Definitely no single unisex toilet facility.
 3. Leave table & shelter as is. No memorial tree.
 4. Colourful gardens! There has been two pot plants on top of walls never any plants in.
 5. Please keep ^{main} entrance at (2) away from existing houses.
 6. Please don't continue niche walls (6) up hill for the great wall effect.
 - (7) - Is the area I felt should have been utilised more. Plaques with ashes spread in the earth.
 9. Please not tuckeross but trees in keeping - Pine &
9. If you wish your feedback to remain confidential please provide reasons for this: cypress & trees

What is the expected lifespan of the cemetery? How much vegetation will be removed and for how long.

You can return your feedback form by:

- using prepaid envelope supplied in this folder;
- mail to PO Box 450, BALLINA, NSW, 2478;
- deliver in person to Ballina Shire Council, Corner of Cherry & Tamar Streets, Ballina;
- or provide feedback on Council's website - www.ballina.nsw.gov.au - under documents on exhibition.



Feedback for Documents on Exhibition

1. Name of exhibited document you want to make comment on:

East Ballina Cemetery Concept Master Plan

2. Your name (anonymous submissions may be disregarded by Council):

Mrs Gwen Waterford 55 Vica st Ballina

3. Phone number (optional):

02 6686 2743

4. Email (confirmation of your email address is required to provide feedback from Council):

n/a

Please note: Your feedback will be treated by Council as a public document and may be printed in our meeting agendas and made available to the public. If you want your feedback to remain confidential you must provide reasons in the comment box at the end of this survey.

5. Having read the document, is it easy to read and understand?

Yes

No

6. Please provide any suggestions for improvement (please add extra pages if required):

*I live opposite the site & see much on one
needy projects around Ballina. I commend
the Council for keeping the cemetery tidy & neat
but feel that maintaining gardens etc will add
greatly to the continuing cost.*

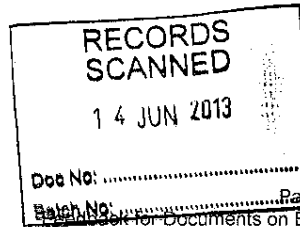

7. Do you support the overall objectives and content of the document?

Yes

No

8. Please provide further comments if you wish (please add extra pages if required):

The British Lake provides a pleasant Picnic spot for small family groups - excellent views & parking after visiting graves & low visitors passing through - Why remove it? Unisex toilets will encourage more overnight camping - also standard & more. Stone retaining walls lead to National Beauty, while brick or rendered will require more maintenance cost. Sharely with Council struggling with roads street maintenance,

9. If you wish your feedback to remain confidential please provide reasons for this:

No Problem

You can return your feedback form by:

- using prepaid envelope supplied in this folder;
- mail to PO Box 450, BALLINA, NSW, 2478;
- deliver in person to Ballina Shire Council, Corner of Cherry & Tamar Streets, Ballina;
- or provide feedback on Council's website - www.ballina.nsw.gov.au - under documents on exhibition.

DRAFT

This is a conceptual master plan that provides a strategy for the future works at the East Ballina Cemetery. The strategy and proposals contained herein are subject to change and detailed design. This document is *not* suitable for construction purposes.

Project Title
**East Ballina Cemetery
Concept Master Plan**

design team ink
landscape architecture urban design
© PO Box 1473 Ballina NSW 2478
T 02 8628 8494 M 0422 259 286
sheryn@designteamink.com

Designed	SDR
Date	01.03.13
Sheet	1 of 7
Scale	as shown



11.2 East Ballina Cemetery - Concept Master Plan.DOC

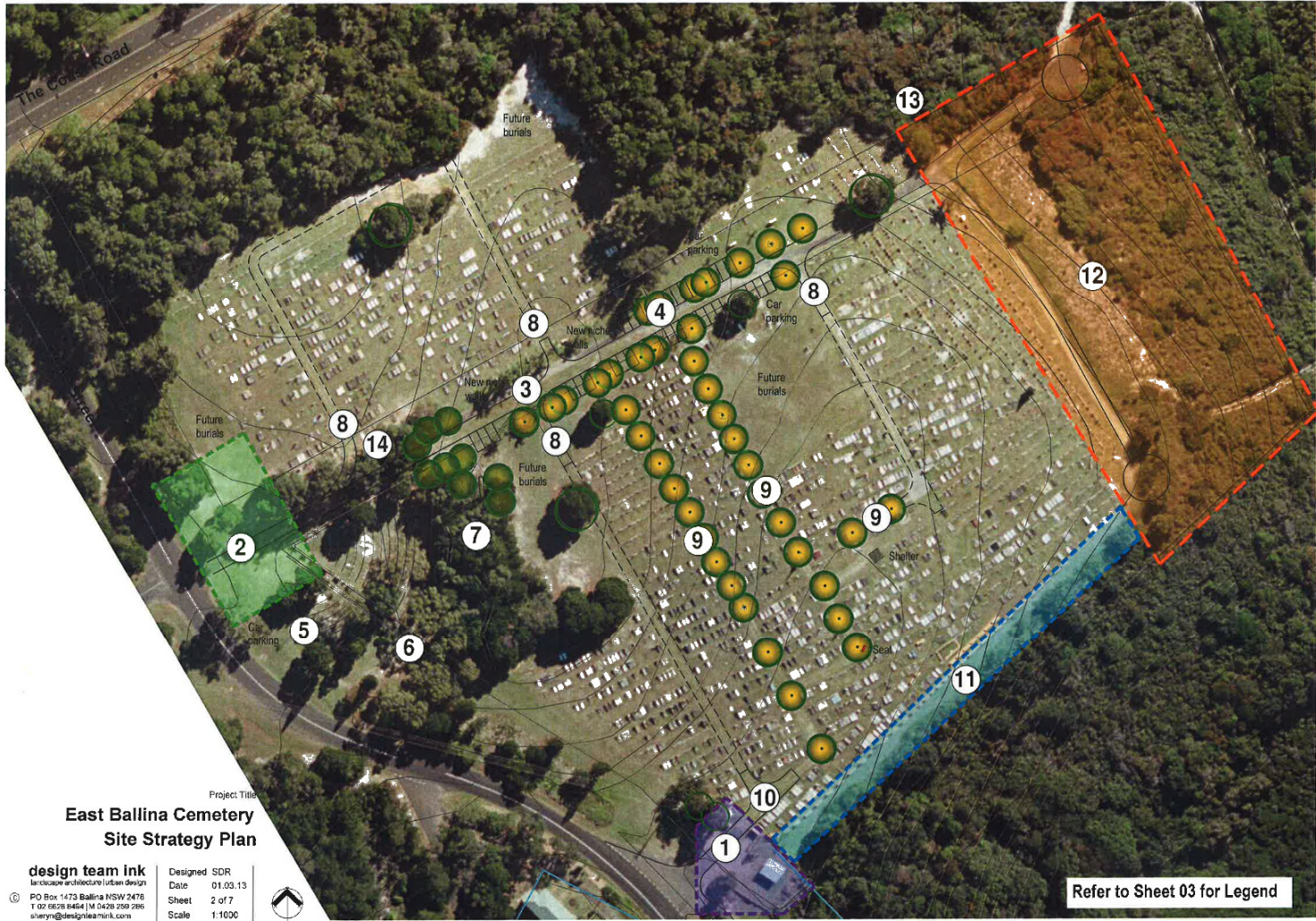

Project Title
**East Ballina Cemetery
 Site Strategy Plan**

design team ink
 landscape architecture | urban design
 PO Box 1473 Ballina NSW 2476
 T 02 6628 9464 | M 0428 205 296
 sheryn@designiteink.com

Designed SDR
 Date 01.03.13
 Sheet 2 of 7
 Scale 1:1000

Refer to Sheet 03 for Legend

This is a conceptual master plan that provides a strategy for the future works at the East Ballina Cemetery. The strategy and proposals contained herein are subject to change and detailed design. This document is not suitable for construction purposes.











Aerial photography and GIS layers provided by Ballina Shire Council. Boundaries and contours are approximate only.

11.2 **East Ballina Cemetery - Concept Master Plan.DOC**

PLAN LEGEND

- ① — Entrance Precinct 1
Refer to detailed design
- ② — Entrance Precinct 2
Refer to detailed design
- ③ — Realign and resurface entrance road to parallel with memorial walls. Install bollards either side of access driveway allowing for nose-in car parking areas and tree planting on alignment of existing Tuckeroos.
- ④ — Avenue of *Cupaniopsis anacardioides* (Tuckeroo)
- ⑤ — Expand RSL burial / memorial area using the same cross memorials based on the concentric arc configuration
- ⑥ — Extend niche wall row and construct additional row of niche walls parallel
- ⑦ — Undertake weed control and vegetation regeneration. Construct a memorial boardwalk and interpretative signage trail throughout the bushland area.
- ⑧ — Construct asphalt driveway nib and maintain grass vehicular access track thereafter.
- ⑨ — Decommission existing access tracks. Use track space for tree planting of *Cupaniopsis anacardioides* (Tuckeroo)
- ⑩ — Resurface asphalt access driveway and install bollards around turning area
- ⑪ — Existing niche wall area - Refer to detailed design
- ⑫ — New memorial and niche wall terraces, access road and bushland memorialisation area
Refer to detailed design
- ⑬ — Remove weeds and convert to future burial area
- ⑭ — Plant steep embankment under Coast Cypress trees with native groundcovers and convert to garden area. Plant additional Coast Cypress trees either side of road.

GRAPHICAL LEGEND

-  Existing significant tree
-  *Callitris columellaris* (Coast Cypress)
-  *Cupaniopsis anacardioides* (Tuckeroo)
-  *Banksia integrifolia* (Coast banksia)
-  Seat orientated towards view
-  Small shelter structure orientated towards view
-  Entrance Precinct 1 - Refer to Detailed Design on Sheet 04
-  Entrance Precinct 2 - Refer to Detailed Design on Sheet 05
-  Existing niche wall area - Refer to Detailed Design on Sheet 06
-  New memorial and niche wall terraces - Refer to Detailed Design on Sheet 07

Project Title

**East Ballina Cemetery
Site Strategy Legend / Notes**

<p>design team ink landscape architectural urban design</p> <p>© PO Box 1473 Ballina NSW 2478 T 02 6628 9404 M 0428 295 288 sheryn@designteamink.com</p>	Designed SDR
	Date 01.03.13
	Sheet 3 of 7
	Scale NTS

This is a conceptual master plan that provides a strategy for the future works at the East Ballina Cemetery. The strategy and proposals contained herein are subject to change and detailed design. This document is not suitable for construction purposes.

11.2 **East Ballina Cemetery - Concept Master Plan.DOC**



LEGEND

Existing

- Contours (0.2m intervals) supplied by Ballina Shire Council 2012
- Existing vegetated area

Proposed

- Pathway
- Garden area
- Grass
- Wall (retaining or entrance)
- Approximate design level (subject to detailed design)

Retain existing entrance walls and construct new wall to incorporate regulatory and information signage. Refer to Entrance Wall Schematic Elevation.
Colourful gardens around entrance walls

Single unisex toilet facility

Pathway (1.5m wide)

Bushland regeneration area (undertake weed removal and an assisted regeneration program)

Feature tree with memorial garden surround

Remove existing picnic shelter

Memorial garden with small feature trees or shrubs

New retaining wall (max 600mm high)

Remove existing retaining wall and reconstruct new retaining wall in arc configuration

Entrance Precinct 1
1:200

Remove array of individual post top signs and construct signage panel for new wall that includes all regulatory and informative signage messages.

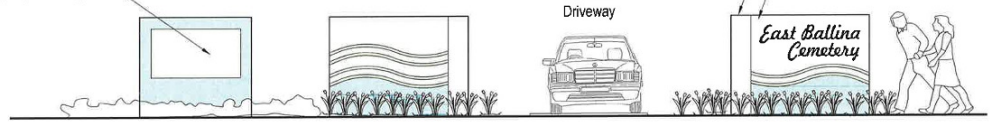

Entrance Walls (Schematic Elevation)
Not to Scale

Project Title
East Ballina Cemetery
Concept Master Plan Details

design team ink
1473 Ballina NSW 2478
PO Box 1473 Ballina NSW 2478
T 02 6628 6494 | M 0428 256 290
sheryn@designteamink.com

Designed SDR
Date 01.03.13
Sheet 4 of 7
Scale 1:200

This is a conceptual master plan that provides a strategy for the future works at the East Ballina Cemetery. The strategy and proposals contained herein are subject to change and detailed design. This document is not suitable for construction purposes.

Detail survey was provided by Ballina Shire Council.

11.2 **East Ballina Cemetery - Concept Master Plan.DOC**



- LEGEND**
- Existing**
 - Contours (0.2m intervals) supplied by Ballina Shire Council 2012
 - Existing vegetated area
 - Proposed**
 - Garden area
 - Grass
 - Wall (retaining or entrance)

Project Title
East Ballina Cemetery
Concept Master Plan Details

design team ink
 landscape | architecture | urban design
 P O Box 1473 Ballina NSW 2478
 T 02 6628 6494 | M 0429 250 286
 ebery@designink.com.au

Designed SDR
 Date 01.03.13
 Sheet 5 of 7
 Scale 1:200

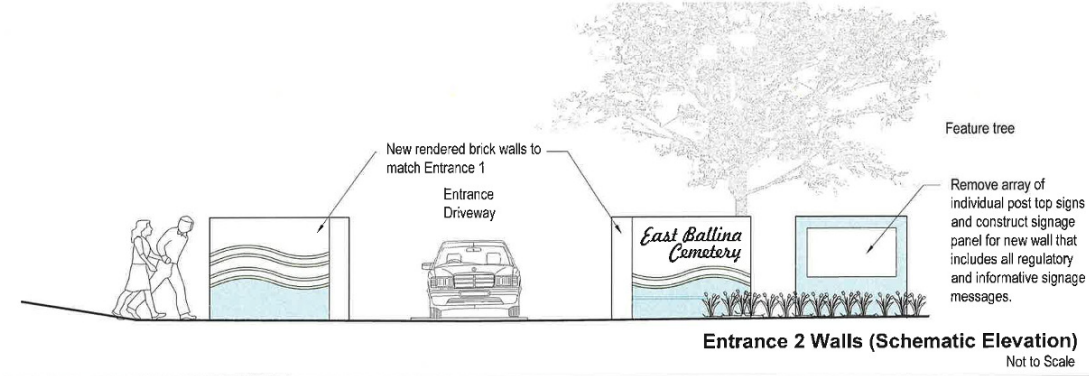

Detail survey was provided by Ballina Shire Council.

This is a conceptual master plan that provides a strategy for the future works at the East Ballina Cemetery. The strategy and proposals contained herein are subject to change and detailed design. This document is not suitable for construction purposes.

11.2 East Ballina Cemetery - Concept Master Plan.DOC

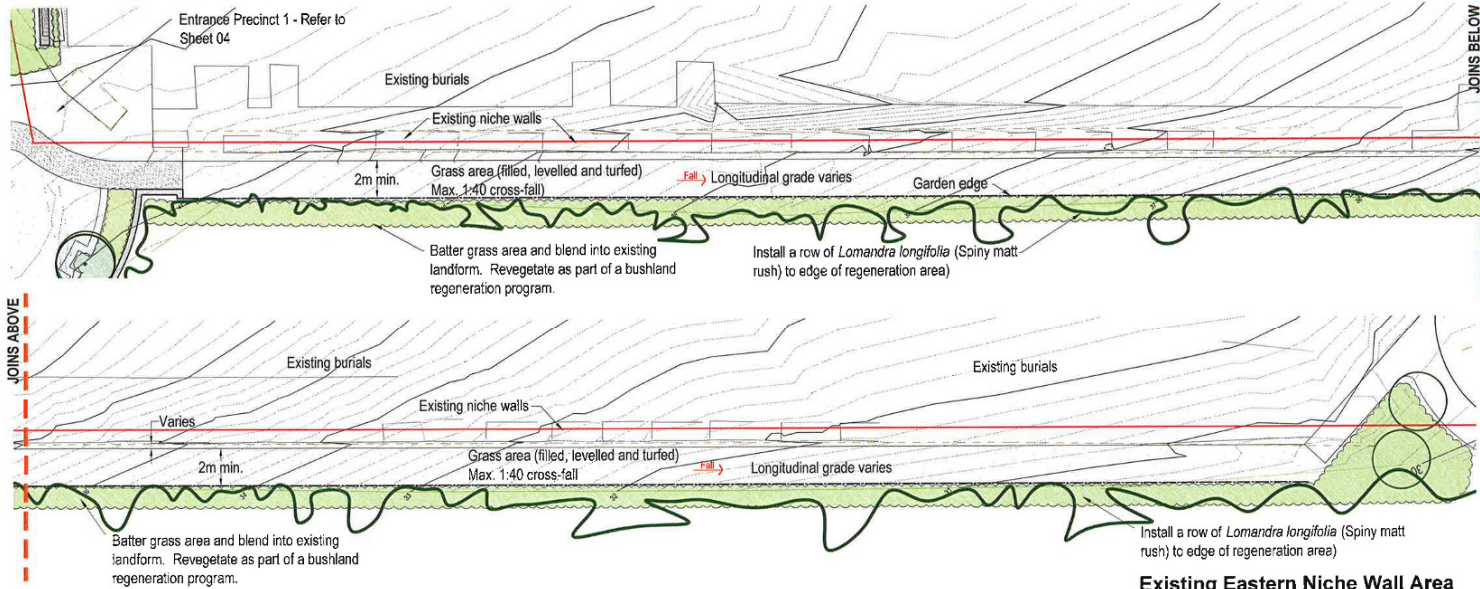

Existing Eastern Niche Wall Area

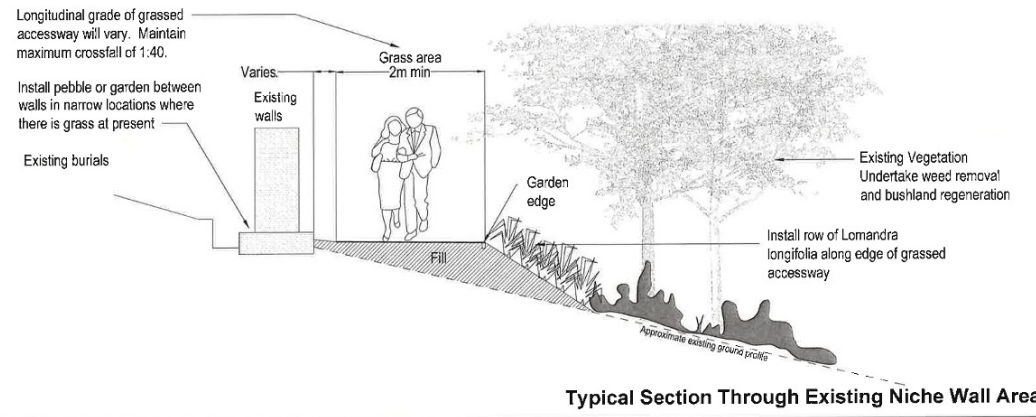

Typical Section Through Existing Niche Wall Area

Detail survey was provided by Ballina Shire Council.

This is a conceptual master plan that provides a strategy for the future works at the East Ballina Cemetery. The strategy and proposals contained herein are subject to change and detailed design. This document is not suitable for construction purposes.

Project Title
East Ballina Cemetery
Concept Master Plan Details

design team ink
 landscape architecture | urban design
 PO Box 1473 Ballina NSW 2478
 T 02 6620 9696 | F 02 6620 2965
 sheryn@designteamink.com

Designed SDR
 Date 01.03.13
 Sheet 6 of 7
 Scale Plan 1:200

11.2 **East Ballina Cemetery - Concept Master Plan.DOC**

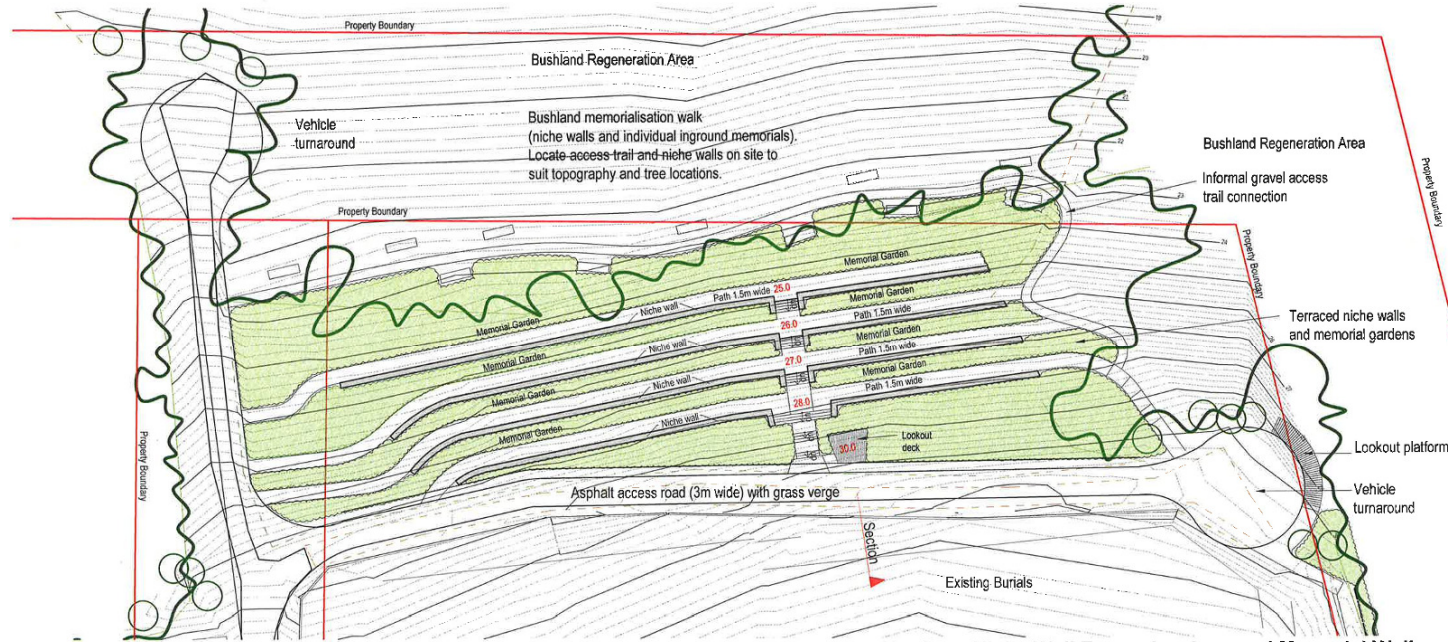

Northern Niche Wall Expansion Area and Memorial Walk

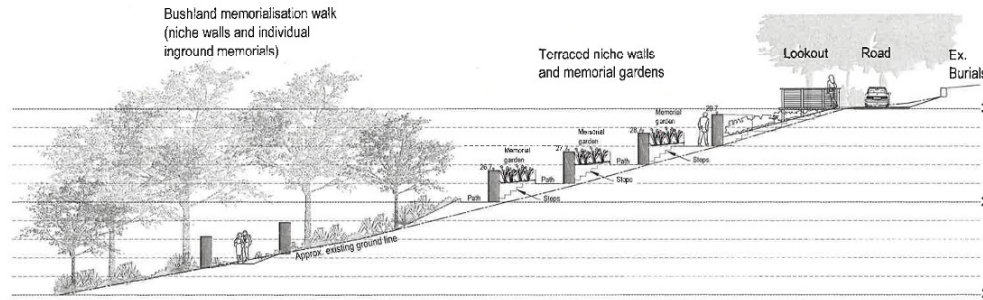

Typical Section Through Northern Niche Wall Expansion Area and Memorial Walk

Project Title
East Ballina Cemetery
Concept Master Plan Details

design team ink
 landscape architecture urban design
 PO Box 1473 Ballina NSW 2478
 T 06 6628 8464 | M 0428 259 285
 sheryn@designteamink.com

Designed SDR
 Date 01.03.13
 Sheet 7 of 7
 Scale Plan 1:400



This is a conceptual master plan that provides a strategy for the future works at the East Ballina Cemetery. The strategy and proposals contained herein are subject to change and detailed design. This document is not suitable for construction purposes.

Detail survey was provided by Ballina Shire Council.