

Make your Mark on Porter Park Consultation report

26 September 2013
Draft Report

Prepared by
Tracey Stinson



"Helping people work together"

Table of Contents

1	Introduction.....	3
2	Objectives	3
3	Method.....	3
4	Results	5
4.1	What residents like about Porter Park.....	5
4.2	What residents don't like about Porter Park.....	5
4.3	How residents use Porter Park.....	6
4.4	Ideas for improving Porter Park / Possible changes to increase resident usage	6
4.5	Other comments.....	8
4.6	Written submissions.....	8
5	Recommendations	9
Appendix 1	Letter of invitation.....	11
Appendix 2	Full Results from Community Consultation.....	12

1 Introduction

Sumbiosis Pty Ltd was commissioned by Ballina Council in June 2013 to design and facilitate a community consultation process with the residents immediately adjacent to Porter Park to allow them to contribute their ideas and input to the proposed embellishment of the Park. The decision to improve the Park follows the recent decision to allow the construction of an Aboriginal Childcare and Family Centre within the Park. This decision was unpopular with many residents who believed that the Park was donated on the condition that it remained as a large open space to allow for cricket games which have been played and enjoyed by the residents for many years.

This report outlines the key issues raised by community members who attended two consultation events in the Park on Saturday 7 and Wednesday 11 September 2013, as well as two written submissions.

The results from this first stage of consultation will form the key input to a series of landscape designs options that will be taken back to the community for a final round of consultation before Council considers and decides on the final outcome.

2 Objectives

The objectives for this community consultation were to:

- Design and facilitate a process with the residents immediately adjacent to Porter Park to allow them to contribute their ideas and input on the embellishment of the Park following the decision to construct a new Aboriginal Childcare and Family Centre within the Park.
- Where possible, build relationships and communication between Council, local residents and the Aboriginal Childcare Centre.

3 Method

Approximately 400 invitations were letter box dropped to residents who live in close proximity of Porter Park, being the square block around Boatharbour Road, Kalinga Street, Waterview Court and Riverview Avenue. The flyer provided them with the following opportunities to participate in the consultation process:

- A community event in the Park on Saturday 7 September including a free barbecue and activities for children. During this event structured discussions and questionnaires were used to collect resident's views and ideas on the Park.

- Another smaller consultation event (without the children's activities) was offered as an alternative on Wednesday 11 September in the Park.
- The letter also advised that residents could provide written feedback about possible improvements to Porter Park directly to Council or arrange for the consultants to meet with them separately to hear their views.

The letter forwarded to residents is included as Appendix 1.

During the two community consultation forums in the Park a photo montage of possible improvements including playground equipment, landscaping, seats and covered barbecues was displayed at both consultation forums to give residents some inspiration and ideas for what may be possible in their Park.

Door to door interviews were conducted with some residents on Saturday 7 September.

Several attempts were made to contact the Aboriginal Child Care Centre to canvass their views and opinions about the improvement of Porter Park. Unfortunately at the time of writing this report we had not managed to schedule a meeting to receive their input.

The questioning route used for the interviews and consultation events was as follows:

1. What do you like about Porter Park?
2. What don't you like about Porter Park?
3. What do you use the Park for?
4. How could Porter Park be improved?
5. What would need to change for you to use Porter Park more?

In total, 51 residents participated in the consultation, as follows:

- 30 residents attended and participated in discussions at the community event on Saturday 7 September.
- Seven residents attended the consultation forum on Wednesday 11 September.
- 12 residents completed questionnaires led by the consultant during a door knock of local houses on Saturday 7 September.
- Three written submissions were emailed/mailed to Council

4 Results

As all of the consultation methods utilised the same questioning route, the results have been collated together and summarised below. Please note that responses to questions 4 and 5 have been merged due to the similarity of themes

4.1 What residents like about Porter Park

The Chart below shows what people like about Porter Park in order of frequency:

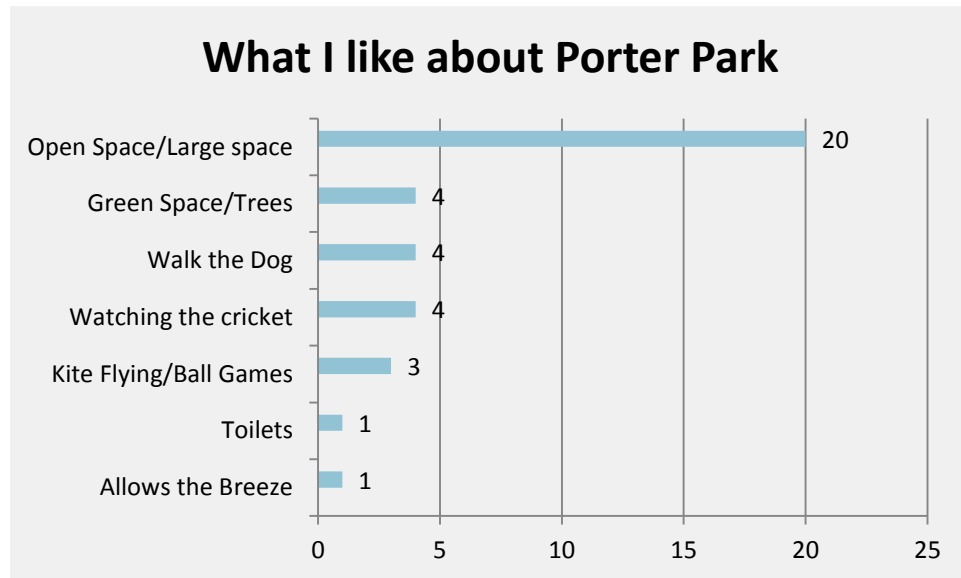

There were a few people who indicated that they were happy with the Park the way it was and stressed the need to retain the large open space without the addition of more buildings that would further reduce the available area.

4.2 What residents don't like about Porter Park

The Chart below shows the things people said they do not like about Porter Park in order of frequency.

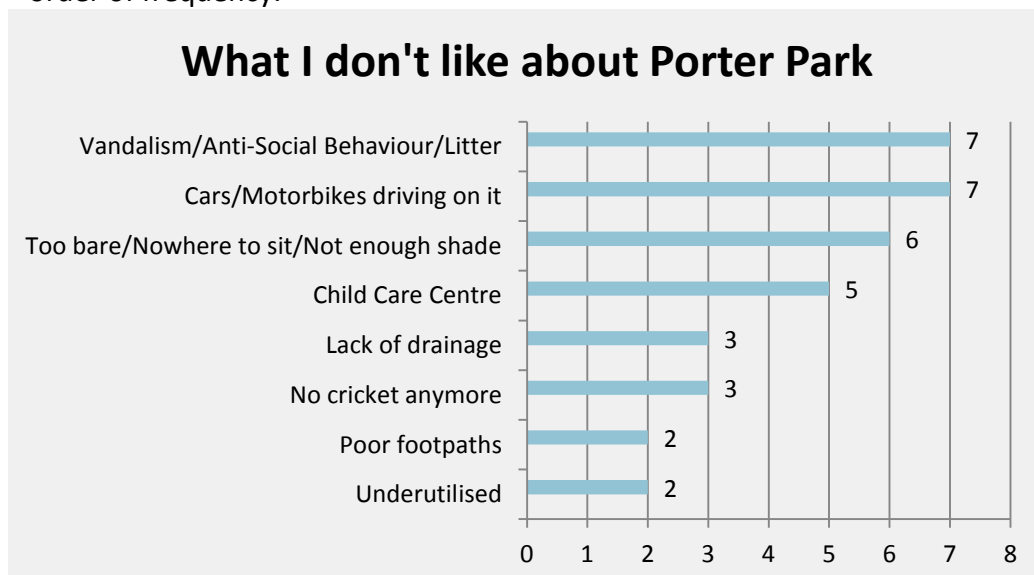

4.3 How residents use Porter Park

The Chart below gives an idea of the sort of uses the community have for Porter Park in its current form.

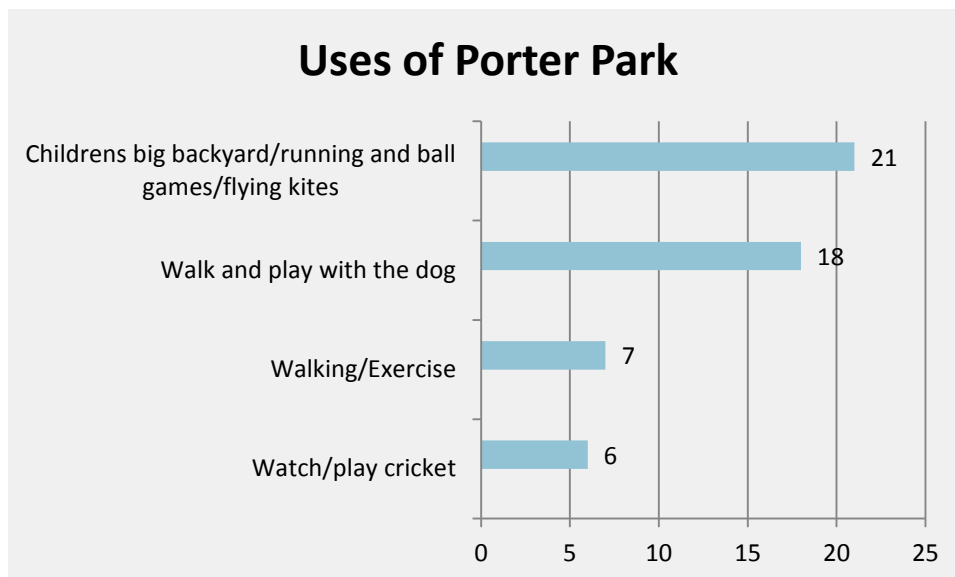

Many parents and grandparents who attended to the consultation indicated that their houses were located on very small blocks of land and that Porter Park was used as their “backyard” where children can run around and play games.

4.4 Ideas for improving Porter Park / Possible changes to increase resident usage

The chart below shows the relative frequencies for the improvements and things that would need to change for people to use Porter Park more often.

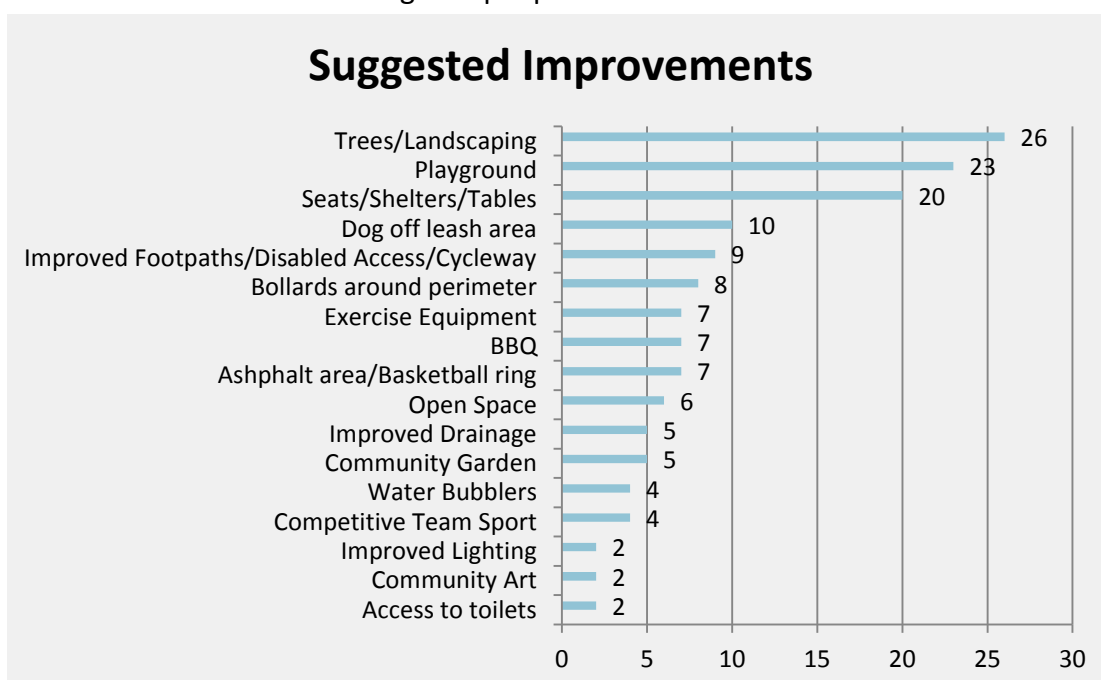

Most residents would like the Park to have some more trees and native plants to provide shade and attract more birds. There were numerous requests to plant a row of trees to screen off the Child Care Centre from view. However many people requested that any plantings be kept around the perimeter of the Park to preserve the large open space currently provided by the Park.

There was a preference for the children's playground to cater for 5-12 year olds and the rope equipment shown in the photo montage was a popular choice. Again, residents requested that the playground be located to the side of the large open area rather than taking up space in the middle of the Park.

There were many residents who own dogs in the area and a popular suggestion was to install a fenced off leash dog area including water troughs and dog waste disposal bags and bins.

Two residents in wheelchairs and parents with toddlers complained about the state of the pathway along the edge of the Park. It was too windy and covered with grass to allow easy access for wheelchairs and bikes or scooters for small children. There were requests made for the footpath to be reconstructed in a straight line and for any new infrastructure to have disabled access.

Given the many complaints about vehicles gaining access to the Park and tearing up the surface, people suggested bollards be erected around the outside of the Park to prevent vehicular access.

Some residents thought that some robust, vandal-proof gym equipment would be well utilised if placed around the perimeter of the park with a path between each station.

Some residents indicated they would like to see some covered barbecues installed in the Park. There were a couple of people who said they did not think these would be used and may be vandalised and encourage more drinking and anti-social behaviour.

Given the loss of the cricket matches residents were keen to see some sport played at the Park again. Some suggested an asphalt area off to one side with a basketball ring to enable half-court basketball and netball to be played.

4.5 Other comments

It's important to note that many residents used the consultation as an opportunity to raise concerns about the perceived loss of amenity resulting from the construction of the Aboriginal Child Care Centre in the Park. Many residents expressed anger that the Centre proceeded despite their objections. The majority of these residents spoke about how they used to watch cricket being played in the Park, but have now lost access to this important recreational and social activity. Some residents also had concerns that the Centre would lead to an increase in undesirable social issues in and around the Park.

Several residents spoke about the 'divide' that has been created in the local area as a result of the Centre. One resident said that she needed to be very quiet in naming her lack of objections to the Centre as this stance isn't congruent with the feelings of the more vocal residents who strongly opposed it. The same resident spoke about a series of informal 'street meetings' that occurred during and after construction where residents gathered to name their opposition.

There is likely to be ongoing underlying conflict within the community as a result of the Aboriginal Child Care Centre. Council could assist to facilitate a passive conflict resolution process through opportunities like a community art projects or a series of ongoing events that bring people from the Aboriginal Child Care Centre together with local residents to improve mutual understanding and therefore to reduce the conflict in the medium term. This has been included in the recommendations section of this report.

There were a significant number of people who raised concerns about vandalism and so stressed the importance of durability for any new park infrastructure. Some people even recommended against using wood for fear that this may be burned.

For a full overview of responses from the community events are shown in Appendix 2.

4.6 Written submissions

As noted above, three written submissions were received by email/mail and these are shown in Appendix 2.

One of these submissions outlines the dissatisfaction with the outcome of the consultation process for the Aboriginal Child Care Centre. Mr Williams explains that the Park was donated on the basis that the area would be used as a cricket ground and that he would like this restored in some capacity.

Another submission provides a detailed list of suggestions and a mud map of the suggested design. Many of these suggestions are consistent with resident's views heard during the community consultation events in particular, retaining a large amount of open space, accommodating multiple uses and providing a children's playground.

The third submission from the Ballina and District Citizens and Ratepayers Association highlights the need to keep the Park as open space with only minimal plantings and bollards around the outside. The Association does not favour installation of picnic tables or a playground due to concerns about vandalism.

However, there were a significant proportion of stakeholders who attended the consultation forums who would like to see the inclusion of covered picnic areas, seating and a children's playground all constructed out of vandal-resistant materials. With the slightly higher proportion of babies and pre-schoolers in West Ballina compared with the whole shire, and the relatively small block sizes for the homes surrounding Porter Park it would be important to provide some stimulation and activities for your children at the Park.

5 Recommendations

1. Prepare no more than two options for the redesign of the Park which can then be taken back out to the community for a final round of consultation before recommendations are made back to Council.

Include in the design options:

- Ensure that improvements to Porter Park allow for multiple uses to accommodate children's play, relaxation, walking (including dog walking) and informal recreation.
- Maintain the majority of the Park as open space. The provision of any additional amenities and/or landscaping should be focused on the perimeter of the Park to allow users to continue accessing it for ball games and to maintain the feel of the Park as a 'big backyard'. If landscaping is to be incorporated, ensure that it doesn't block sight lines in to the Park to maintain passive surveillance.
- Plant more trees and native plantings around the outside of the Park to increase the amount of shade and attract birdlife. Consider planting a line of trees along the side of the Childcare Centre to screen it from the view of the Park.
- Install a playground area for children, preferably under the cover of trees on the Daydream Road perimeter of the Park. The equipment will need to be robust and vandal-resistant.
- Include a fenced off-leash dog area with water troughs and dog waste disposal bags and bins
- In acknowledging the disappointment of some locals in losing regular cricket matches at the Park, it's recommended that Council consider an exploration of the following:
 - Installing a mesh cricket net around the northern end of the existing cricket pitch to enable safe cricket practice.

- Exploring half-sized fields for other junior sport e.g. soccer or football. Note: Many of the residents who expressed anger at losing regular cricket matches named a disappointment at losing organised sport in the Park. i.e. It would be feasible to offer alternative sporting facilities.
 - Include an area of asphalt with a basketball ring and area for hopscotch
 - Improve the direct access to the park via footpaths/cycleways suitable for use by wheelchairs and young children on bikes and scooters.
 - Include robust vandal-resistant gym equipment around the outside of the Park with a footpath between each station.
 - Include a variety of seating and covered areas around the edge of the Park.
2. Explore options (using a community development framework) to deal with the residual anger that exists in the local area due to the construction of the Aboriginal Child Care Centre in the Park. One option would be to create an opportunity for residents to come together with families that use the Centre to create a functional community artwork such as a large scale game board for children to play on (as part of the proposed playground). This could be designed and created by the community over two or three low cost events in the Park. Further, it's recommended that the Centre hold one or two 'open days' (possibly as part of the proposed art events) to build relationships and dispel myths about 'what happens within the walls of the Centre'.

Appendix 1 Letter of invitation

enquiries refer
John Truman
in reply please quote
Leases – Porter Park

19 August 2013



Dear Resident

Re: Porter Park

Ballina Shire Council has set aside funds to improve the usability and amenity of Porter Park and we are interested in your views and suggestions about this.

We invite you to participate in a design workshop as part of a community event at Porter Park on Saturday 7 September 2013, from 2.00pm till 4.00pm. There will be a free BBQ and children's activities provided. All children under 10 years of age will need to be accompanied by an adult. The purpose of the design workshop is to seek ideas from the community regarding how to best utilise these funds to improve the park.

If you are unable to attend this event there will be another workshop held on Wednesday 11 September from 2.00pm till 4.00pm in the Park. If you are not able to attend either of the above workshops, Council representatives will be available to meet with you face to face or by telephone at a convenient time.

Please phone Diana McNabb on 66861497 to register your participation in either of the design workshops or to arrange a meeting to provide your input. Alternatively, you can email your comments and suggestions to ballina@nsw.gov.au.

Once the views and suggestions have been collated, concept designs will be presented at community forums and published on Council's website for a final stage of comments before being presented to Council for approval.

We welcome your input to this process and look forward to providing embellishments to Porter Park based on community support.

Yours faithfully

John Truman
Group Manager
Civil Services

40 Cherry Street, PO Box 450, BALLINA NSW 2478

t 02 6686 4444 f 02 6686 7035 e council@ballina.nsw.gov.au w www.ballina.nsw.gov.au

Appendix 2 Full Results from Community Consultation

Feedback from Open Forum whiteboard session during Charrette #1 held 7 September 2013

What do you like about Porter Park?

- Open green space
- Place for children to play ball games, fly kites
- Open space for sport, fun, family play, throw a ball to the dogs
- Open Cricket space – junior
- Green space, trees, don't want to lose that
- Green space, trees, memories
- Leave as it
- Green strip in the middle
- Walk the dogs
- Walking (residents)
- Grandchildren (fly kites, ball games)
- No longer watch junior cricket
- Kids backyard
- Don't use that much and as a local resident don't see potential usage for the park. Be good to have some additional public amenities to attract more usage
- Small soccer goals bought over to play
- Liked to watch cricket. Missing it! Flying kites
- Taking kids for a walk and they can run around
- Kick foot/ cricket
- Exercise and entertaining
- Kids playing hockey
- Walking around the park (exercise)
- Kids play soccer/tennis/throw a ball/ ride bikes/run around all the time
- Great empty backyard to play in

What don't you like about Porter Park?

- Very clear about open space
- Open space (green space) to remain because limited backyards – 400m²
- Fly a kite
- Underutilised by the broader residents
- Can be noisy – broken glass
- Park is water logged after rain and needs better drainage
- Too accessible for sill youths in cars and on bikes
- Not being used by the community to its full benefit
- Cars racing around oval – need bollards to stop vehicles
- People drink on the oval – broken glass/condoms/syringes/fighting
- Cars/motorbikes race around oval day and night
- Anti-social at times climbing on roofs, throwing rocks
- Golf balls biting roof breaking tiles

How could Porter Park be improved?

- Bollards around perimeter to stop vehicles/bikes on reserve
- Better footpath around West Ballina to access Porter Park
- Landscaping

- Playground for 5-12 yrs.
- Exercise stations around the perimeter of the park to improve/increase usage
- Doggy bag dispenser and water
- Water fountain x 2 (drinking water)
- Non-noisy play equipment
- Access to toilets
- BBQ (covered) areas like Missingham Bridge
- Street lighting to be improved – brighter bulbs
- No skate park!
- Landscaping & children's actives
- Picnic tables & BBQ
- Playground, basketball court for kids (Be constructive)
- Bus shelter (weather proof) Hayman Street – 12-18 kids use bus service
- Bollards /Fencing stops cars on oval – common – unsafe
- Climbing net – activity space for kids 6-13 yrs.
- BBQ Area/ landscaping
- Get the children off the road – provide a playground to play in
- Place to walk to dogs
- Pathway in park for people with disabilities
- Dog disposal area
- Kids ropes playground
- Trees for birds
- BBQ's and shelter – tables & seats
- Shelter trees – kids bike/cycle track. Currently no pathways for kids on bikes that are off the road.
- Bubblers
- Off-leash dog area
- No BBQs please as people will drink in the park more than they already do
- Grass area for tree-play
- Bike pump track for BMX
- Big concrete/asphalt area for kids to play basketball/netball/tennis/soccer/hockey on especially when the ground is wet

What would need to change for you to use Porter Park more?

- Nothing – great wide open space
- Bottle brush, grevillea (natives) around perimeter to entice birds
- Shade – trees or shelter
- Seating to rest and relax
- Playground – basketball court
- Landscaping
- Community gardens
- Improve drainage
- Smooth footpath
- Exercise stations around perimeter – agree this will also support preservation of open space
- Not accessible for people in wheelchairs
- If there are changes, consider parking and access to the new and improved space
- Needs to be safe for kids – no car or motorbike access/broken glass

Feedback from handwritten feedback sheets

Make your mark on Porter Park

	QUESTION ONE What do you like about the park?	QUESTION TWO What don't you like about the park?	QUESTION THREE What do you use the park for?	QUESTION FOUR How could the park be improved?	QUESTION FIVE What would need to change for you to use the park more?	Notes
Respondent 1	It can fit lots of people	Nowhere to sit	Playing – running games and ball games	Climbing nets Seating/shelters/BBQ	Seating and gathering space for families Playground for 5-12 year olds Improve pathway for bike riding for the kids More trees Deal with the anger over the centre	
Respondent 2		Drainage is not good Cars do donuts at night	Lots of people use it for dog-walking. Put an off-leash area and water tap Kids play on the road more than in the park	Keep it open i.e. alcove areas (vandalism risk) Play equipment – 5-12 years (Climbing and basketball) No rocks in landscaping due to risk of throwing	Make the pathway smooth – it's too rough to peddle on Bollards and/or trees around the edge for kids Water tap	Difficult to engage with aboriginal adults. There's little supervision for kids
Respondent 3				Leave it as it is - no changes		
Respondent 4			Walk through and dog walking. Play with grandkids It's a natural thoroughfare to the water	Playground for kids - swings Seats Shade		There are a lot of kids around here
Respondent 5	Open space		Disappointment that the park wont be used for sport anymore. We used to go on Saturday morning Don't use it - except to walk to water		Get sport happening there again We need a reason to go there	Gwen
Respondent 6	Open space			Not used at all - Aboriginal centre and no shade Sport Playground equipment to get the kids on	Trees - A place to sit. A nature reserve, community garden	
Respondent 7		No room for cricket anymore	Walking and bike riding	Drainage around pathway		

	QUESTION ONE What do you like about the park?	QUESTION TWO What don't you like about the park?	QUESTION THREE What do you use the park for?	QUESTION FOUR How could the park be improved?	QUESTION FIVE What would need to change for you to use the park more?	Notes
Respondent 8	I used to sit - was a cool and relaxing place to sit and watch the kids play cricket	Child care centre. I don't know what goes on there - is it an eviction centre? Vandalism - stolen cars left there	Walk the dogs, throw a ball Soccer Walk down to go fishing	Big trees to be planted (Depends on the growth rate) Screen the child care centre so we can't see it (Hide it) More the toilets - too dangerous tucked in out of sight over there. Put in child's playground and police it so it's not vandalised		Dennis & Helen Atta-Singh - 21 Daydream - 0411 691 170
Respondent 9			I used to watch the cricket there. Kids used to play football and baseball there	Something for the kids to play ball (e.g. hoop)		Col Leeson - 13 Daydream
Respondent 10	Lots of space Good place to play - kites etc Generally feel safe - one big barking dog	It's a bit empty Birds swoop Not many trees Lots of littering	Walk the dogs and cartwheeling Cut through to go to the shops	Playground equipment - swings, slide, snakes & ladders, basketball hoop Dog park	Play equipment	3 young girls
Respondent 11		It's not user-friendly There's no shade	I don't	Keep it neat and well maintained Play equipment for the kids Make it suitable for passive recreation	Trees and landscaping - foliage Picnic areas - tables & chairs I would walk my dog if shade was there It needs something to lure people in	Beverly Trimble - 7 Daydream
Respondent 12	Good for dog walking Proximity	Rubbish and broken glass - rarely cleaned up Kids play on the street - not in this park We can't play cricket here any more	Walk through with dogs	Open space for dogs - dog park (lots of dogs in street)	Better maintenance Soft fall play area	Gai Wishington 22 Daydream
Respondent 13	Open space	Child care centre	Walk the dogs Walk kids, fly kites, kick balls	Leave it wide open space More trees and native shrubs to bring back birds A few shrubs (not fenced) to screen the child care centre	Playground for the kids	
Respondent 14	I like it as a big open space	The cars going on it My friends don't feel safe to use it		Still use it for cricket Landscaping More shade A few shelters and seating A few trees Stop motorbikes getting on it	Please don't put in a playground - they will all fight. Still play junior cricket and do training there	

	QUESTION ONE What do you like about the park?	QUESTION TWO What don't you like about the park?	QUESTION THREE What do you use the park for?	QUESTION FOUR How could the park be improved?	QUESTION FIVE What would need to change for you to use the park more?	Notes
Respondent 15		No footpaths so can't ride	Footy, kite, walk the dog	Bike track for scooters, Fix the drainage - swampy Landscaping and playground Have a footpath to whatever you put in		Sarah Carden - sarahjcarden@hotmail.com
Respondent 16	I love it - open space	Needs a bit more to it. Where the toilets are - dangerous at night	Touch football, Cricket	Circuit round the park - for exercise. Path to connect the stations for core work Lights at the toilets at night (Sensor lighting)	Exercise equipment would get me to use it (Save on gym membership)	
Respondent 17				Indoor heated pool (Hydrotherapy).		
Respondent 18	Open space		Flying kites, walking	Screen out the child care centre. Tree - Tranquil		Don Lambert - 6686 4964 - 14 Riverside Drive
Respondent 19	My house is opposite - brings breeze in Summer - not built on. I used to like watching the cricket in summer. The child care centre has screened off my noise. If Child Care centre brings better education - that would be good	We had no say in the Child Care Centre. Swampy when it rains - too wet! Bindi eyes in the grass. Use bad language around here Vehicles occasionally (2 times a year) drive on it. The street is a thoroughfare.	Walking my dog - dog park playing	Landscaping (Hesitant about playgrounds and shelters - people hang out there and get drunk). Safer for kids and needs more shade If kids would use it - OK, but at night, dangerous. Water stations and bags/bags for dogs Dog friendly - maybe contain it	Possibly gym	Beth Wilson
Respondent 20	Open space Used to play cricket (kids laughing all weekend). Being able to have a walk and off lead area	They put the Child Care Centre in it. The design looks like a correctional facility	Walk the dogs - 3/4 times a week	Dog water troughs Landscaping Community garden Little fence to stop cars coming onto it Trees to screen the child care centre Fenced Off lead area for dogs Dog bags & bins	Ron Fields, Darren Fields, 7 Cunningham, 8 Cunningham	Jill Greenaway 13 Cunningham, Jan Boyd 12 Cunningham, Denise Marsh 10 Cunningham, Lyn and Eddie McGlashin, 11 Cunningham

	QUESTION ONE What do you like about the park?	QUESTION TWO What don't you like about the park?	QUESTION THREE What do you use the park for?	QUESTION FOUR How could the park be improved?	QUESTION FIVE What would need to change for you to use the park more?	Notes
Respondent 21		The child care centre	I don't use it	Maybe a community garden Native trees (Shrubs to bring the birds back) More diversity of trees Attract bird life and make it like a bird sanctuary People can come and visit and sit, have a feed and walk their dog		Walter Vick, 3 Hayman Street
Respondent 22	Open Space	Nothing for children to do (They play on the road) Bindi eyes stop the kids playing there. The racism against me as a white woman - called names and sworn at in my own garden	Play touch Fly remote control planes Kites Used to play baseball Hockey practice Ball sports	Needs more shady trees Something for sport - Soccer goals or something Competition team sports Shelters so we can sit in there and watch the kids play More toilets over the other side - safer		Jenny Taverner - 6 Waterview Court
Respondent 23				Park benches, water bubblers, bollards, trees		
Respondent 24	Can see everything that's going on. Please keep it an open space	People driving their cars on it. Vandalism,	Used to play cricket Kids to run and tire them out	Boulders or edges that look nice so cars can't get in. Covered BBQ with cleaning facilities - we need to walk to the BBQ at another park. Seating and shelter. Community garden possibly. More bins for rubbish. Open the toilets	All needs to be vandal-proof. Not wooden.	
Respondent 25	Open space (It was left here as an open space when it was subdivided). Used for all people			More trees for shade as long as it doesn't clutter it up and as long as they are spaced far apart. Not the shrubbery so the hoons can hide behind it drinking	Could use it for junior sports - half sized fields (i.e. soccer, football, basketball)	Ken Campbell - 127 Riverside Drive 02 6686 9291
Respondent 26	The open space	The winding pathway - grass in it. Can't put wheelchairs over it or ride bikes on it. Please either make it straight or tar it. Broken bottles and cans on the path.	Touch footy, kids running around	We want it as open as you can leave it. Tidy it up. A few seats - no tables - just brings rif raf and vandals. Row of bollards to stop cars in wet weather driving on it. Garden along Hayman St. Native trees to hide the Child Care Centre (Shrubs). No worries if you get rid of the toilets	More young families coming and will need the green space. OK to use temporary goals but not permanent. Limit other uses/sports. Goal posts are OK - Just the hoop (minimalist). Please don't move the toilets to Daydream Road side. Bike racks would be good	Ross Pickering - 10 Daydream

	QUESTION ONE What do you like about the park?	QUESTION TWO What don't you like about the park?	QUESTION THREE What do you use the park for?	QUESTION FOUR How could the park be improved?	QUESTION FIVE What would need to change for you to use the park more?	Notes
Respondent 27	Open space (Please don't put more buildings on it)	Please clean the gutter. Kids bring cans onto the oval	Dog walking	Off leash area with water troughs		Rhonda Figgis 8 Daydream
Respondent 28	Nice to have the open space to look at and to walk my dog	It's so bare - needs more shady trees	Walking my dog daily	Trees, gardens, BBQ, Playgrounds, Off leash area with water troughs, screen off the Child Care Centre		Yvonne Truett 12 Daydream
Respondent 29	The toilets (just keep them locked each night)	Unregistered, roaming dogs	Cricket- my kids used to use it	More trees. Shade area by not in timber. Not community garden - it will be vandalised. Playground - to stop kids playing on the road Must be vandal proof. More bins Off-leash dog area (Separate to park) No timber - will be burnt Community art project to bring Aboriginal and white together	BBQ would be a problem - hygiene would be a problem If wood material, they will burn it	Janelle Moss 02 6681 3019 - PO Box 1299, Ballina
Respondent 30		The lady that left it for cricket - so that's why people are angry	Kick the ball around. Lots of kids use it	Water feature (like house with no steps). Community gardens wont work - get trashed Could be Aboriginal (So they don't trash it) Community art that involves all the kids Target - inexpensive things like hopscotch, soccer goals, dog troughs, bags for poo, off leash area, Shelters or trees to provide shade, exercise equipment	Just don't want Aboriginal Child Care Centre 'owning' the Park - although that could be good - then it won't be vandalised. I don't think people will use BBQs	Tia Brown 18 Daydream Av

Feedback received via email

From: Michael Williams <micadr17@yahoo.com.au>
To: "ballina@nsw.gov.au" <ballina@nsw.gov.au>
Sent: Sunday, 1 September 2013 7:23 PM
Subject: porter park issue

It appears strange that a workshop issue has now arisen after the centre which most of ratepayers/residents were opposed to from the start has been built but not occupied and are now asking for our input

When the plans for the centre were published in the local newspaper it was shown that a first grade cricket ground wasn't needed as there were other grounds available, and that a second grade oval would fit onto the remaining "sporting grounds"

We as residents took it on the chin after much to do from others to get the centre built as the (you can't fight city hall) attitude eventuated and the building went ahead.

Council told us then approximately 2 years ago that as soon as the approval for the site went ahead that the plans for the rest of Porter Park would be disclosed.

I therefore submit that in long anticipation of waiting for the cricket oval to be restored even as a juniors cricket oval that whatever plans you have for the rest of Porter Park should be shelved and give us back a cricket oval that was the original donors plan.

Michael Williams
14 Daydream Av
Ballina 2478

From: Roslyn Mayberry [<mailto:roslynmayberry92@gmail.com>]
Sent: Friday, 30 August 2013 2:56 PM
To: Ballina Shire Council
Subject: Porter Park-Attention Diana McNabb

Dear Diana

I am writing in relation to the planned improvements to Porter Park.

I thank the Council for inviting me to the workshops but unfortunately, I am unavailable on either occasion. I have sent an email to the address provided(ballina@nsw.gov.au) on the letter but it came back undeliverable.

I am keen about the improvements to the park as it is my nearest park.

I have prepared some suggestions and a sketch of my ideas. I have attached these two documents.

I trust that these thoughts may be of assistance and that you feel that the ideas worthy of consideration.

Yours faithfully
Ros Mayberry
PO Box 823
Ballina
0412758124

PORTER PARK

Improvement of the usability and amenity of Porter Park is important as it is well documented that access to open space is important for better general health, reducing stress levels, improving mental health and, in turn, lowering health costs. It is important that the sense of open space is not lost.

Some suggestions for consideration

1. Ensure that the improvements provide for **multiple uses** to accommodate children's play, relaxation, walking and informal recreation and that they are **pleasant and welcoming** to all age groups
2. Ensure that activities can be viewed from adjoining houses and streets and ensure that landscaping does **not block sight lines onto the park** for the safety of park users.
3. Retain **easy access** onto the current turfed/grassed areas.
4. Retain the **large open space** to enable people to kick a football or hit a cricket ball without interfering with other users or neighbouring houses and the Child Centre.
5. Provision of a **fenced, shaded playground area** with a variety of play activities (similar to Fawcett Park)
6. Provision of **mesh cricket net** around the northern end of the existing cricket pitch to enable safe cricket practice.
7. Provision of a **basketball hoop and backboard** with a concrete pad, possibly at the back of the cricket net.
8. Provision of one set of **football goal posts** to enable goal kicking practice.
9. Provision of **low maintenance seating around the perimeter** of the turfed/grassed areas with low level shrubs and easily maintained landscaped garden beds.
10. Provision of either a **low maintenance and sustainable gravel pathway or concrete pathway** around the perimeter of the park for use by children on bikes and scooters, walkers, people pushing prams and wheelchairs, people on wheelie walkers and walking sticks, gophers and joggers – a shared footpath
11. Retain the covered awning on the western side of the park, add **table and benches** and plant low level easily maintained gardens around the awning.
12. Plant three or four shade trees on the eastern boundary alongside Hayman Street
13. Open the **toilet block** during daylight hours, say, 8am until 5.00 pm daily

14. Add **lighting** to the east west footpath to improve safety. Lighting is available which will not impact on adjoining homes.

See attached sketch of suggested ideas.

Ros Mayberry

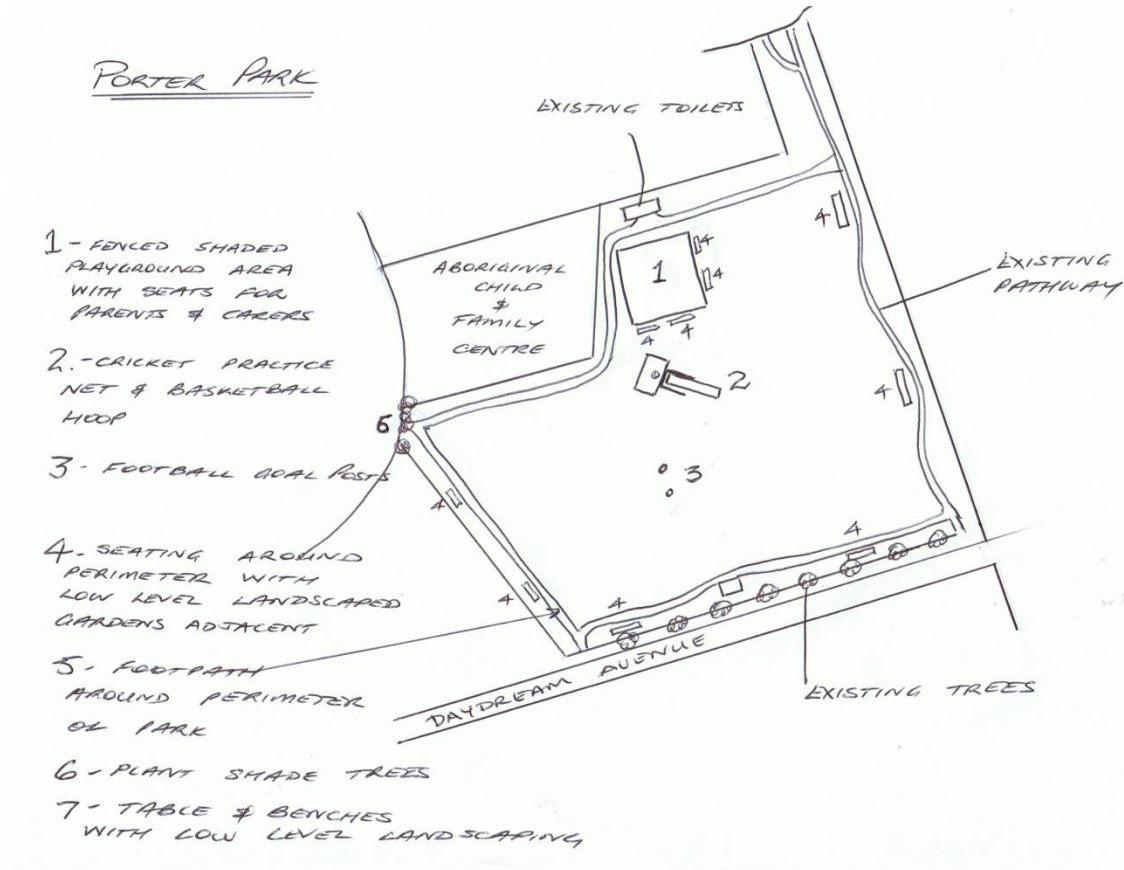

**BALLINA & DISTRICT CITIZENS & RATEPAYERS
ASSOCIATION**

A NON-PROFIT ORGANIZATION.

AVENUE

2478.

10 DAYDREAM

WEST BALLINA

**Mr. James Brideson,
Ballina Shire Council.**

Dear Sir,

following our last monthly meeting, held Saturday 21 September, where the question was put to members regarding their ideas for the beautification/alteration of Porter Park, and subsequently the many phone calls we received on the same subject, it was unanimously agreed that Council should take a “minimalist” approach to any changes to the existing green space.

Many said that they don't want anything done to the Park, whilst the majority was agreeable to the following:-

[1] That Bollards should be placed around the park to keep “hoons” in motor vehicles off the grass.

[2] that native trees be planted in a line along the side of the Family Centre, to disguise its stark appearance.

[3] That a drinking fountain [bubbler] be installed for the use of park patrons wherever convenient to do so.

Because of the incidence of vandalism, and hooliganism in the area, it is felt that the installation of picnic tables would be foolhardy, and an expensive option for Council to maintain.

For the same reasons we do not ask for children's playground equipment to be installed. West Ballina is [as Council would be all too aware] already under size in open greenspace, and the vast majority of locals would like The Park to stay as it is.

Yours Sincerely,

R. Pickering.

PRESIDENT B.D.C.R.A.