

8.3 DA 2012/452 - Section 96 - Men's Shed, Fishery Creek Road, Ballina.DOC

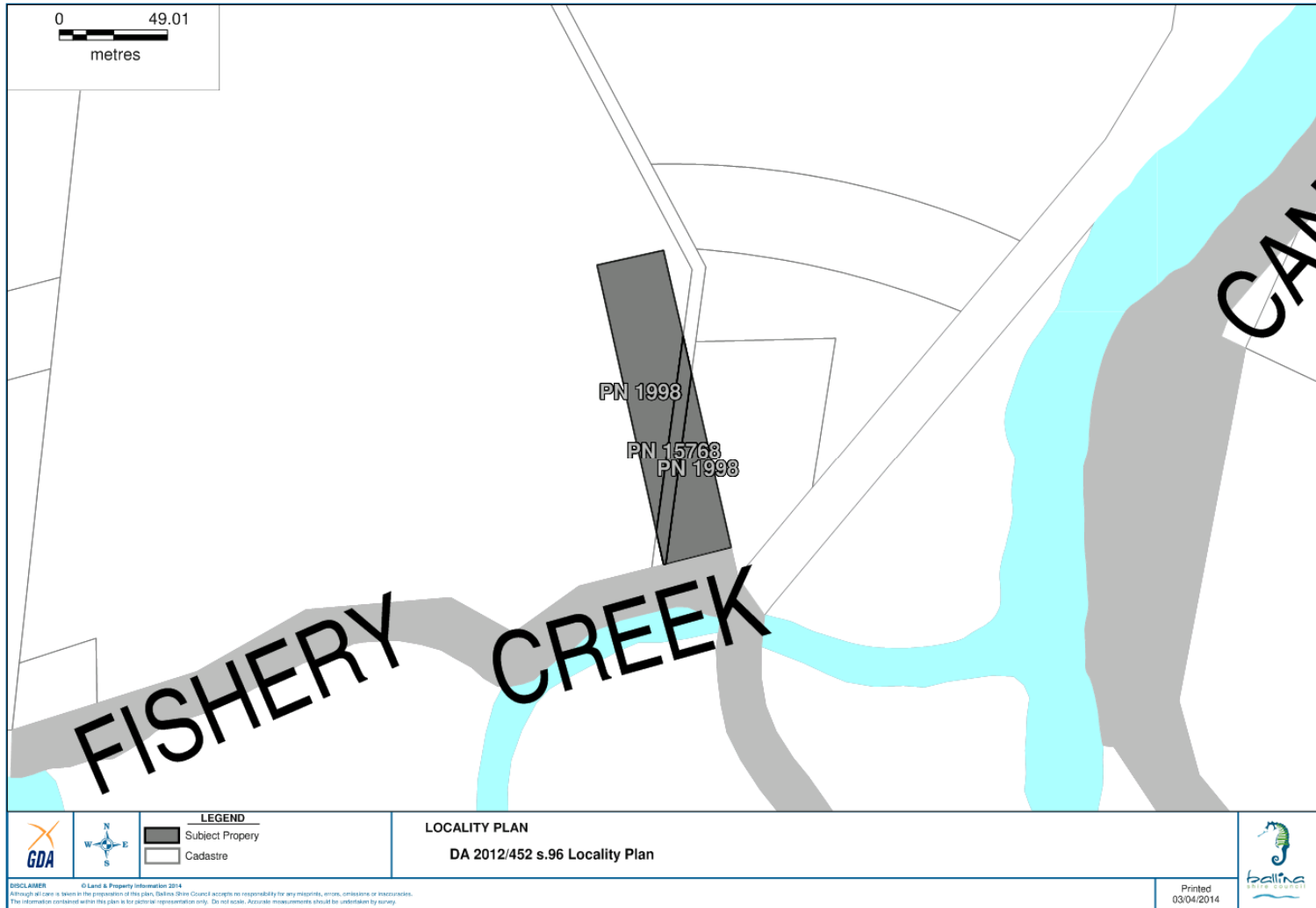

DA2012/452/2

RECORDS
SCANNED
26 FEB 2014

Doc No. 4
Batch No.

EAST ELEVATION
8 bays x 5m = 40% O/A

NORTH ELEVATION

SOUTH ELEVATION

WEST ELEVATION
FILL TO BUILDING - BATTER 1% SLOPE ALL WAYS

PLAN LAYOUT

PLAN & MEZZANINE DETAIL

FOOTING & STEELWORK DETAILS

FLOOD DATA:
 APRL 177 (A0)
 APRL 2.8 (A0)
 APRL 3.35 (A0)
 APRL 2.95 (A0) - 1 in 100 YR

2013/43

A1

RICHARD CRANDON CPENG, MIEAUSL,
CONSULTING ENGINEER
OFFICE: 65 BIRKEN POINT FERRY ROAD
BALLINA NSW 2478
PHONE: 66 81 5595 MOBILE: 94114 22 222
EMAIL: richardcrandon@optusnet.com.au

Drawn	EC	Check	EC	Scale	AT 50000	Sheet	1 OF 1
3	12.2.14	1	12.2.14	Access Ramp reduced Finisher Floor Level FFL 2.00 AND			
1	12.2.14						

BALLINA COMMUNITY MEN'S SHED
44 FISHERY CREEK ROAD
WEST BALLINA

ELEVATIONS
PLAN LAYOUTS
MEZZANINE DETAILS

BALLINA COMMUNITY MENS SHED
BALLINA

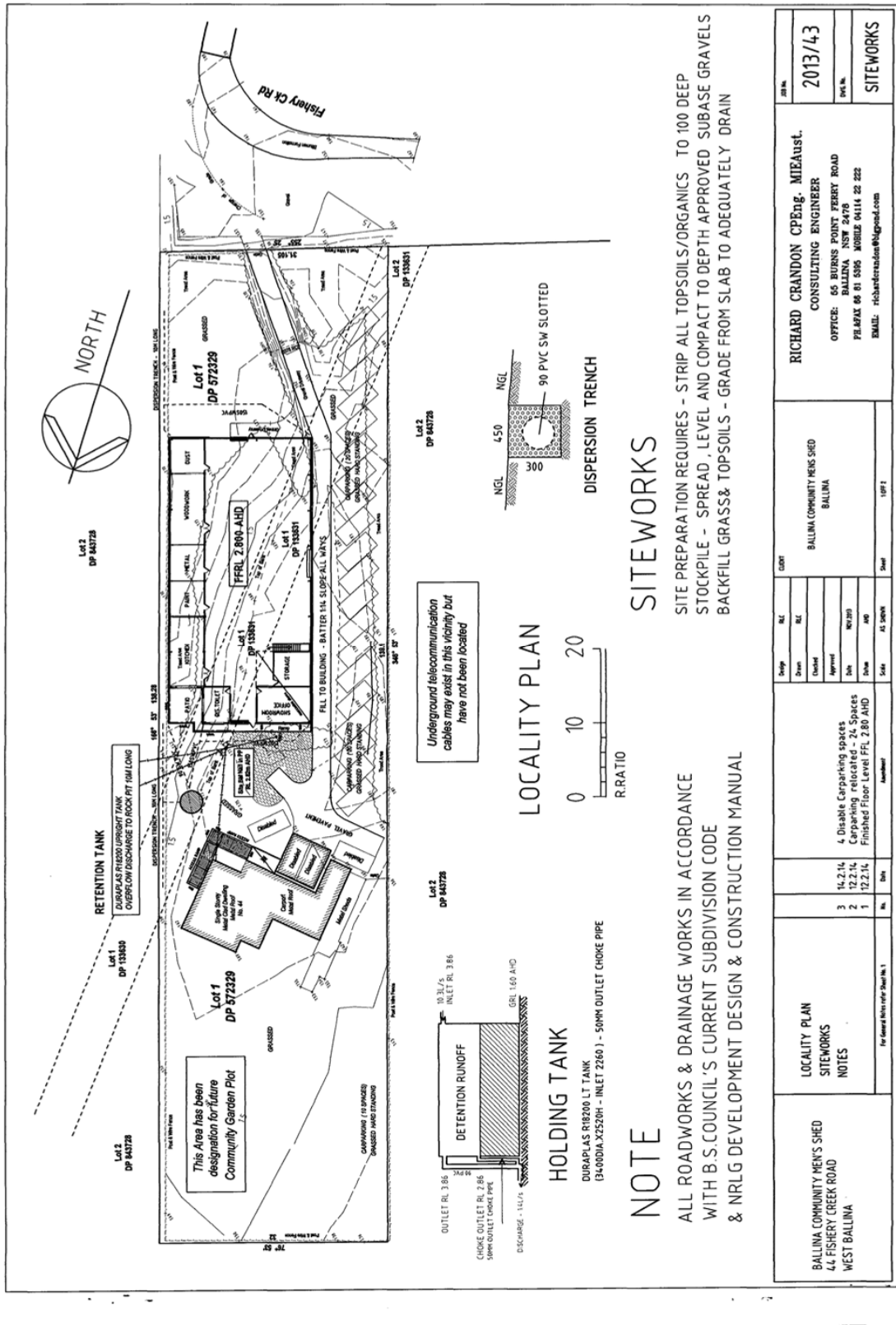

BALLINA COMMUNITY MEN'S SHED 44 FISHERY CREEK ROAD WEST BALLINA	LOCALITY PLAN SITING WORKS NOTES		No. 1 Date 12.2.14 3 14.2.14 2 12.2.14 4 Disable Carparking spaces Carparking relocated - 24 Spaces Finished Floor Level FF, 280 AHD	Member	Sign Date Drawn Checked Approved	Scale AS 1500/N Sheet 1 OF 1	COORD BALLINA COMMUNITY MEN'S SHED BALLINA	RICHARD CRANDON CP Eng. MIE Aust. CONSULTING ENGINEER OFFICE: 65 BURNS POINT FERRY ROAD BALLINA NSW 2478 PHONE: 06 81 5396 MOBILE 04114 22 222 EMAIL: richardcrandon@bigpond.com	2013/43 SITEWORKS