

13.2 **Notice of Motion - Sharpes Beach Master Plan.DOC**

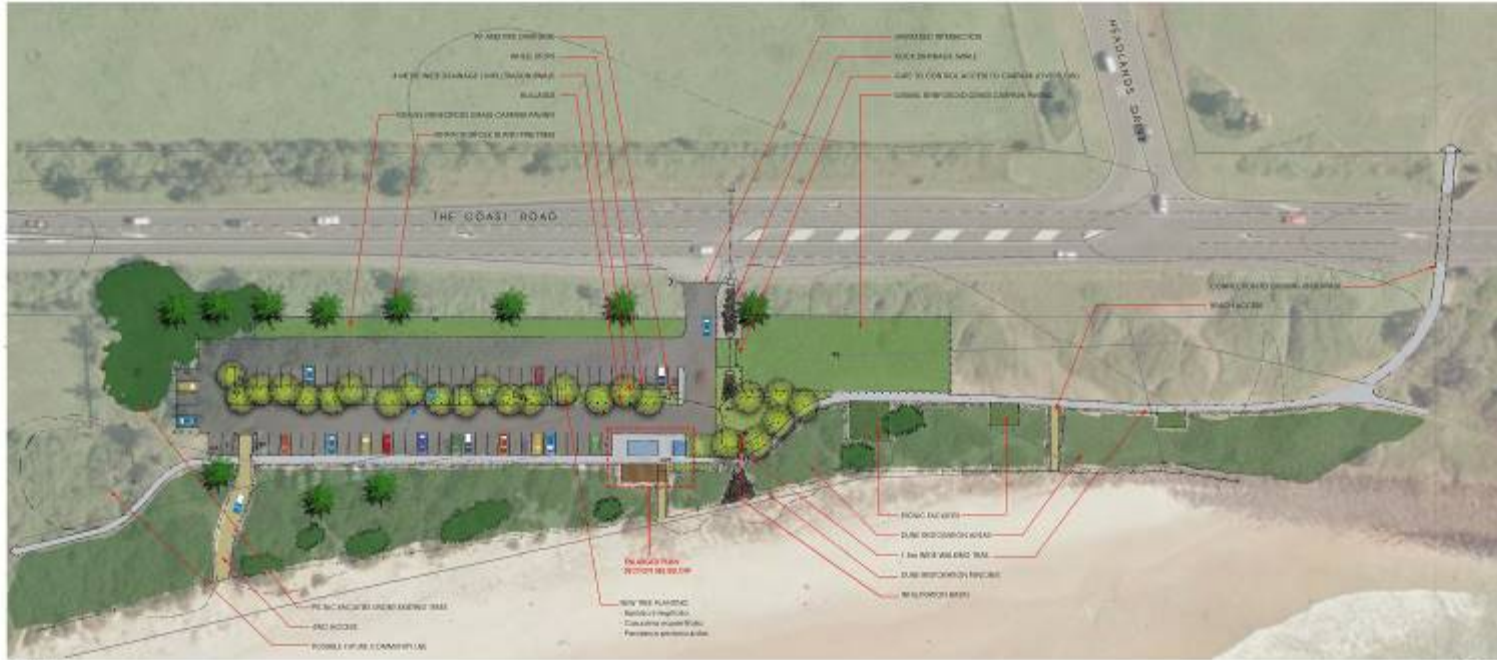



OVERALL PLAN
1:500 @ A1

NOTE: PROPOSED PLANTING AND LANDSCAPING WILL BE SUPPLIED AND INSTALLED BY THE SHARPE'S BEACH DEVELOPER AND COUNCIL. FURNITURE AND PLANTING TO BE SUPPLIED BY THE DEVELOPER AND COUNCIL. THE LANDSCAPING AND PLANTING TO BE SUPPLIED BY THE DEVELOPER AND COUNCIL.

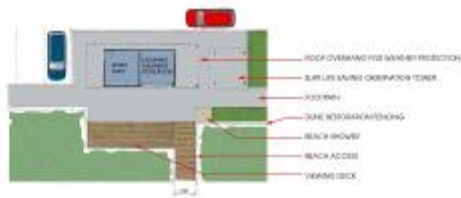

ENLARGED PLAN SECTION
1:200 @ A1



POSSIBLE LONG TERM INTERSECTION CONFIGURATION
1:1000 @ A1



IMAGE OF SIMILAR SURF LIFE SAVING OBSERVATION TOWER

KING + CAMPBELL

KING + CAMPBELL
70 New St | Brisbane QLD 4000 | T: 02 4038 3222 | F: 02 4038 3221

SHARPES BEACH MASTER PLAN
PREPARED FOR BALLINA SHIRE COUNCIL BY KING + CAMPBELL | 1 JULY 2017

