

RIVER STREET

DUPLICATION

PROJECT UPDATE

STAGE 1 WEST BALLINA Burns Point Ferry Road to Barlows Road

To support a growing community and address road congestion, Ballina Shire Council will deliver dual-lane access along River Street between the Pacific Highway, West Ballina and Kerr Street, Ballina.

River Street carries the largest volume of traffic in and out of Ballina and is at capacity during peak hours. Traffic flow recorded for 2019 was 26,100 vehicles per day and traffic modelling predicts traffic flow in 2036 will be 29,500 vehicles per day.

Two-lane arterial roads have the capacity for around 18,000 vehicles per day whereas a four-lane road can cater for 36,000 vehicles per day.

Once complete, the four-lane road from West Ballina into Ballina Island will double the road's capacity and comfortably cater for traffic into the future. This project is estimated to cost \$27.5 million and will be a significant investment to help improve our road network.

During 2019/20, Ballina Shire Council prepared concept plans and conducted public consultation. Council has now adopted a staged program of works to deliver this significant road network investment across four stages.

The detailed design of Stage 1 Burns Point Ferry Road to Barlows Road is now complete, with construction expected to start February 2021.



STAGE ONE: WEST BALLINA – BURNS POINT FERRY ROAD TO BARLOWS ROAD



B Quays Drive Intersection

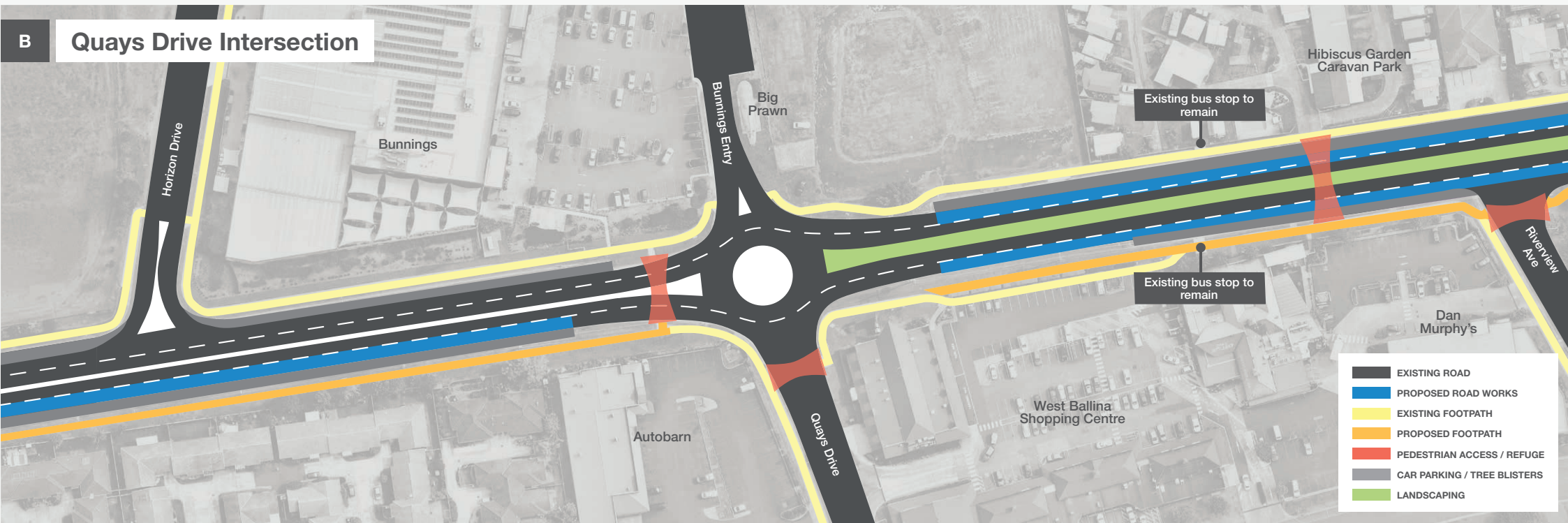

C Barlows Road Intersection

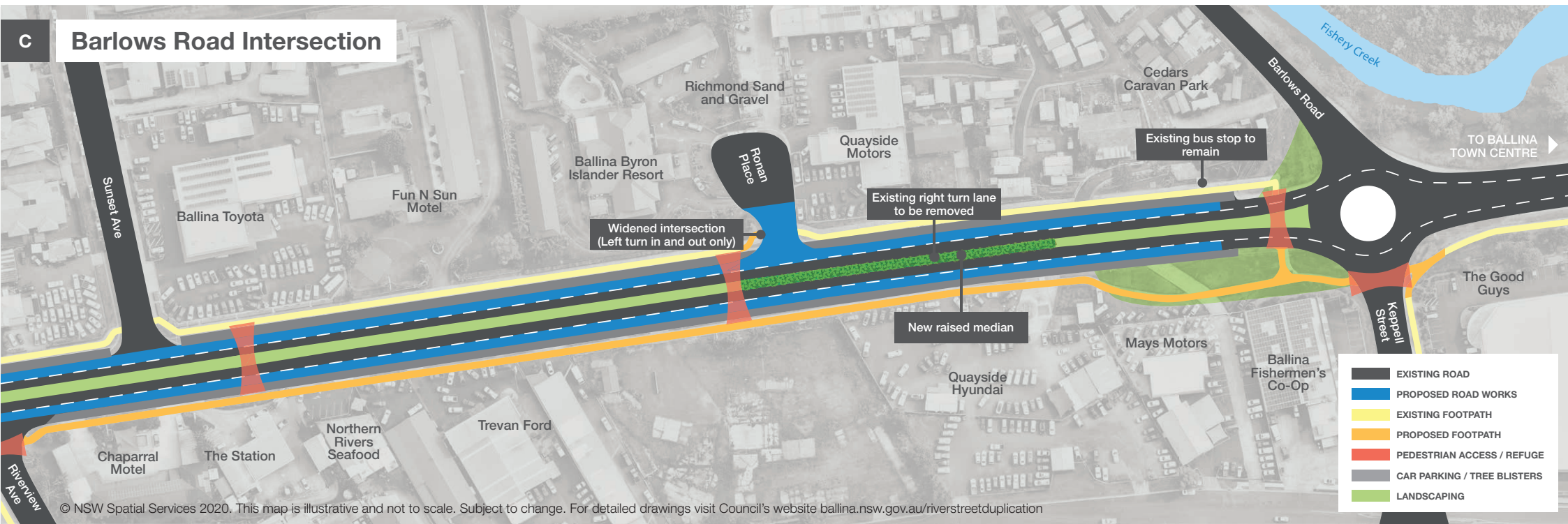

Project stages

The River Street Duplication will be completed in four stages. Stage 1 is illustrated above.

stage 1

WEST BALLINA

Burns Point Ferry Road to Barlows Road

Construction is expected to commence in February 2021

This first stage of the project will see:

- westbound and eastbound lane duplication
- street parking and additional pedestrian footpaths
- central raised median island along the full length of road
- Ronan Place removal of right turn and entrance reconfiguration to allow heavy vehicle left in/left out turns
- upgrade of stormwater and water services.

The existing roundabouts will remain unchanged at:

- River Street/Burns Point Ferry Road/Riverbend Drive
- River Street/Quays Drive/Bunnings
- River Street/Barlows Road/Keppel Street.



stage 2

BALLINA ISLAND

Henry Philp Avenue to Tweed Street

Preconstruction* 2020/21



\$2m

stage 3

FISHERY CREEK BRIDGE

Brampton Avenue to Henry Philp Avenue

Preconstruction* 2021/22



\$14.7m

stage 4

PACIFIC HIGHWAY CONNECTION

Smith Drive to Burns Point Ferry Road

Preconstruction* 2023/24



\$7.1m

* Preconstruction activities include design, environmental & planning assessment/approvals, geotechnical investigation, consultation and any tendering activities.

This timetable is indicative only and subject to change based on preconstruction activities and available funding. Project costs are outlined as Capital Expenditure in the Delivery Program Operational Plan for 2020-2024.

Roadway duplication and alternate routes

The project will see the duplication of both the eastbound and westbound lanes.

One lane vehicle access will be maintained where possible and traffic control will be used throughout the project. Detours may be introduced at certain times. Speed limits will be reduced around construction zones.

Please expect delays and plan to leave earlier than you normally would. We ask that everyone remains patient and courteous, especially when there are traffic delays.

Footpath works and pedestrian access

Additional footpaths are proposed for this project. See maps overleaf for proposed pedestrian refuges and footpaths.

During construction pedestrian access will be maintained, however at times there will be temporary pedestrian detours around construction zones.

Utility upgrades and outages

This project provides a good opportunity to upgrade our stormwater and water services. Much of these works will be underground.

Business operators and residents may experience power and water outages during these works. Council will notify affected businesses and residents in advance before these outages occur.

Dust

Some dust may be present during construction. Council will use water carts to help minimise dust.

Noise

There will be noise present during construction. Construction works will occur during the day to limit disruption to residents and visitors staying with accommodation providers.

Bus shelters

During construction bus stops may be temporarily relocated to the nearest available 'clear zone'.

On completion of the project, the location of the four existing bus shelters will be retained.

Car parking

Street parking will be maintained where possible. Throughout the project there will be areas where parking will be restricted.

Please see maps overleaf for proposed street parking.

Landscaping

Landscaping works will be carried out within the road reserve and street trees planted.

Business access

Council will be contacting individual businesses before the project commences to discuss customer and delivery access. Where possible Council will maintain access or provide alternate access points.



Future Road Network for Ballina Shire

Ballina Shire Council provides and maintains an extensive road network. We are committed to planning ahead to complete road and traffic upgrades to create an integrated network to meet growing demands.

To prepare for this growth and to secure future funding Council is guided by our Roads Contribution Plan.

This plan uses population predictions and traffic modelling to determine our community's future road network needs to 2036.

To view the plan visit **ballina.nsw.gov.au/roadscontribution**

Contact us

Have a question or want to talk to a member of the team about the new upgrade? Contact us Monday to Friday 8.15am to 4.30pm



1300 864 444



council@ballina.nsw.gov.au
PO Box 450, Ballina NSW 2478



40 Cherry Street, Ballina NSW 2478



for project updates visit
ballina.nsw.gov.au/RiverStreetDuplication

Subscribe to receive updates

If you are a local business or resident and would like to receive updates about the River Street Duplication Project please register your email address at **ballina.nsw.gov.au/RiverStreetDuplication**

Think PAC - Plan, Awareness, Caution

There will be delays during the project. Council seeks your patience during these works and we ask motorists to remember PAC to help make your travel as safe and efficient as possible.

Plan

When construction commences there will be delays. Please allow extra travel time and check for roadwork updates by visiting **myroadinfo.com.au**

Awareness

Look for electronic message boards on River Street alerting motorists to work dates and changed traffic conditions.
To receive email updates, subscribe at **ballina.nsw.gov.au/RiverStreetDuplication**

Caution

Traffic control and signage will advise and direct motorists and pedestrians.
Please keep to the speed limits, follow signs and traffic control directions.