

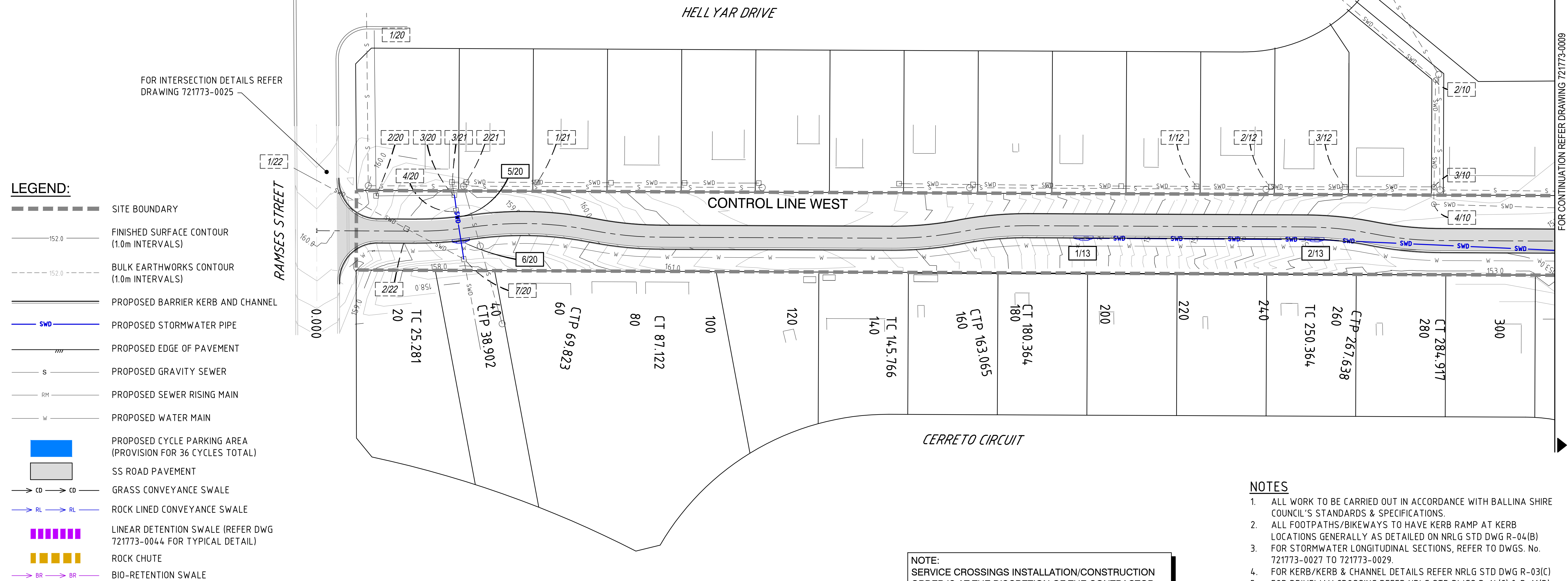

Pt	Chainage	Easting	Northing	Level	Bearing	Rad/Spiral	A.Length	D.Angle
IP1	0	541302.588	6811628.9	160.114	99°45'07.00"			
TC	25.281	541327.504	6811624.618	158.811	99°45'07.00"			
IP2	32.092	541334.229	6811623.462	158.596		-90	13.621	8°40'16.80"
CC	38.902	541341.051	6811623.333	158.559	91°04'50.20"			
IP3	54.362	541356.662	6811623.039	159.121		90	30.92	19°41'04.17"
CC	69.823	541371.262	6811617.503	159.971	110°45'54.37"			
IP4	78.472	541379.375	6811614.427	160.433		-90	17.299	11°00'47.37"
CT	87.122	541387.926	6811612.957	160.818	99°45'07.00"			
TC	145.766	541445.722	6811603.024	161.157	99°45'07.00"			
IP5	154.415	541454.273	6811601.554	160.872		-90	17.299	11°00'47.37"
CC	163.065	541462.947	6811601.745	160.501	88°44'19.63"			
IP6	171.715	541471.622	6811601.936	160.044		90	17.299	11°00'47.37"
CT	180.364	541480.173	6811600.467	159.501	99°45'07.00"			
TC	250.364	541549.161	6811588.61	153.951	99°45'07.00"			
IP7	259.001	541557.7	6811587.142	153.521		90	17.274	10°59'48.94"
CC	267.638	541565.801	6811584.073	153.236	110°44'55.94"			
IP8	276.278	541573.905	6811581.003	153.097		-90	17.279	10°59'59.89"
CT	284.917	541582.446	6811579.536	153.052	99°44'56.05"			



NOTE:
SERVICE CROSSINGS INSTALLATION/CONSTRUCTION
ORDER IS AT THE DISCRETION OF THE CONTRACTOR.
HOWEVER, PRIORITY SHALL BE GIVEN TO SERVICES
PENDING ON GRAVITY (STORMWATER, SEWERAGE).

1. ALL WORK TO BE CARRIED OUT IN ACCORDANCE WITH BALLINA SHIRE COUNCIL'S STANDARDS & SPECIFICATIONS.
2. ALL FOOTPATHS/BIKEWAYS TO HAVE KERB RAMP AT KERB LOCATIONS GENERALLY AS DETAILED ON NRLG STD DWG R-04(B)
3. FOR STORMWATER LONGITUDINAL SECTIONS, REFER TO DWGS. No. 721773-0027 TO 721773-0029.
4. FOR KERB/KERB & CHANNEL DETAILS REFER NRLG STD DWG R-03(C)
5. FOR DRIVEWAY CROSSING REFER NRLG STD DWGS R-14(C) & R-16(B)
6. 1650mm x 90mm HIGH WHEELSTOPS PLACED 630mm FROM EDGE OF PAVEMENT IN ACCORDANCE WITH AUS STD AS/NZS 2890.1:2004.

[illegible]

© Cardno Limited All Rights Reserved.
This document is produced by Cardno Limited solely for the benefit of and use by the client in accordance with the terms of the retainer. Cardno Limited does not and shall not assume any responsibility or liability whatsoever to any third party arising out of any use or reliance by third party on the content of this document.



Drawn L.B.	Date	Client BALLINA SHIRE COUNCIL			
Checked SW	Date	Project WOLLONGBAR SPORTS FIELDS CIVIL INFRASTRUCTURE	Status FOR TENDER ONLY NOT TO BE USED FOR CONSTRUCTION PURPOSES		
Designed SW	Date				
Verified AT	Date	Title ROADWORKS AND STORMWATER DRAINAGE LAYOUT PLAN SHEET 1		Scale 1:500	Size A1
Approved			Drawing Number 721773-0008	Revision	



FOR CONTINUATION REFER DRAWING 721773-0003

1. THE CONTRACTOR SHALL ENSURE TURFED OR SEEDDED REGIONS ARE REGULARLY WATERED TO ENSURE VEGETATION IS MAINTAINED.
2. TREES SHALL NOT BE REMOVED WITHOUT PRIOR WRITTEN APPROVAL OF THE SUPERINTENDENT U.N.O.
3. THE CONTRACTOR SHALL SUPPLY AND INSTALL APPROVED TREE PROTECTION TO TREES WHICH ARE TO REMAIN AND MAY BE DAMAGED DURING THE COURSE OF CONSTRUCTION.

4. CLEARING OF VEGETATION IS TO BE UNDERTAKEN ON A STAGED BASIS ONLY AND ONLY FOLLOWING OPERATIONAL WORKS APPROVAL.
5. ANY FOOTPATH AREAS DISTURBED BY THE DEVELOPMENT ARE TO BE TOP DRESSED AND TURFED FOLLOWING COMPLETION OF CONSTRUCTION ACTIVITY.
6. NO CLEARING IS PERMITTED UNLESS OTHERWISE APPROVED BY COUNCIL AS PART OF AN OPERATIONAL WORKS APPLICATION.
7. VEGETATED AREAS NOT PLANNED FOR CLEARING OR CONSTRUCTION ACTIVITIES SHALL BE KEPT FENCED OR TAPED OFF TO MINIMISE VEHICLE INGRESS.
8. PROVISION IS TO BE MADE FOR AND OPPORTUNITY GIVEN FOR TELSTRA AND THE GAS CORPORATION TO INSTALL THEIR RETICULATION AT THE TIME OF CONSTRUCTION.
9. ANY FILLING CARRIED OUT ON SITE IS TO BE IN ACCORDANCE WITH AS3798-1996 AND SHALL BE CERTIFIED BY A SUITABLY QUALIFIED PERSON AS BEING CARRIED OUT IN ACCORDANCE WITH THE STANDARDS AND SPECIFICATION. THE CERTIFICATION SHALL INDICATE LEVEL OF TESTING RESPONSIBILITY THAT HAS BEEN USED.
10. A COPY OF THE CONDITIONS OF THE DEVELOPMENT APPROVAL IS TO BE KEPT ON SITE AND AVAILABLE FOR INSPECTION WHEN REQUESTED BY AN AUTHORISED OFFICER.
11. FOLLOWING SITE PREPARATION AND CLEARING AS APPROVED, ALL GREENWASTE MATERIAL FOR DISPOSAL SHALL BE STOCKPILED AND REMOVED TO AN APPROVED REFUSE DISPOSAL FACILITY OR WOOD CHIPPED ON SITE. BURNING OF MATERIAL PRIOR TO REMOVAL IS NOT PERMITTED DUE TO INTERFERENCES WITH THE SURROUNDING AREAS.
12. THE INSTALLATION AND OPERATION OF NOISE GENERATING EQUIPMENT AND VEHICLES SHALL BE CARRIED OUT IN A MANNER TO MINIMISE THEIR IMPACTS ON NEIGHBOURING PROPERTIES. NOISE LIMITS TO COMPLY WITH THE DEVELOPMENT APPROVAL.

[illegible]

© Cardno Limited All Rights Reserved.
This document is produced by Cardno Limited solely for the benefit of and use by the client in accordance with the terms of the retainer. Cardno Limited does not and shall not assume any responsibility or liability whatsoever to any third party arising out of any use or reliance by third party on the content of this document.



Drawn L.B.	Date	Client BALLINA SHIRE COUNCIL		
Checked SW	Date	Project WOLLONGBAR SPORTS FIELDS CIVIL INFRASTRUCTURE	Status FOR TENDER ONLY	
Designed SW	Date		NOT TO BE USED FOR CONSTRUCTION PURPOSES	
Verified AT	Date			
Approved		Title EARTHWORKS CUT AND FILL LAYOUT PLAN AND EROSION AND SEDIMENT CONTROL DETAILS SHEET 1	Drawing Number 721773-0002	Scale 1:500
				Size A1
				Revision